

KEY MAP
SHOWING DRAIN

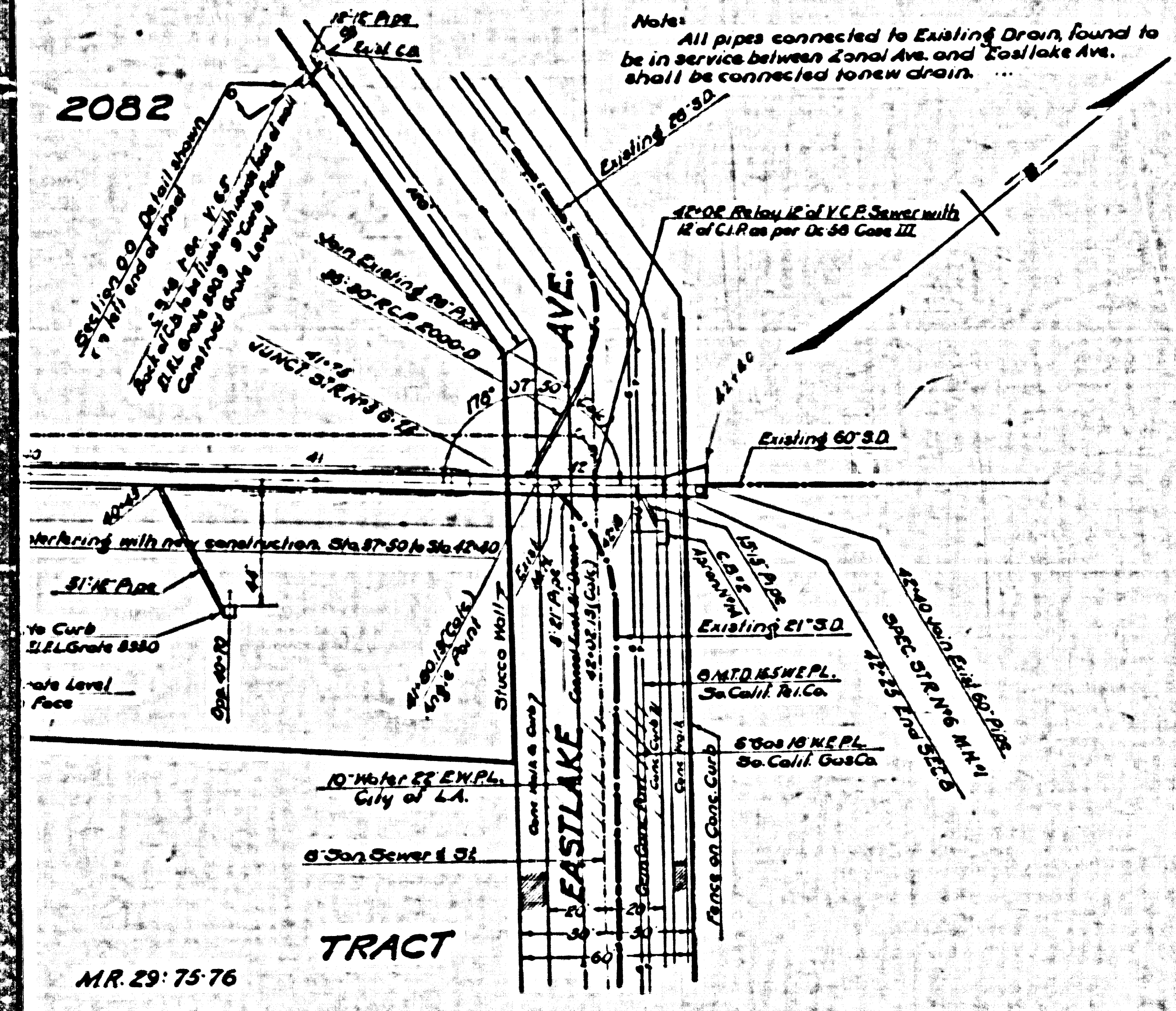

Note: All pipes connected to Existing Drain found to be in service between Zonal Ave. and Eastlake Ave. shall be connected to new drain.

NOTES:

Elevations are in feet above U.S.G.S. or mean Sea Level Datum.

Elevations of all Lateral Inlets refer to the intersection of the invert of the Lateral with the inside face of the main drain or structure.

Stations of all Connector Pipe Inlets refer to the intersection of the center line of the connector pipe with the inside face of the main drain or structure. Bring connector pipes in radially to pipe drains where structures are not designated.

Connector Pipes in Box Sections shall be laid in conjunction with Junction Structure N°4 (Standard Dc 33) unless otherwise directed by the Engineer of Construction.

All Pipe not otherwise specified shall be Standard Strength Cement Concrete Pipe.

For Structures marked SPEC STR. N°-; or SECTION -; see structural details on Special Structure and Box Section Sheet.

All Structures not otherwise specified are Standard Structures. See details on Standard Plans.

Catch Basins shall be built with a curb face of 10' or more which shall include a minimum depression of opening of 4' below gutter grade unless otherwise specified.

Elevations shown of catch basins refer to top of proposed curb at center line of basin if one elevation is given or at ends of basin if two elevations are given.

Sanitary Sewers crossing over or with a clearance of 150 feet or less under Storm Drain, shall be constructed or reconstructed as shown on Standard Dc 55, except as otherwise specified herein.

COUNTY HOSPITAL DRAINAGE SYSTEM

OF THE COUNTY OF LOS ANGELES, CALIFORNIA.

PLAN AND PROFILE OF ZONAL AVE. LATERAL LORD ST. LATERAL COUNTY HOSPITAL TRUNK

SHEET 1 OF 5 SHEETS

SCALE VERT 1"=4' HORIZ 1"=40' JAN 1940.

ALFRED JONES - COUNTY ENGINEER

RECOMMENDED *Edmond* APPROVED *Alfred Jones*

THIS DRAWING AND THE DATA HEREON ARE HEREBY MADE A PART OF THE SPECIFICATIONS

REFERENCE		DESIGNED	DATE
FB	791	EJ Epperson	Sept. 1935
	Revised Plans of Streets No. 22-00	TRACED	W F Brushner
	Pipe at 8-00		Nov. 1935
	Storm Sewer Standards No. 8-00	CHECKED	W M Rice
	Sanitary Sewer Standards No. 8-00		Oct. 1935

CSB-1198-1
A1 OF A7

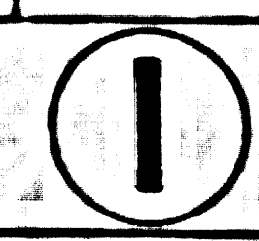

ANCHES EL 344.651 (3.78) pg. 221
 Ramon Ave 3.5' from E. Co. Hosp. Dr. Opp. Bigger St.
 21' from Middle of East C.R.

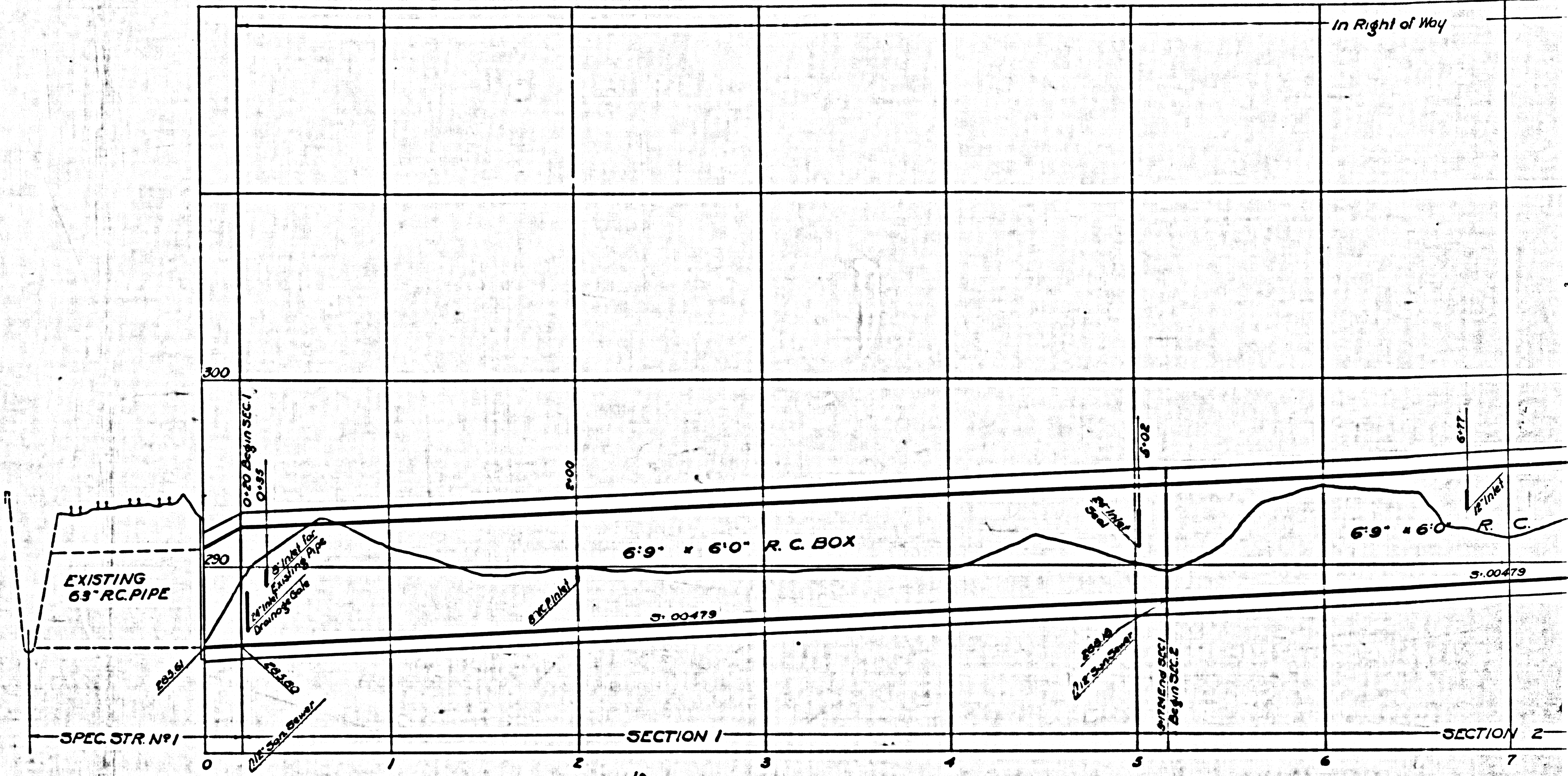
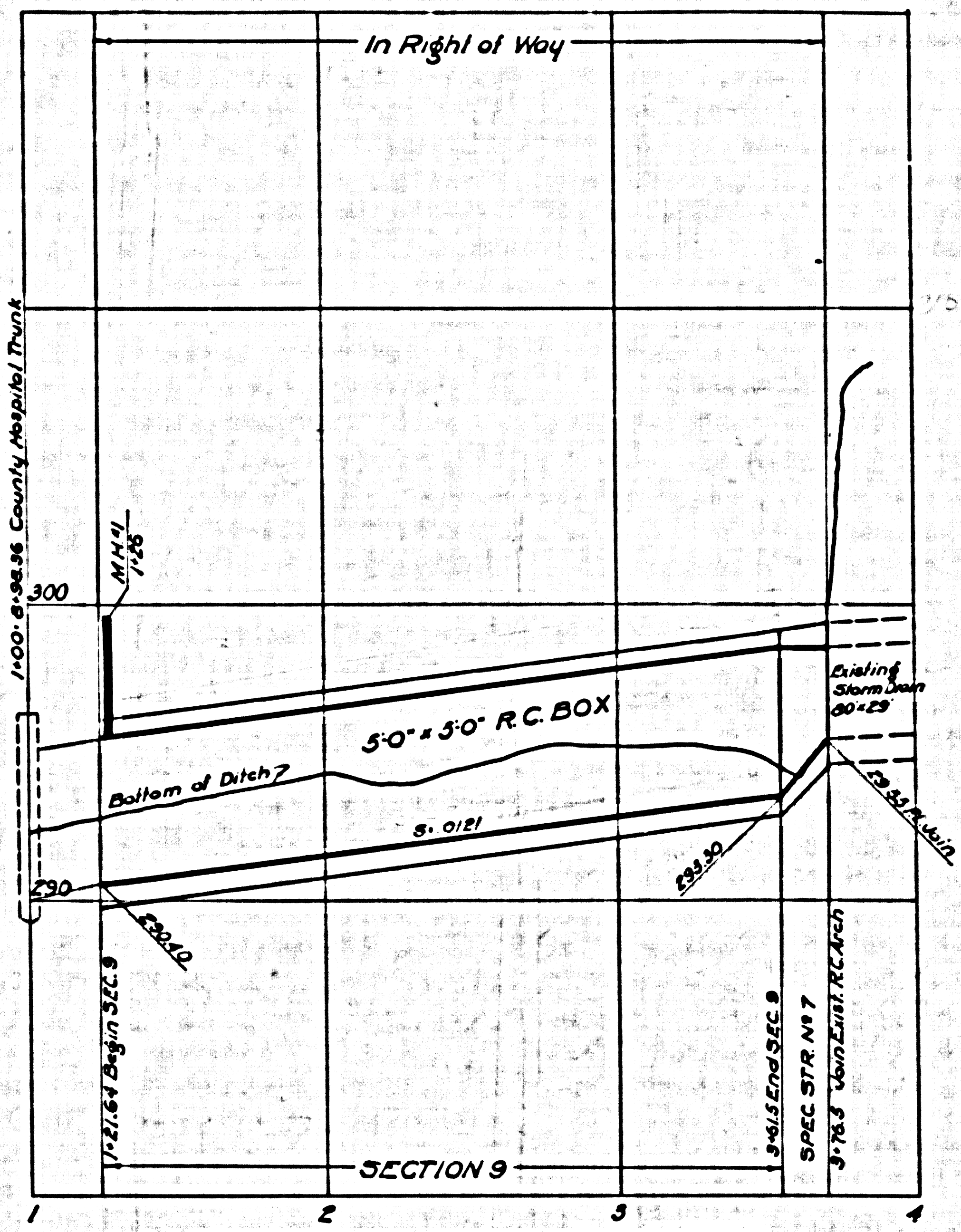
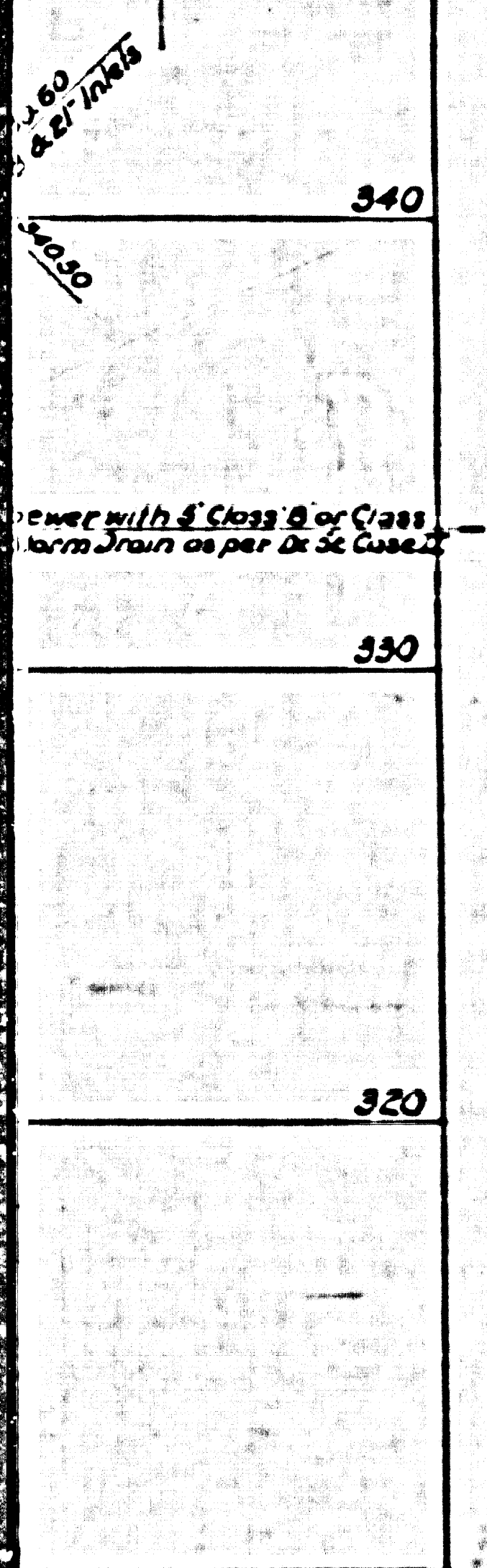

PROFILE OF LORD ST. LATERAL

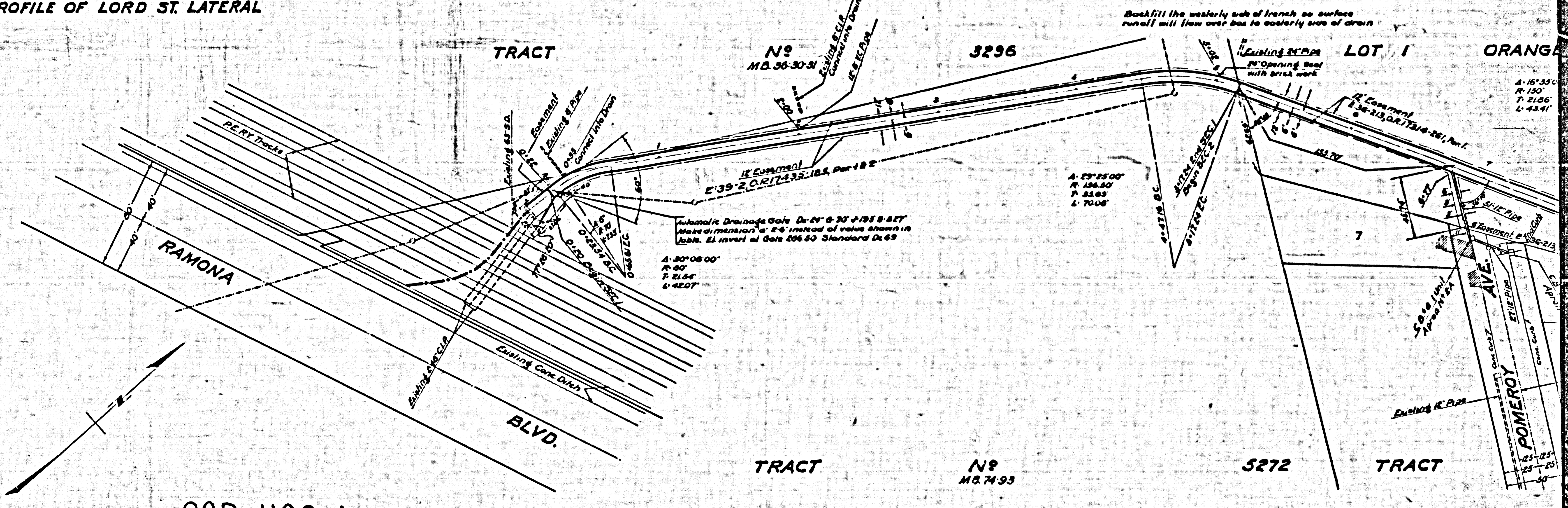
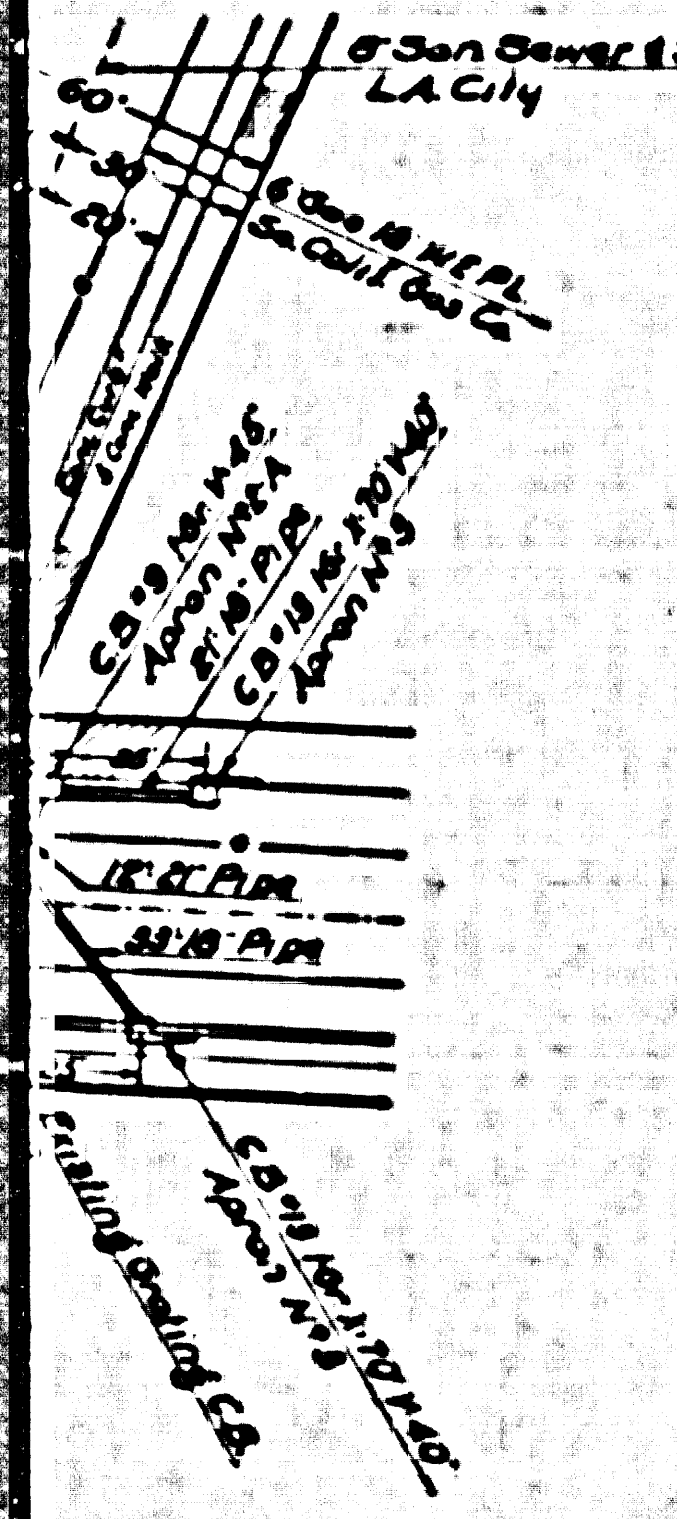

CSB-1198-1
 A5 OF A7

COUNTY

BM CH 4 EL. 814.876 F.B. 791 pg. 8
Zonal Ave. & E. to Co. Shop Store Room
Bl. sph. in E. Co. of E. Walk T3. of S. end

BM CH 5 EL. 816.071 F.B. 791 pg. 8
Zonal Ave. & Henry St. E. Cor.
Bl. sph. in Ch. 18 S.E. of S.E. end C.R.

BM CH 25 EL. 332.481 F.B. 791 pg. 221
Zonal Ave. S. Side of Draft St.
Bl. sph. 12 W. of E. end C.R. of Co. Hosp. Dr.

BM CH 25 EL. 344.851 F.B. 791 pg. 221
Zonal Ave. S. Side of Co. Hosp. Dr. Opp. Biggy St.
Bl. sph. N.W. of E. end C.R.

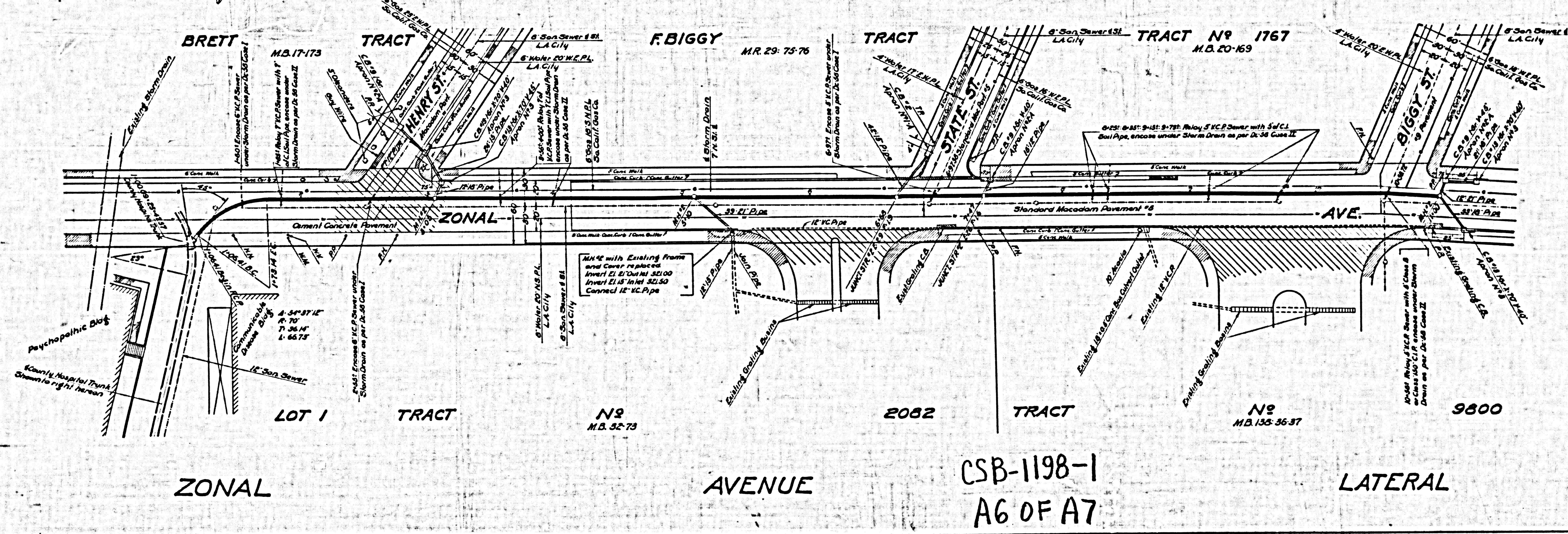
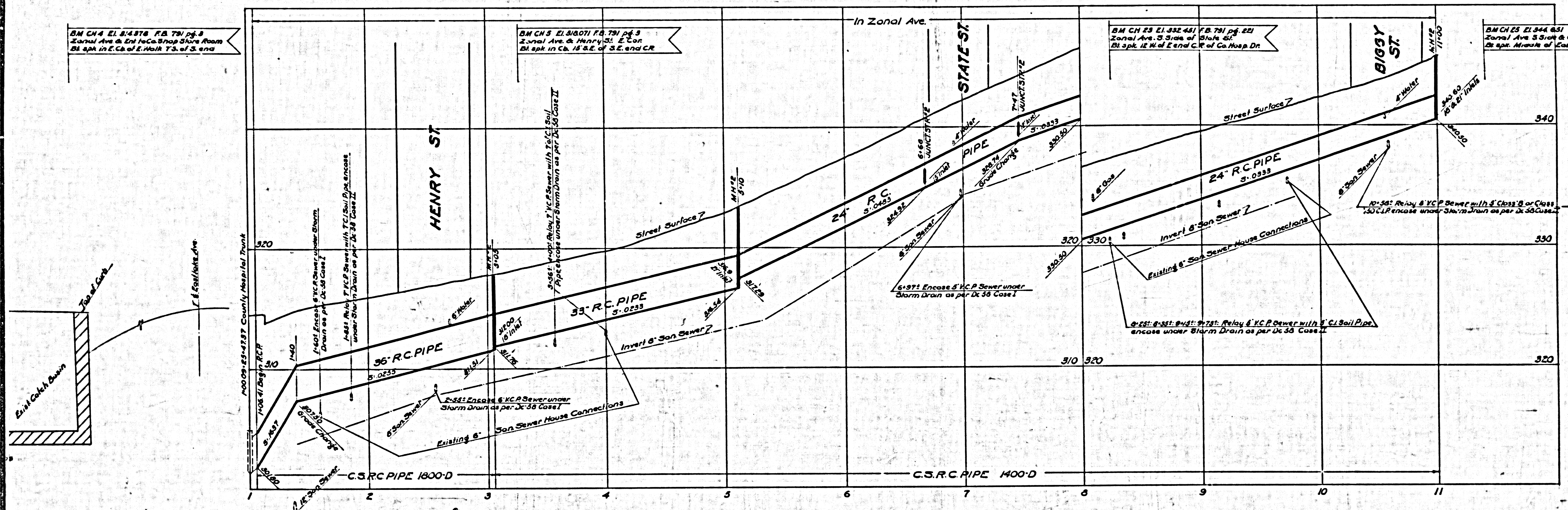

CSB-1198-1
A6 OF A7

BM CH 4 El. 314.876 F.A. 791 pg. 3
 Zonal Ave & Ent to Co. Shop Store Room
 Bl. app in E. Co. of E. Walk T.S. of S. end

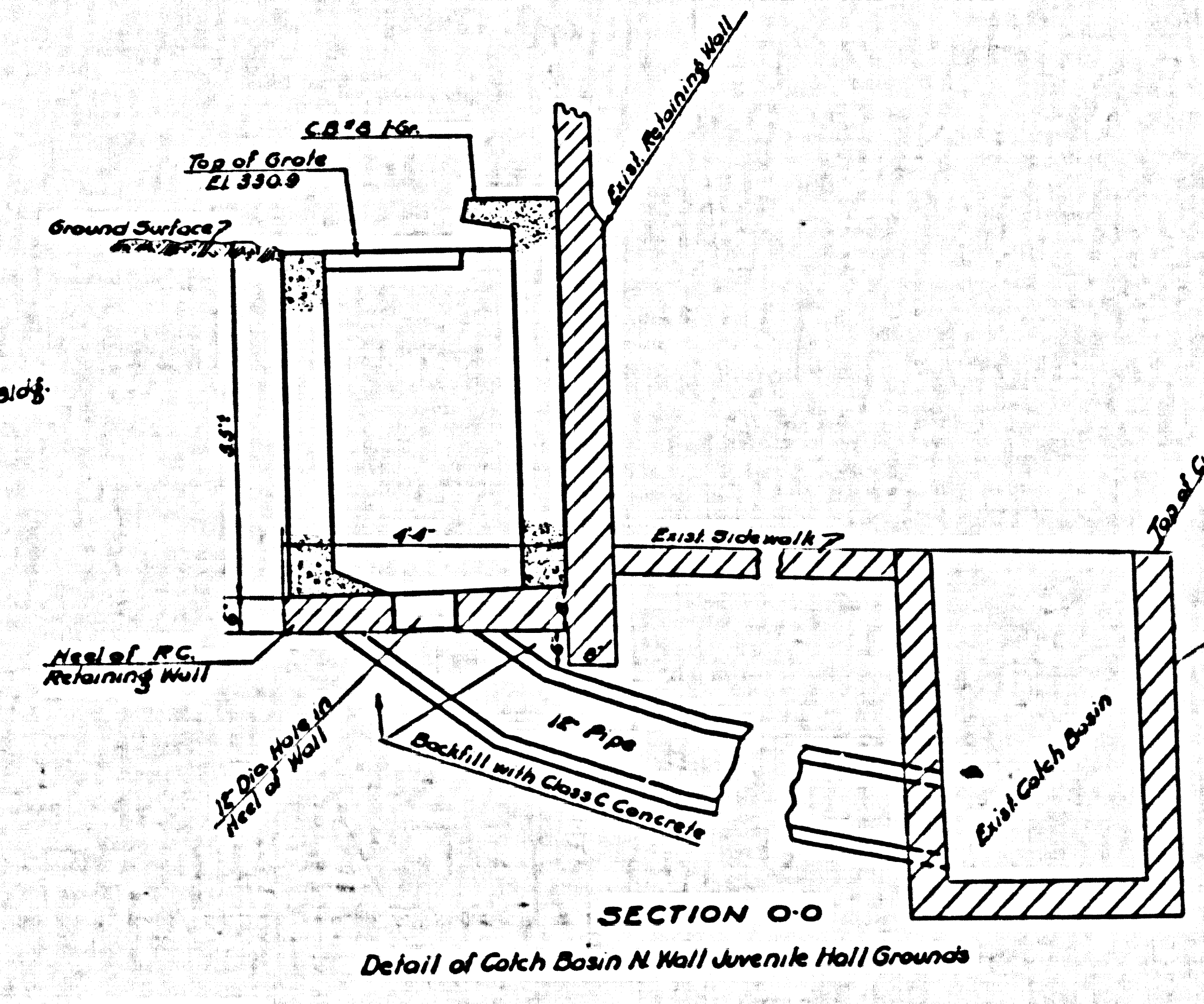
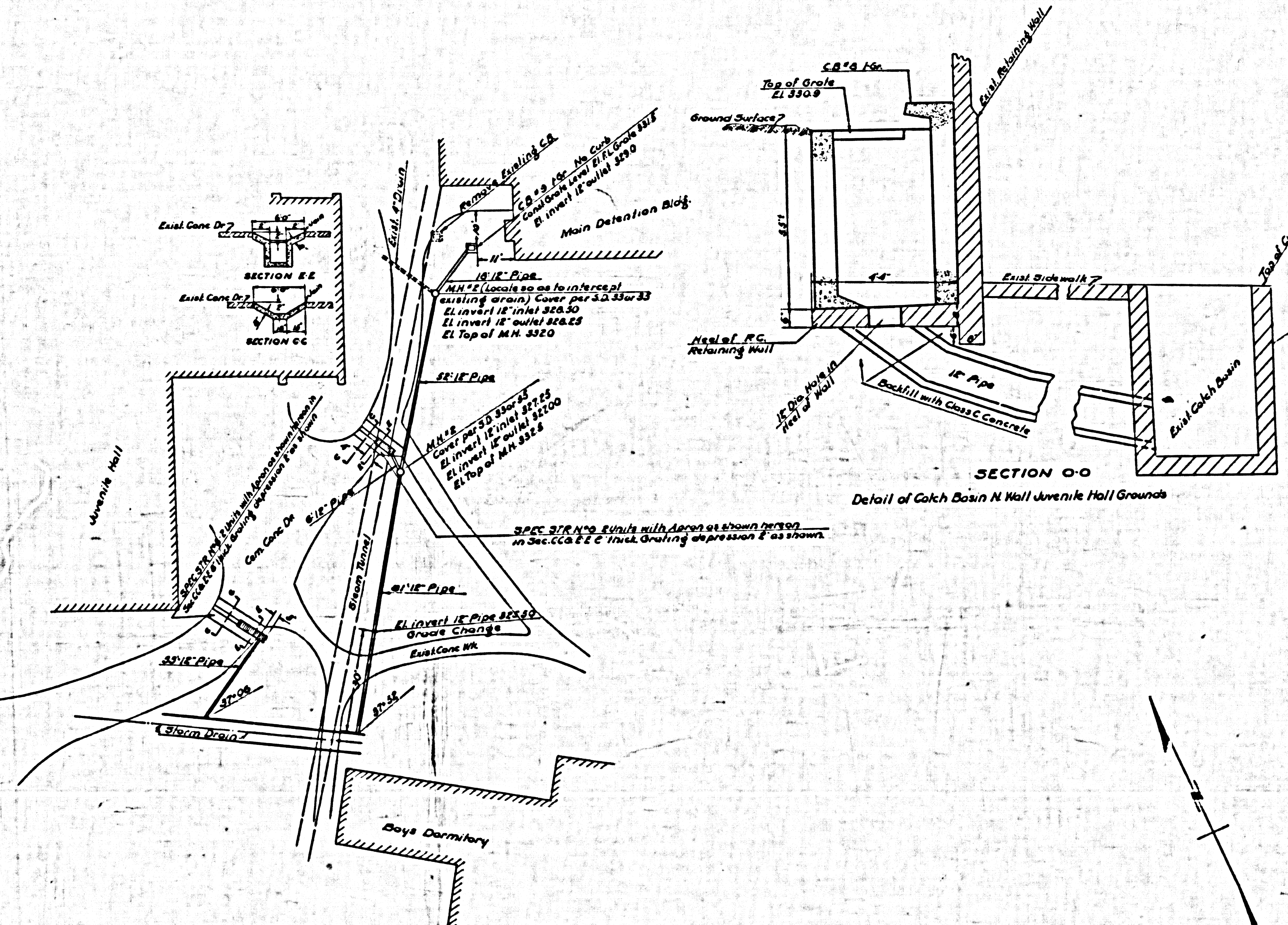

DETAIL OF INLET AT STA. 37-32 & 37-06
 Scale 1"=20'

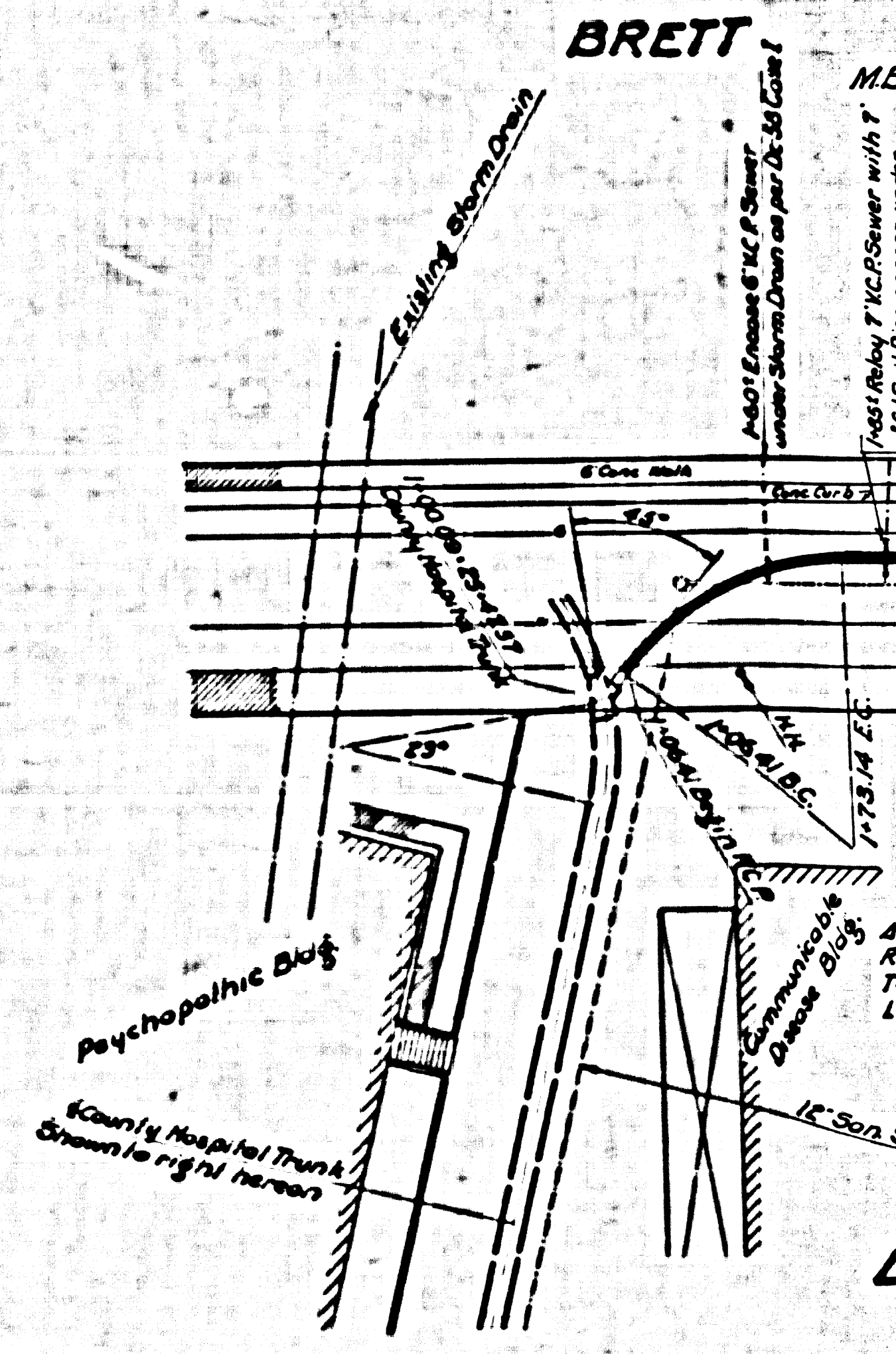

CONTRACT NO. 1198-1

SHEET NO. 1 OF 3 SHEETS
 CONSULT SURVEYORS MAP NO. B-1198

CSB-1198-1
 A7 OF A7

ZONAL

