

S. R. 18 W.

COUNTY OF LOS ANGELES
 MAP OF
MESA PEAK FIRE TRUCK TRAIL
 FROM
 NORTHERLY LINE RANCHO TOPANGA MALIBU SEQUIT
 TO
 CORRAL CANYON ROAD

COUNTY SURVEYORS MAP NO B-1219
 SHEET NO 2 OF 3 SHEETS
 SCALE: 1 INCH = 50 FT.

JOB NUMBER: 8082

ALFRED JONES-COUNTY SURVEYOR
 SURVEYED APR. 1935- SEPT. 1941

SURVEYED ON REQUEST OF THE COUNTY
 FORESTER AND FIRE WARDEN UNDER RULE 21,
 ORD. 929, BY LETTER DATED FEB. 25, 1935
 AND AS AUTHORIZED BY THE BOARD OF
 SUPERVISORS IN THEIR ORDER OF JAN. 13, 1930

BEARINGS ARE BASED ON THE BEARING OF
 SOUTH LINE SEC. 14-T. 15-S. R. 18 W. AS SHOWN
 ON C.S.B.-693-1

F. B. 580-5-220

S. E. BUTLER
 FIELD WORK BY T. J. STEVENSON
 L. S. HAMMOND
 OFFICE WORK BY K. R. HAMPHERSON
 C. W. COX
 CHECKED BY D. M. FINLEY

SEE INDEX MAP ON SHEET NO 3

INDEX 91
 I.M. 127-057

CSB-1219-2
 A1 OF A4

Cont. From C.S.B.-1219-1

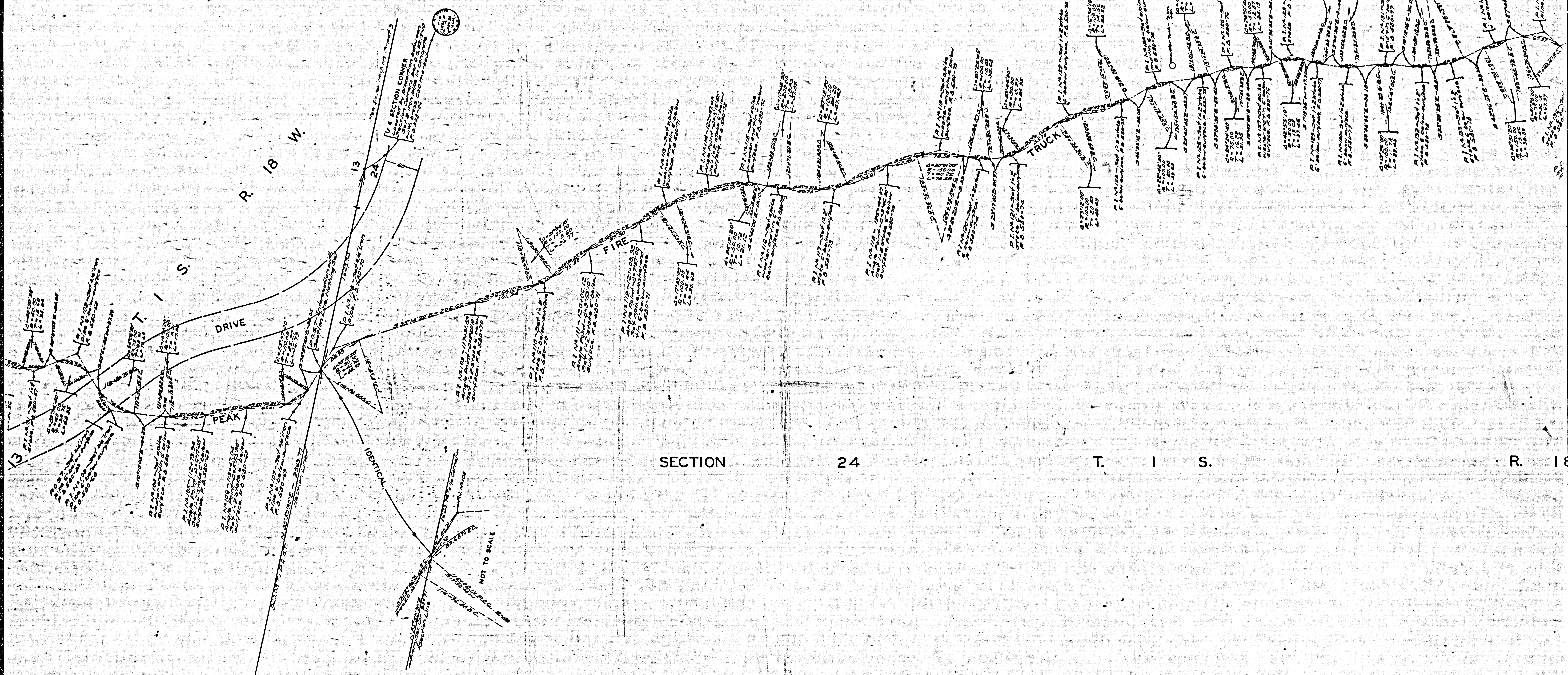

SECTION 24 T. I. S. R. 18

CSB-1219-2
A3 OF A4

SECTION 24

T. 1 S.

R. 18 W.

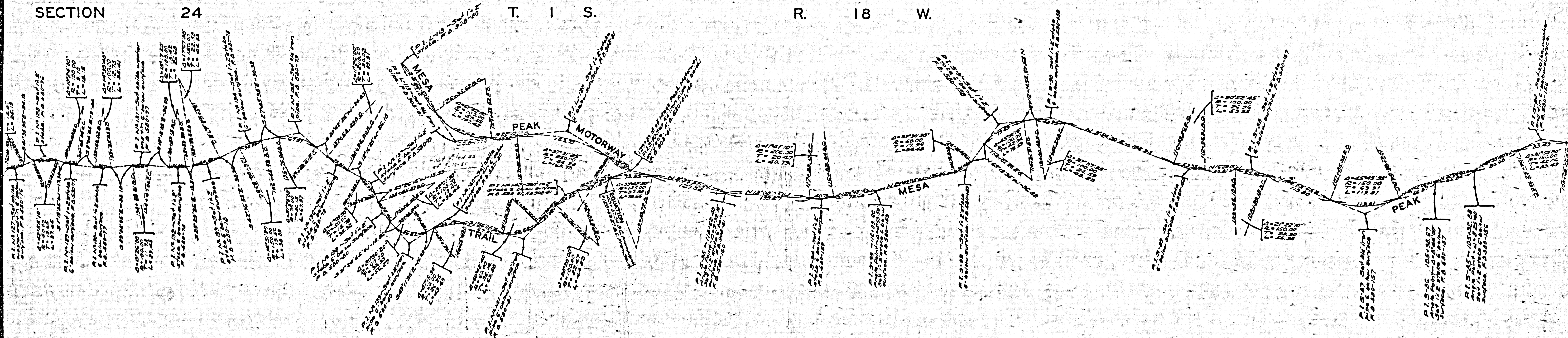

R. 18 W.

SECTION 24

T. 1 S.

R. 18

CSB-1219-2
A2 OF A4