

DING PLAN  
 NED, MAY, 1937

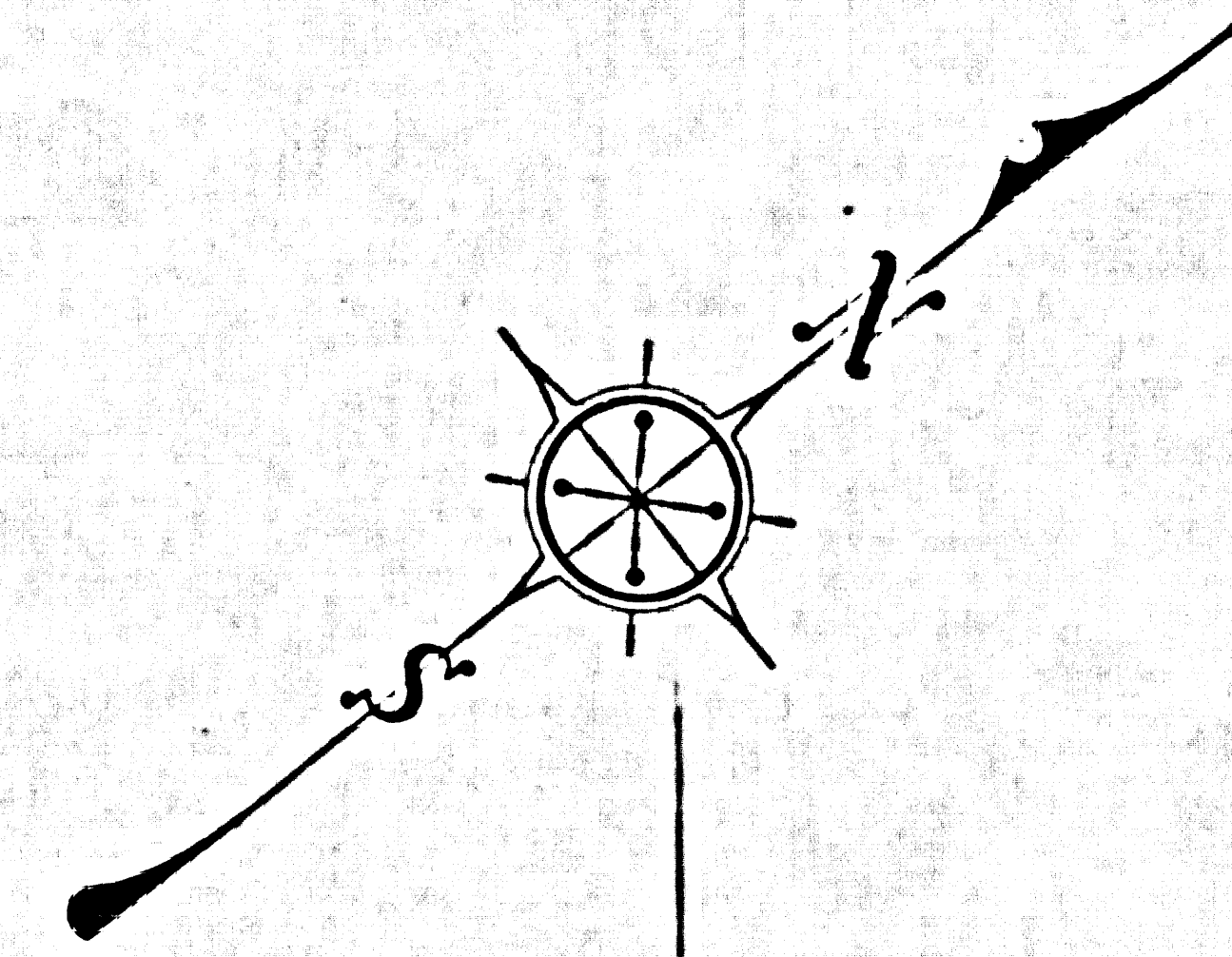
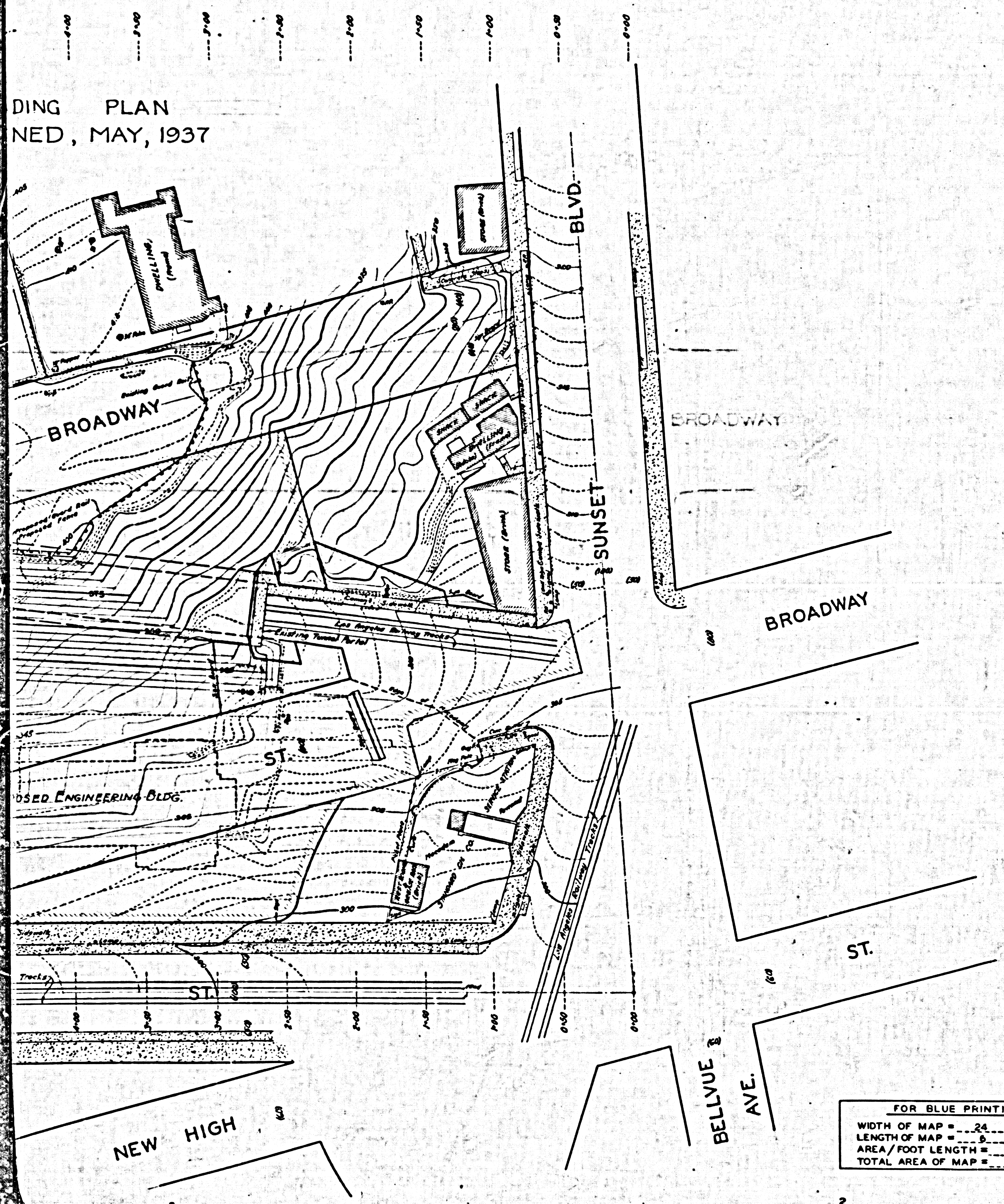

MAP SHOWING  
**PLAN "A"**  
 FOR  
**PROPOSED GRADING PLAN**  
 OF  
**COUNTY BUILDING SITE**  
 IN THE BLOCKS BOUNDED BY  
**SUNSET BLVD. - FORT MOORE PL.**  
**SPRING ST. & BROADWAY**

COUNTY SURVEYORS MAP NO B-1227  
 SHEET NO 1 OF 5 SHEETS  
 SCALE - 1 INCH = 40 FT.

JOB NUMBER 8148  
 ALFRED JONES - COUNTY SURVEYOR  
 SURVEYED - MARCH, 1936.  
 SURVEYED UNDER INSTRUCTIONS OF THE  
 BOARD OF SUPERVISORS PER ORDER DATED  
 MARCH 2, 1936.  
 PLANE TABLE SURVEY  
 FIELD WORK BY... T.M. WALSH.  
 OFFICE WORK BY... M.D. DARLING.  
 F.A. WOOD.  
 CHECKED BY... M. M. CURTIS.

NOTE -  
 For ownerships see C.S.B-1227-3  
 For cross sections see C.S.B-1227-4

LEGEND  
 County Owned Property

FOR BLUE PRINTING  
 WIDTH OF MAP = 24 INCHES  
 LENGTH OF MAP = 8 FEET  
 AREA / FOOT LENGTH = 2  
 TOTAL AREA OF MAP = 5

CSB-1227-1  
 A1 OF A2

The grading shown hereon has been designed  
 for the Building Plan and Building Location  
 as proposed by the Mechanical Dept.

THIS GRADING PLAN ABANDONED, MAY, 1937

COUNTY SURVEYORS MAP NO B-1227-1

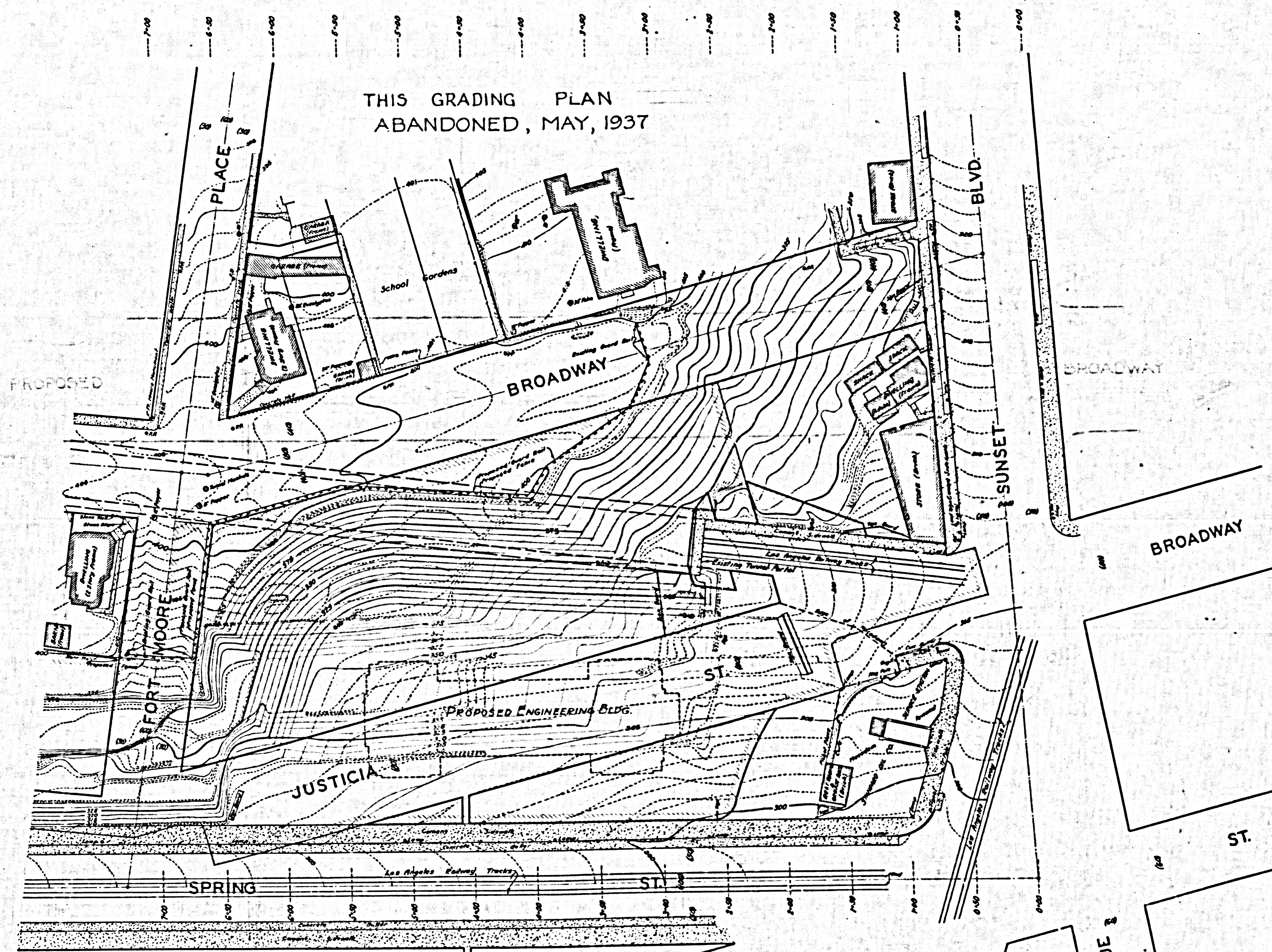

THIS GRADING PLAN  
ABANDONED, MAY, 1937

PROPOSED

CSB-1227-1  
A2 OF A2

NOTE-  
This plan abandoned because of  
uncertainty of stability of tunnel if  
grading were done as indicated.

FOR B
WIDTH OF MA
LENGTH OF MA
AREA / FOOT L
TOTAL AREA