

MAP SHOWING
PUBLIC & PRIVATE OWNERSHIP
 AT PROPOSED
COUNTY BUILDING SITE
 IN THE BLOCKS BOUNDED BY
SUNSET BLVD - FORT MOORE PL.
SPRING ST. & HILL ST.

COUNTY SURVEYORS MAP NO. B-1227
 SHEET NO. 3 OF 5 SHEETS
 SCALE - 1 INCH = 40 FT.

JOB NUMBER 8148.
 ALFRED JONES - COUNTY SURVEYOR
 SURVEYED - MARCH 1936.
 SURVEYED UNDER INSTRUCTIONS OF THE
 BOARD OF SUPERVISORS PER ORDER DATED
 MARCH 2, 1936.
 COMPILED FROM RECORDS
 OFFICE WORK BY... F.A. WOOD
 CHECKED BY... M.H. CURTIS

NOTE:
 For grading plans see C.S. B-1227-1 & 2
 For cross sections see C.S. B-1227-4

Index 2

LEGEND
 [Hatched Box] County Owned Property

FOR BLUE PRINTING
 WIDTH OF MAP = 29 INCHES
 LENGTH OF MAP = 6 FEET
 AREA / FOOT LENGTH = 2
 TOTAL AREA OF MAP = 12

CSB-1227-3
 A1 OF A2

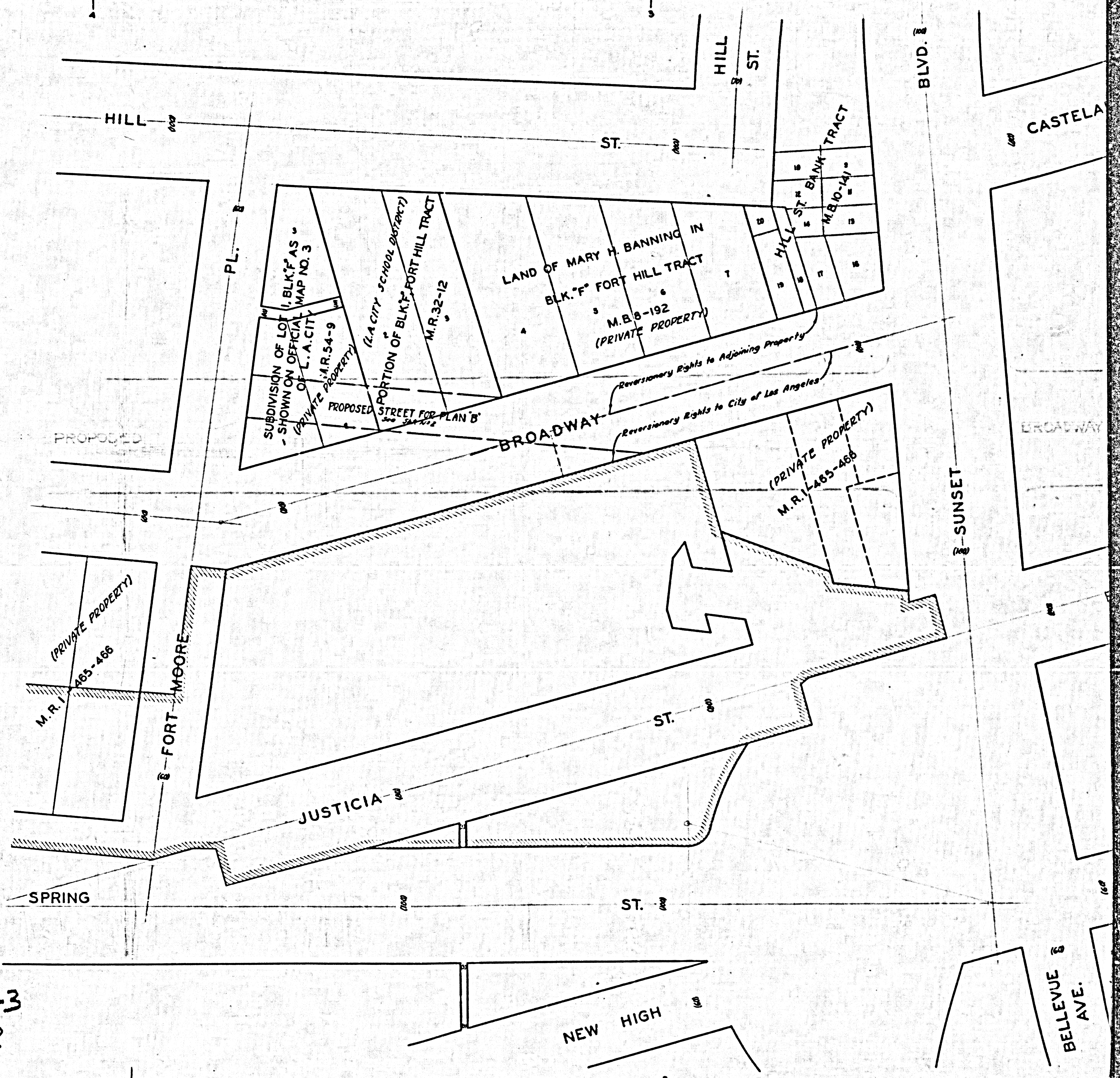

CSB-1227-3
 A2 OF A2

NEW HIGH

BELLEVUE
 AVE.