

CROSS SECTIONS FOR  
**GRADING PLAN "E"**  
 FOR A PORTION OF THE  
**CIVIC CENTER**  
 IN THE AREA BOUNDED BY  
**SUNSET BLVD. - HILL ST.**  
**CALIFORNIA ST. & SPRING ST.**  
 COUNTY SURVEYORS MAP NO B-1227

SHEET NO 9 OF 10 SHEETS  
 SCALE - 1 INCH = 20 FT.

JOB NUMBER 7687  
 ALFRED JONES - COUNTY SURVEYOR  
 SURVEYED SEPTEMBER 1932 - JUNE 1938  
 SURVEYED UNDER INSTRUCTIONS OF THE  
 BOARD OF SUPERVISORS PER ORDER DATED  
 JUNE 22, 1932

PLANE TABLE TOPOGRAPHY  
 FIELD WORK BY T.M. WALSH  
 H.F. EVANS  
 OFFICE WORK BY A.E. TIMMONS  
 M.D. DARLING  
 CHECKED BY M.D. DARLING  
 A.E. TIMMONS

FOR GRADING PLAN SEE C.S. B-1227 SHEET 8

DATUM  
 ELEVATIONS SHOWN HEREON ARE BASED  
 ON THE 1934 U.S.C. & G.S. ADJUSTMENT  
 OF U.S.G.S. B.M. "339" (U.S. 404)

Note: Sections were extended to  
 the E'ly. R/W of Hill St. Nov. 26, 1940.

CSB-1227-9  
 A1 OF A7

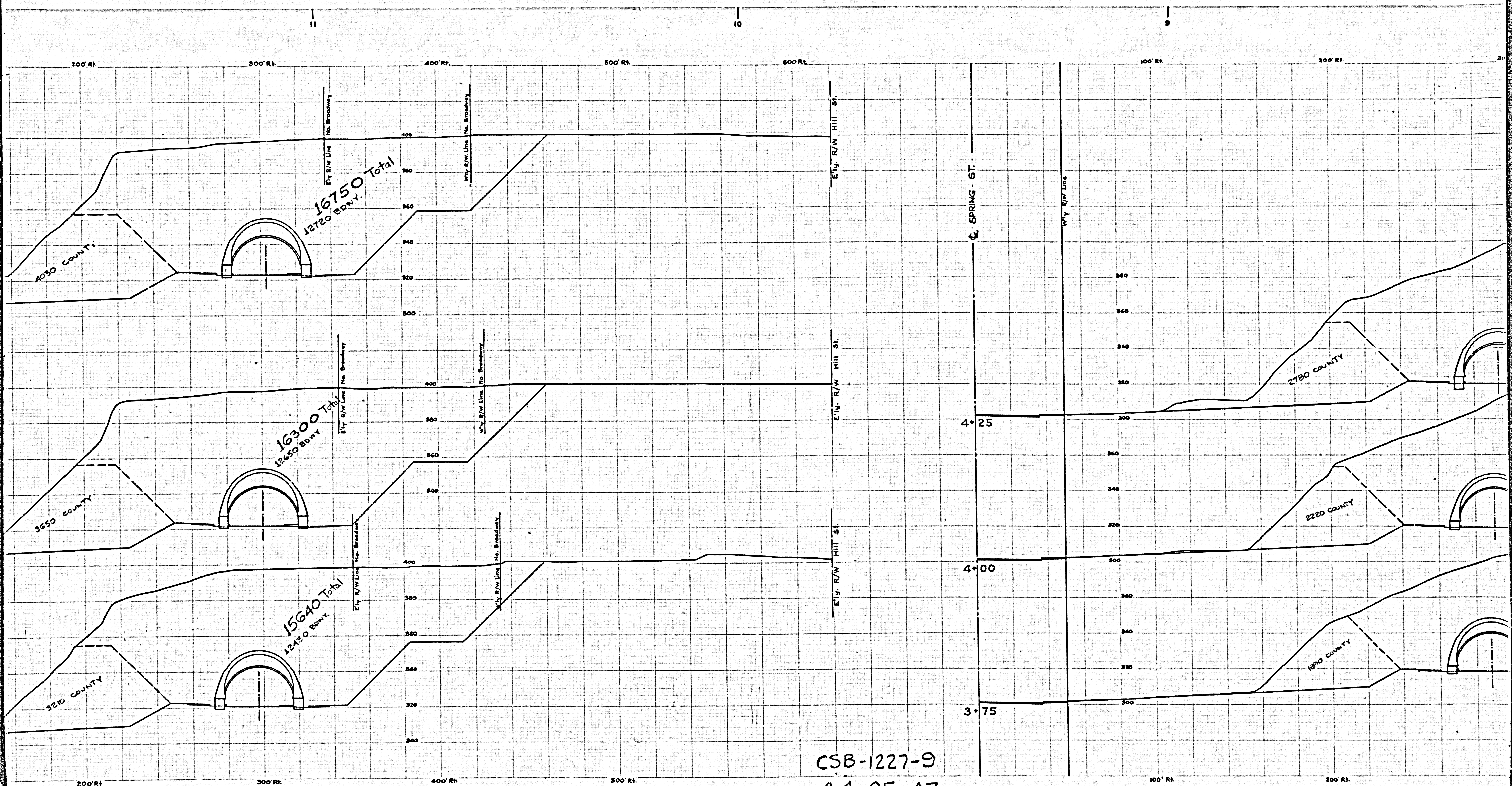

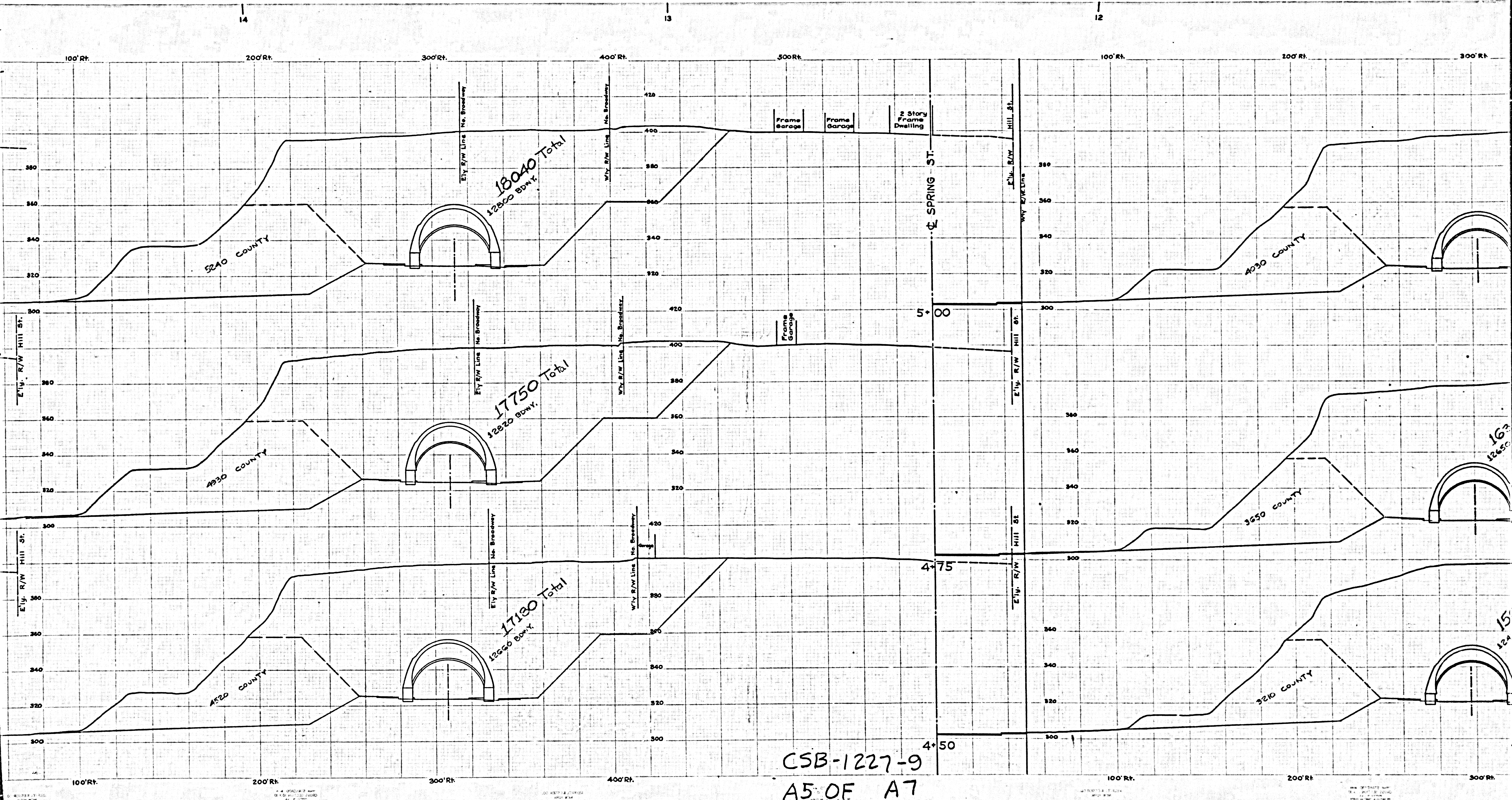

CSB-1227-9  
A5 OF A7

17

16

15

14



CSB-1227-9  
AG OF A7

17

16

15

14

20

19

18

17

CONTINUED ON C.S.B-1227 SHEET 10

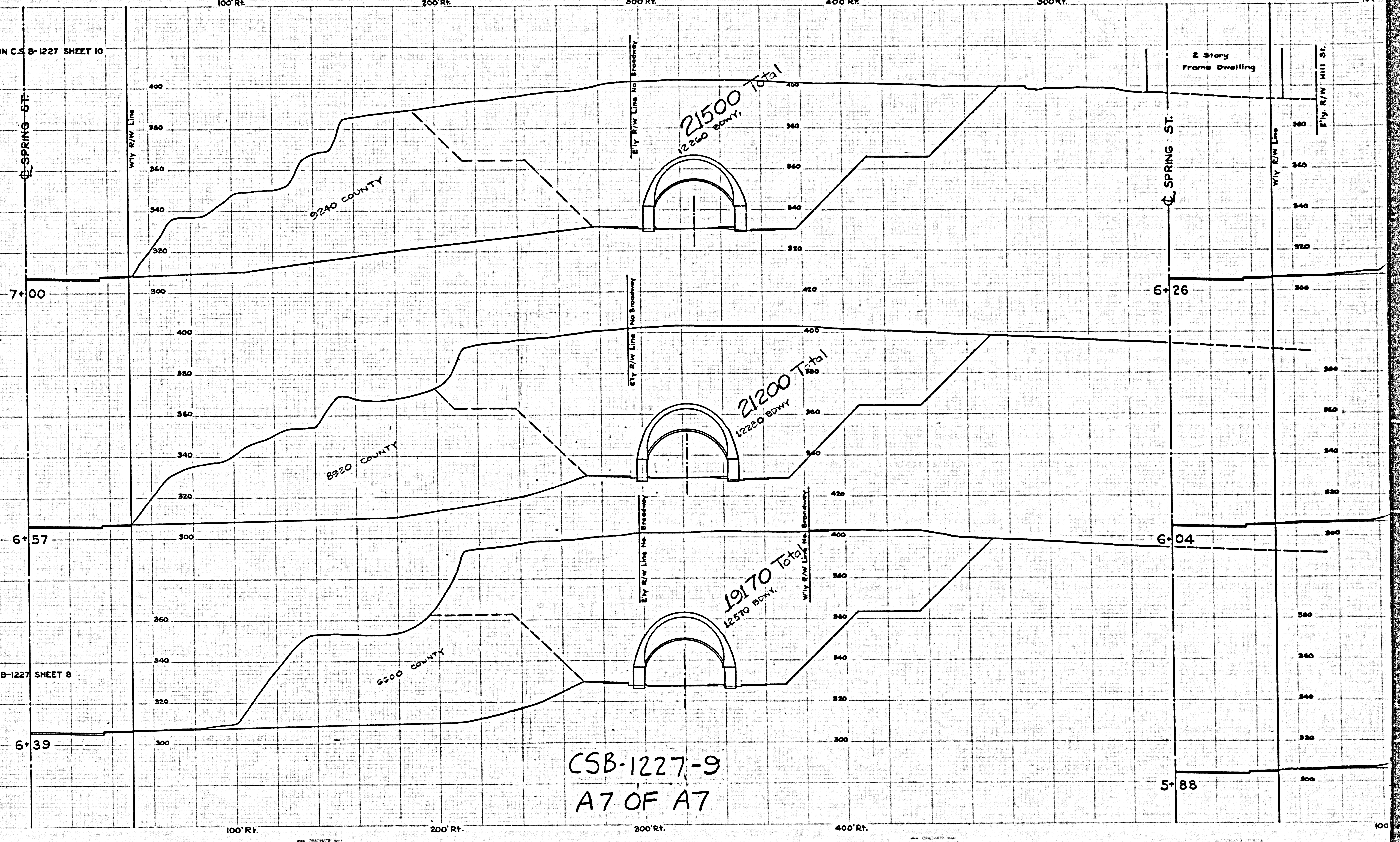

FOR GRADING PLAN SEE C.S.B-1227 SHEET 8

CSB-1227-9  
A7 OF A7

20

19

18

17

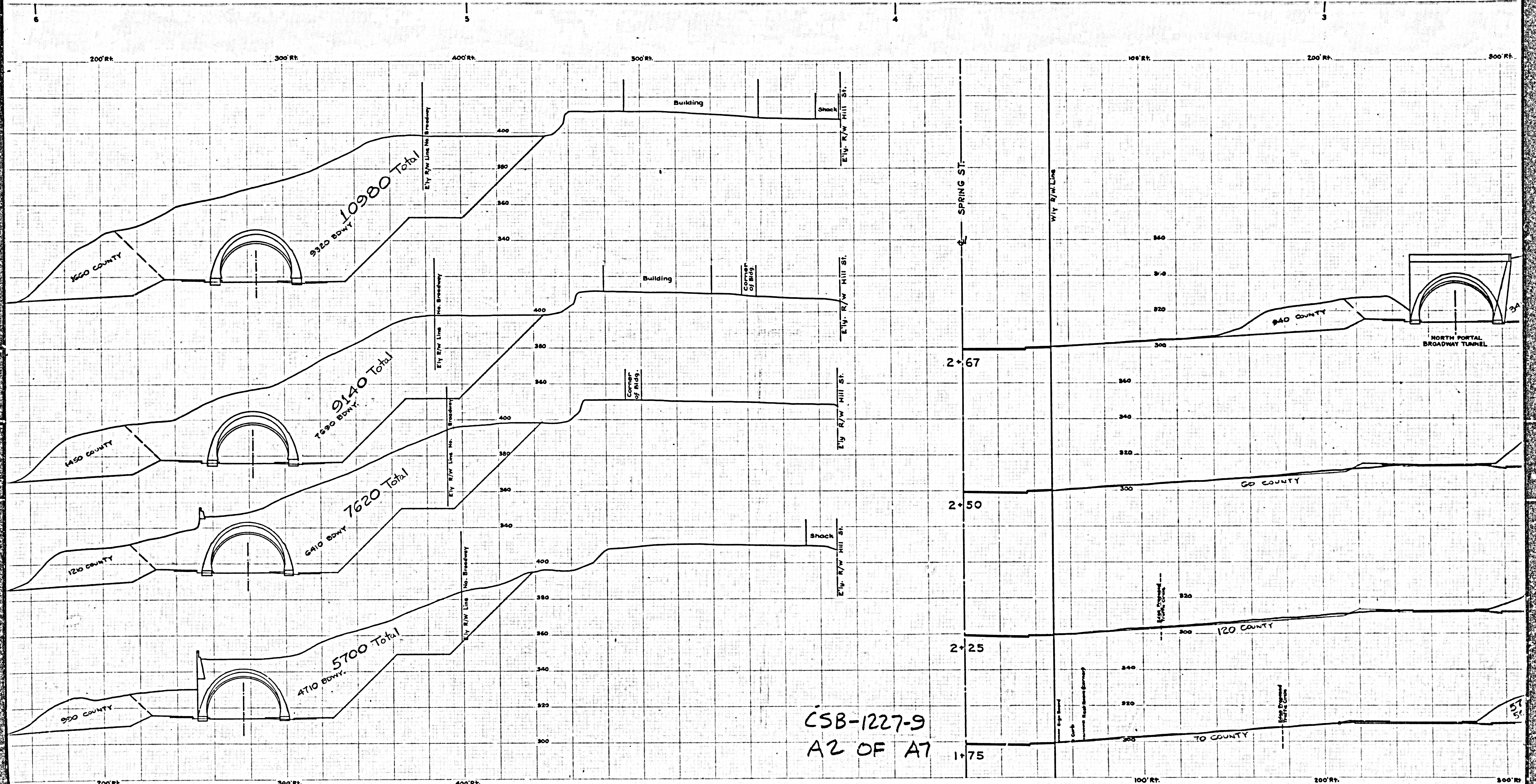

CSB-1227-9  
 A2 OF A7

1+074 BEGINNING OF PROJECT

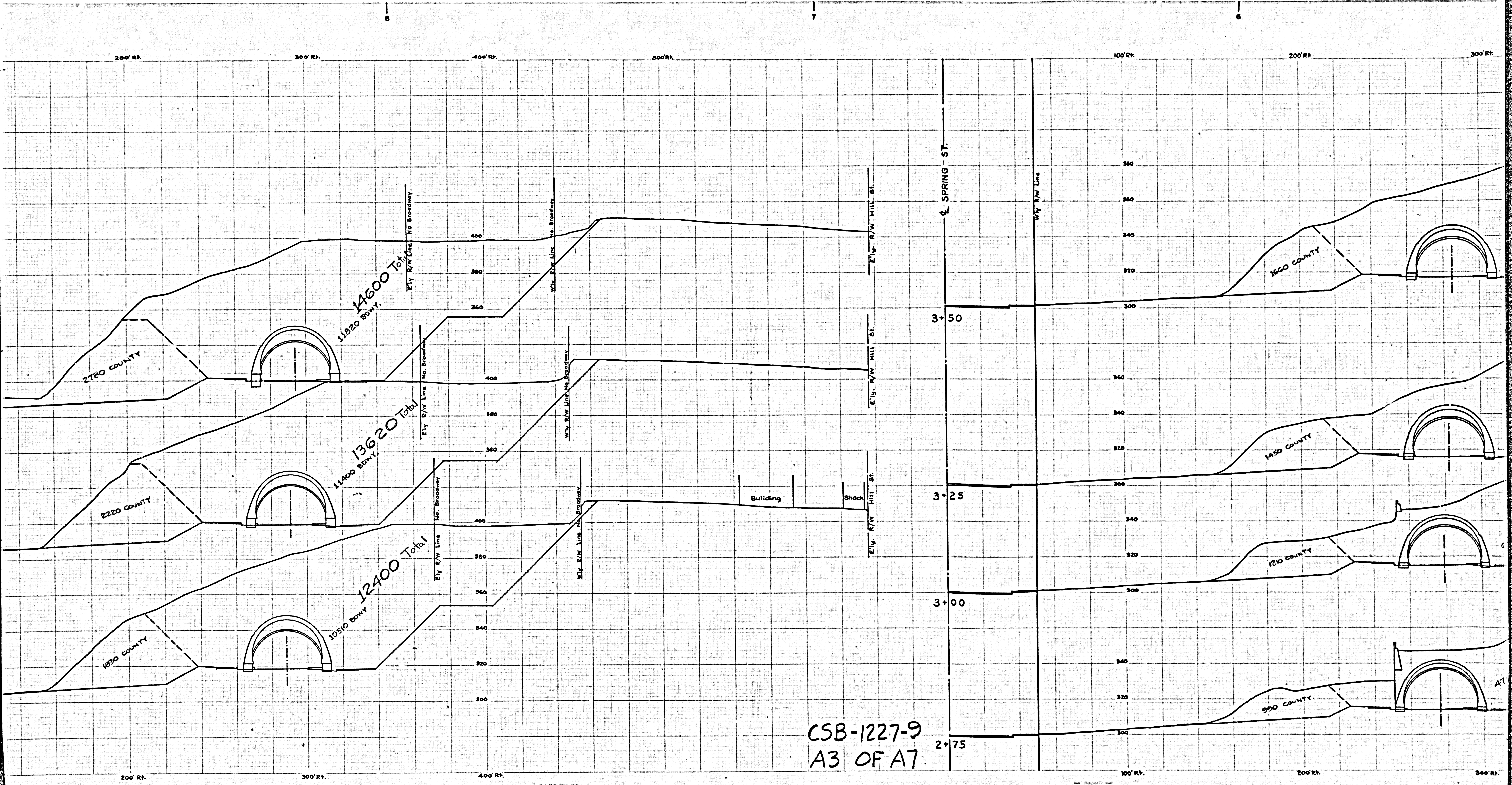

CSB-1227-9  
 A3 OF A7