

TOPOGRAPHIC MAP
 OF
REDONDO COUNTY BEACH
 FROM
 A POINT SOUTH OF PIER AVENUE
 TO
 NORTHERLY BOUNDARY OF RANCHO LOS PALOS VERDES
 COUNTY SURVEYORS MAP NO B-1600
 SCALE: 1 INCH = 50 FT.
 JOB NUMBER 7981
ALFRED JONES - COUNTY SURVEYOR
 SURVEYED APRIL 1940
 SURVEYED UNDER INSTRUCTIONS OF THE
 BOARD OF SUPERVISORS PER ORDER DATED
 MAY 28, 1930
 PLANE TABLE SHEETS NO G-207, G-208
 F.B. 838 - 8 - 34
 FIELD WORK BY L. B. MOORE
 T. M. WALSH
 OFFICE WORK BY C. A. TERRY
 CHECKED BY M. D. DARLING

FOR BOUNDARY LINE SURVEY SEE C. S. B-532 SHEET 1

DATUM - MEAN SEA LEVEL
 ELEVATIONS SHOWN HEREON ARE BASED ON THE
 1929 ADJUSTMENT OF U.S.C.G.S. BM 56 (143.28)

California Coordinate System, Zone 7
 Coordinates Fixed - Oct 23, 1947, L.C.M.
 Underground Water Lines Added - Aug 4, 1948, L.D.
 Topography Revised January 1959, D.E.M.

CSB-1600
 A10FA'3

COUNTY SURVEYORS MAP NO B-1600

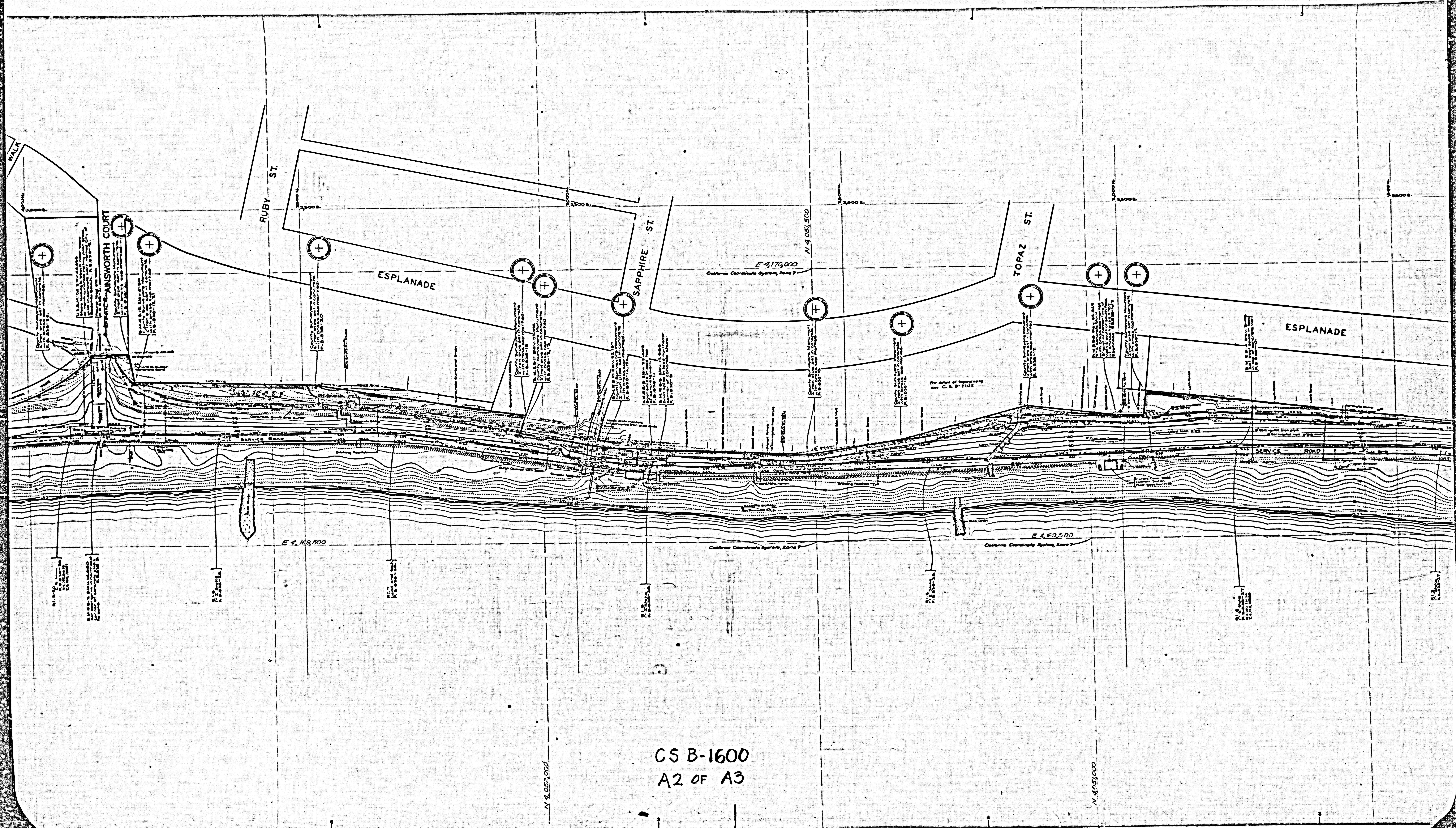

CS B-1600
A2 OF A3

СОПЛАТЪ СЪРВЕАЛОСЪ МЪДЪ №Б В-1800

СОПЛАТЪ СЪРВЕАЛОСЪ МЪДЪ №Б В-1800

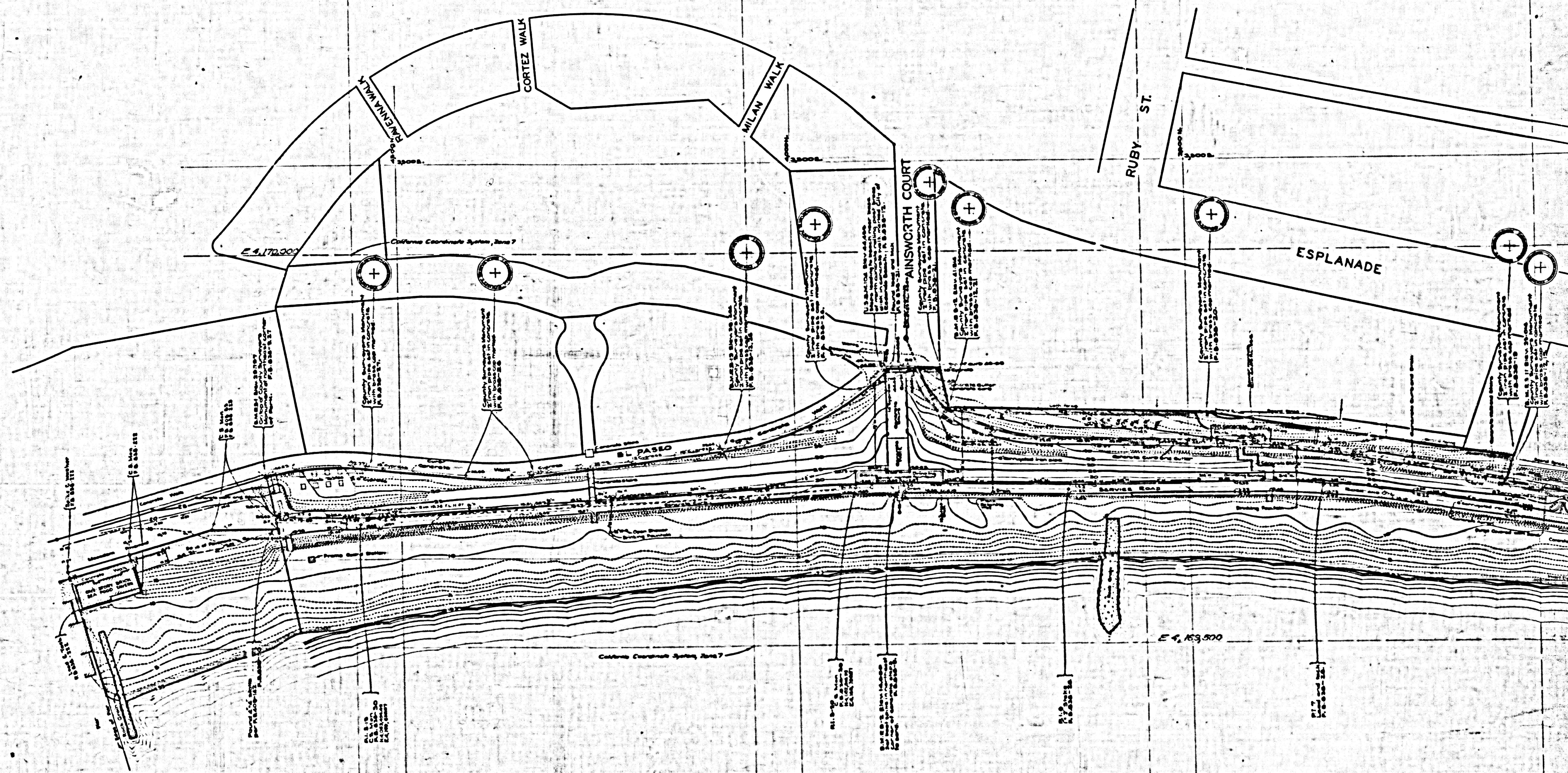

CSB 1600
A30FA3

А-1.082-002