

MARGINAL MAP
NOT TO SCALE.

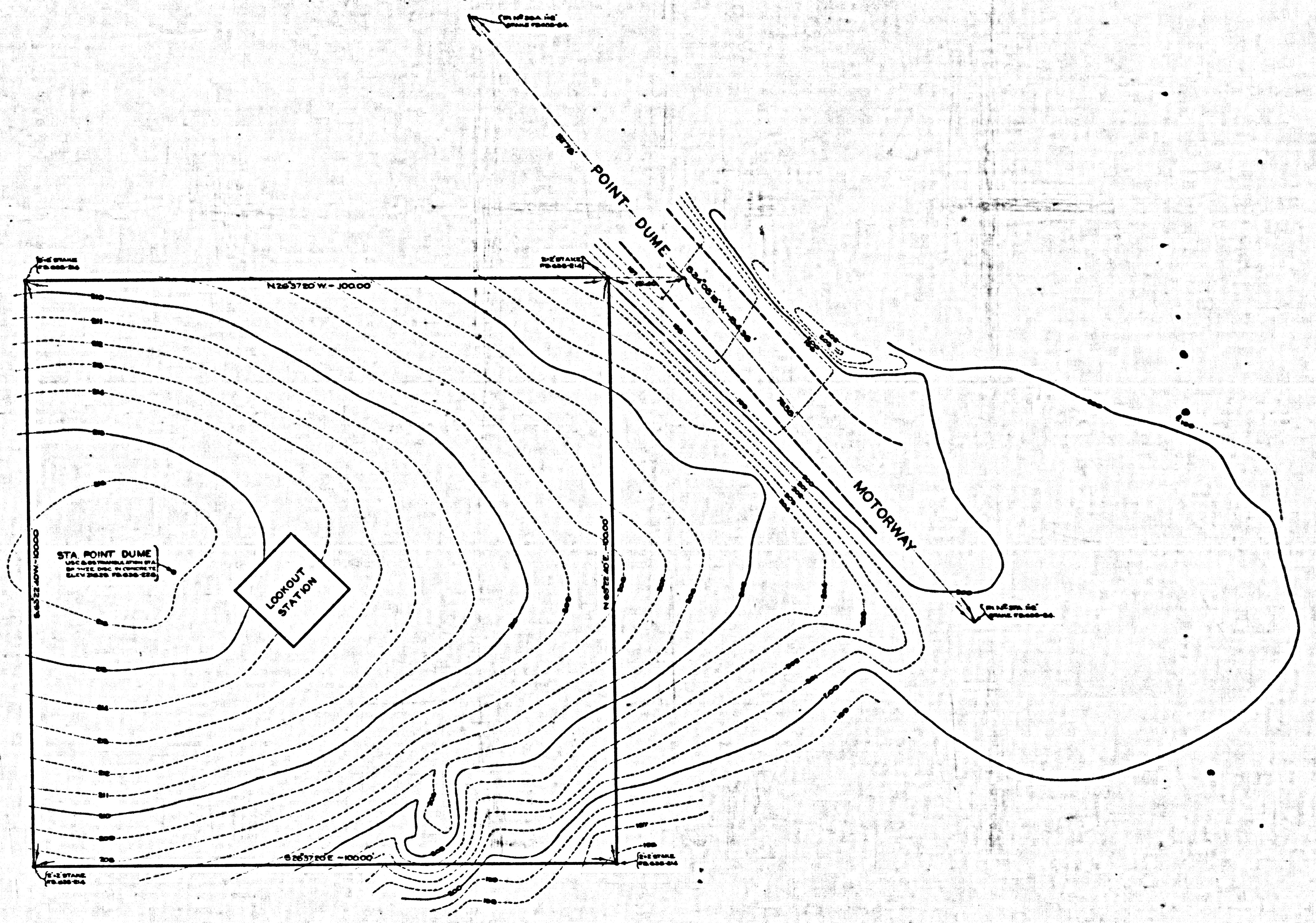

MAP OF
POINT DUME LOOKOUT STATION
ON

POINT DUME MOTORWAY
COUNTY SURVEYORS MAP NO B-1615.
SCALE: 1 INCH = 10 FT.

JOB NUMBER 8147

ALFRED JONES-COUNTY SURVEYOR
SURVEYED JULY, 1940.

SURVEYED AT REQUEST OF COUNTY FORESTER
AND FIRE WARDEN BY RULE 2, ORDINANCE 929,
PER LETTER DATED JUNE 28, 1940.
BEARINGS ARE BASED ON TRUE BEARING BY
TIE TO U.S.C.G.S. TRIANGULATION SYSTEM
AT STATION POINT DUME.

F.B. 835-34,214
PLANE TABLE SHEET NS D-193

FIELD WORK BY T.M. WALSH
OFFICE WORK BY T.J. STEVENSON
CHECKED BY K.R.W. PHERSON

DATUM
ELEVATIONS SHOWN HEREON ARE BASED ON
THE 1928 U.S.C.G.S. ADJUSTMENT OF U.S.C.G.S.
B.M. "R-40-1928 RESET 1937" (U.S. 1310)

INDEX # 57
099-037

CSB-1615
A1 OF A1

COMPLI 2014E022 MWB NS B-1615

COMPLI 2014E022 MWB NS B-1615

COMPLI 2014E022 MWB NS B-1615

COMPLI 2014E022 MWB NS B-1615