

SHEET 5 OF 5 SHEETS
COUNTY SURVEYORS MAP NO. B-1623

SHEET 5 OF 5 SHEETS
COUNTY SURVEYORS MAP NO. B-1623

SHEET 5 OF 5 SHEETS
COUNTY SURVEYORS MAP NO. B-1623

SHEET 5 OF 5 SHEETS
COUNTY SURVEYORS MAP NO. B-1623

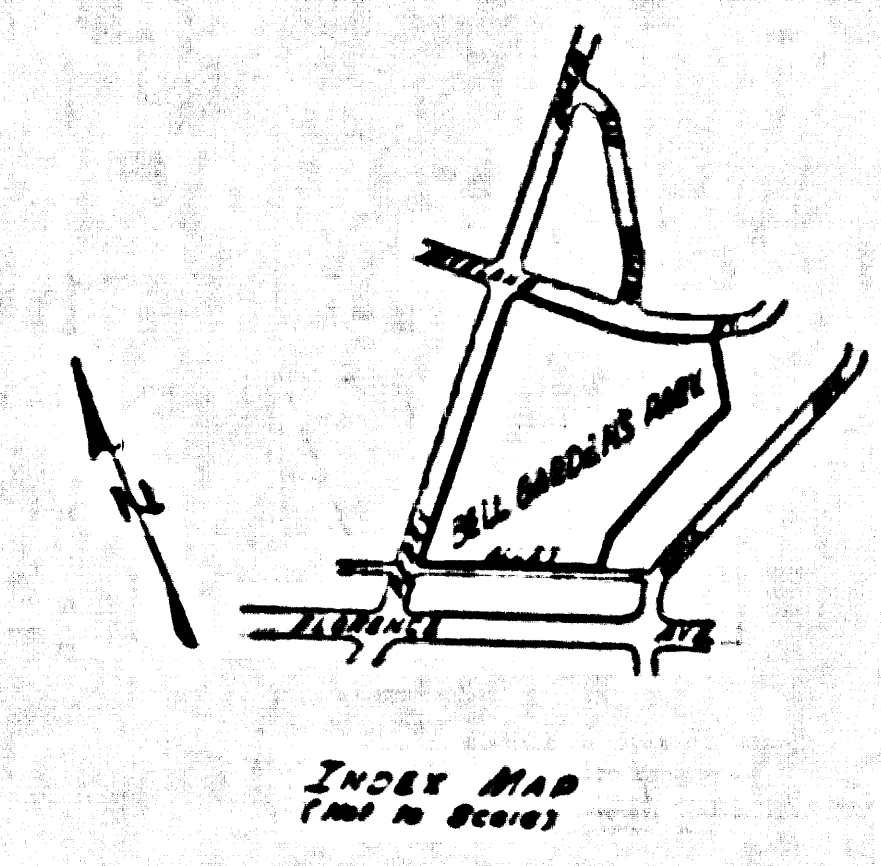
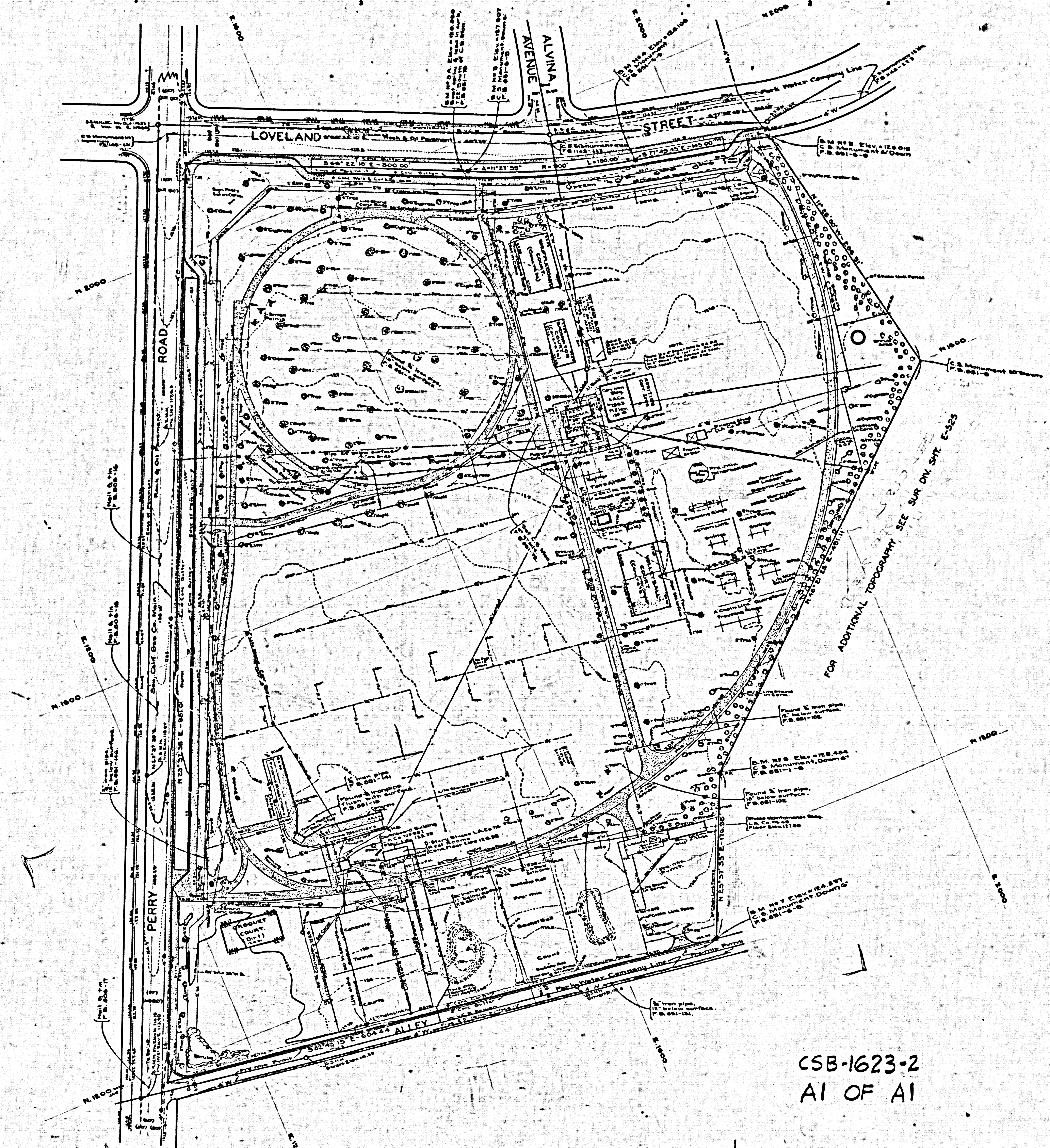

TOPOGRAPHIC MAP

OF
BELL GARDENS PARK

AT
PERRY ROAD AND LOVELAND STREET
(BEING A PORTION OF RANCHO SAN ANTONIO PER D.O.R. 16748-120)

COUNTY SURVEYORS MAP NO. B-1623
SHEET 2 OF 2 SHEETS
SCALE: 1 INCH = 40 FT.

JOB NUMBER 5244
ALFRED JONES - COUNTY SURVEYOR
SURVEYED MAY 1945

SURVEYED UPON REQUEST OF THE CHIEF MECHANICAL
ENGINEER UNDER SEC. 79 ORDINANCE 4099 BY LETTER
DATED MARCH 20, 1945

BEARINGS ARE BASED ON THE BEARING OF
PERRY ROAD AS SHOWN ON C.S.B-158-2'

PLANE TABLE SHEET E-120, E-120-A
F.B. 808-18-17; F.B. 851-8-18, 62-78, 102-148, F.B. 1145

FIELD WORK BY W. E. BRADEN

OFFICE WORK BY J. A. LYON

CHECKED BY M. D. DARLING

FOR BOUNDARY SURVEY AND ORIGINAL TOPOGRAPHY SEE C.S.B-1623-SHEET 1
FOR CALCULATION MAP AND GENERAL GRADING PLAN SEE C.S.B-1641

DATUM - MEAN SEA LEVEL
ELEVATIONS SHOWN HEREON ARE BASED UPON
B.M. 1487 (F.B. 728-76), THE DATUM OF WHICH
WAS DETERMINED FROM U.S.C. & G.S. B.M. 73-33'
(U.S. 37) BASED UPON THE U.S.C. & G.S. ADJUST-
MENT OF 1934

Topography Revised under U.S. O.R.A. 16 by T.M.P. 1-12-55
Topography Revised under 4809414 by 128 8-21-60

CSB-1623-2
A1 OF A1