

FOR LATER BOUNDARY SURVEY SEE C.S.B-2701
 MAP OF
LAGUNA PARK & PLAYGROUND
 BEING
 A PORTION OF HOLLOWAY PARK TRACT, M.R. 43-71.

COUNTY SURVEYORS MAP NO B-1625
 SCALE - 1 INCH = 50 FT.

JOB NUMBER 8258
 ALFRED JONES - COUNTY SURVEYOR
 SURVEYED - DECEMBER, 1938 - NOVEMBER, 1940

SURVEYED UPON REQUEST OF THE REGIONAL PLANNING
 COMMISSION PER RULE 21, ORDINANCE 929, BY LETTER DATED
 DECEMBER 5, 1938 & SEPTEMBER 10, 1940.
 BEARINGS ARE BASED ON THE BEARING OF
 WHITTIER BOULEVARD PFR C.S.B-386, SHEET I.

FB. 401-123-140 & FB. 652-5-9.
 FIELD WORK BY..... H. E. EVANS
 T. M. WALSH
 OFFICE WORK BY..... D. A. WHITE
 CHECKED BY..... R. R. McPHERSON
 A. A. ROESER

INDEX 7

KNOWN AS 'LAGUNA COUNTY PARK' PRIOR TO JUNE 16, 1942

Acres added 10-30-59 C.E.B.
 Name changed to Laguna Park - E 150-127, M.R. BK 406-126.

CSB-1625
 A1 OF A2

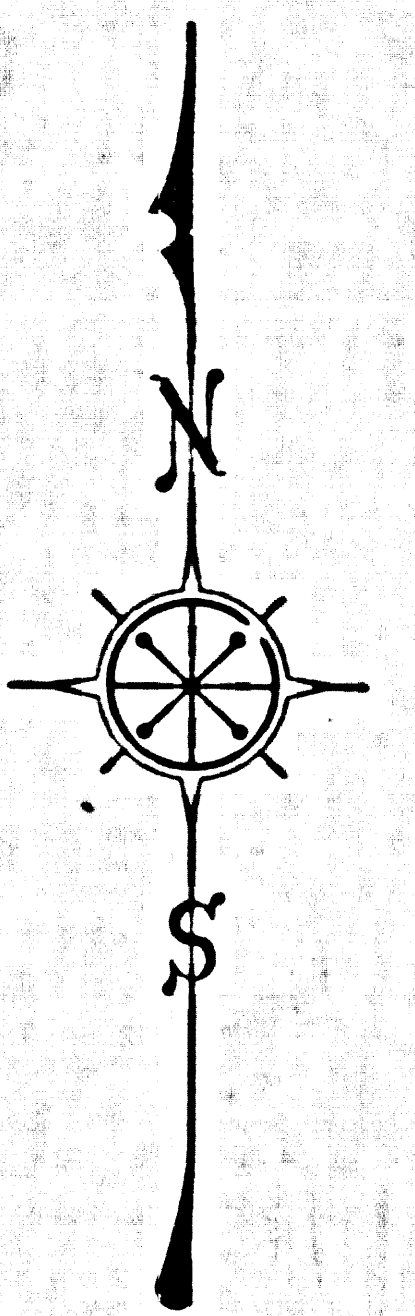

COUNTY SURVEYORS MAP NO B-1625

COUNTY SURVEYORS MAP NO B-1625

CONTRACTOR'S MAP NO. 1625

CONTRACTOR'S MAP NO. 1625

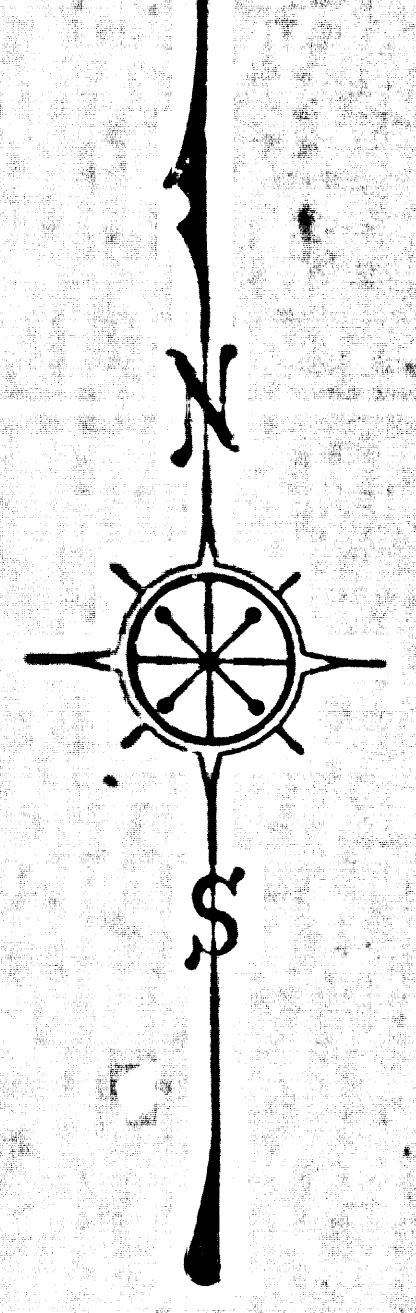
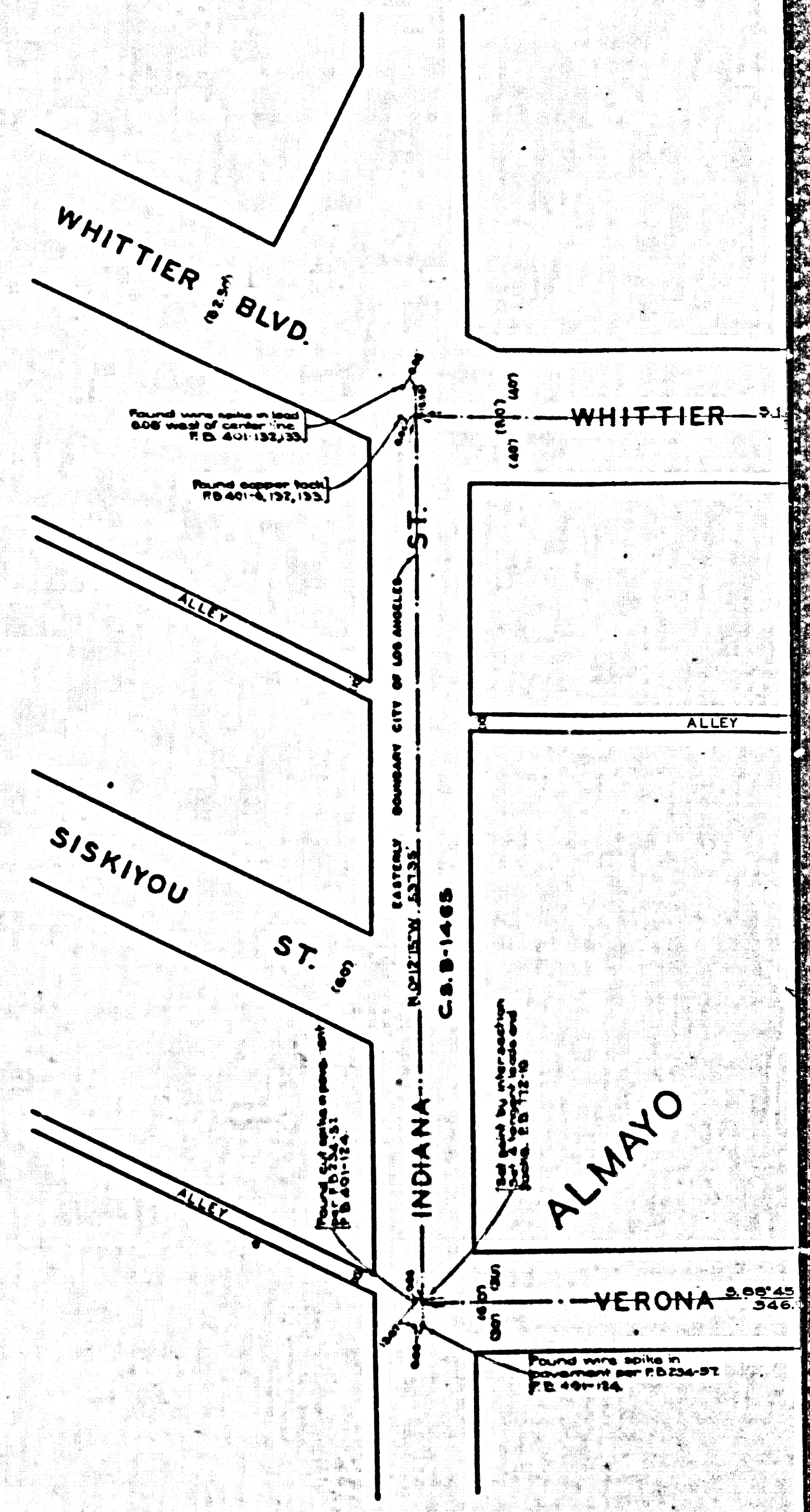
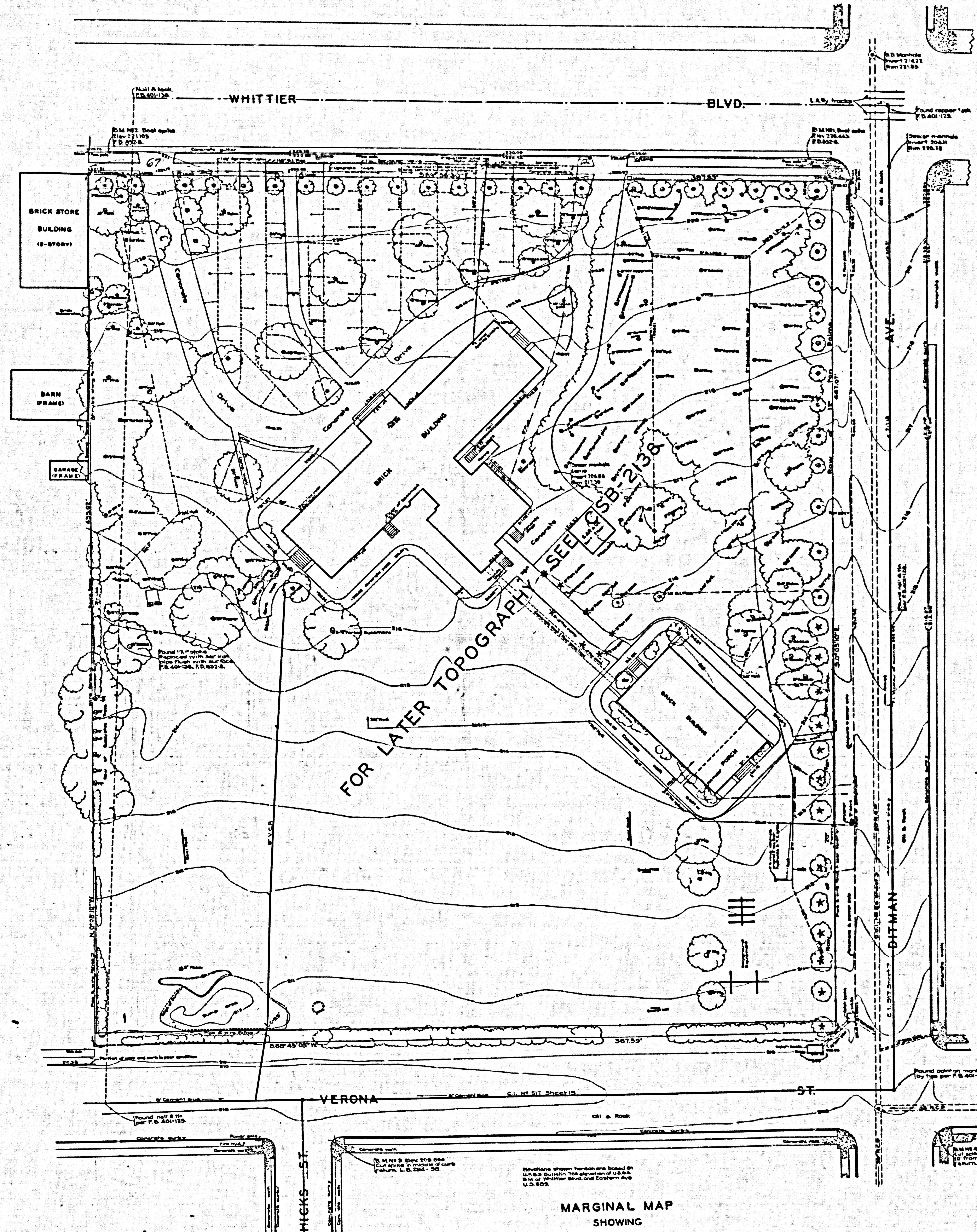

Boundaries shown hereafter based on
 U.S.G.S. Division 100 of U.S.G.S.
 8 of Whittier Blvd. and Verona St.
 U.S. 609

MARGINAL MAP
 SHOWING
 TOPOGRAPHY
 SCALE: 1 INCH = 20 FT.

CSB-1625
 A2 OF A2