

LOCATION

PLAN
Scale: 1" = 50'

SEE

C.S.B-1743

PROFILE
Horizontal 1" = 80'
Scale: Vertical 1" = 8'

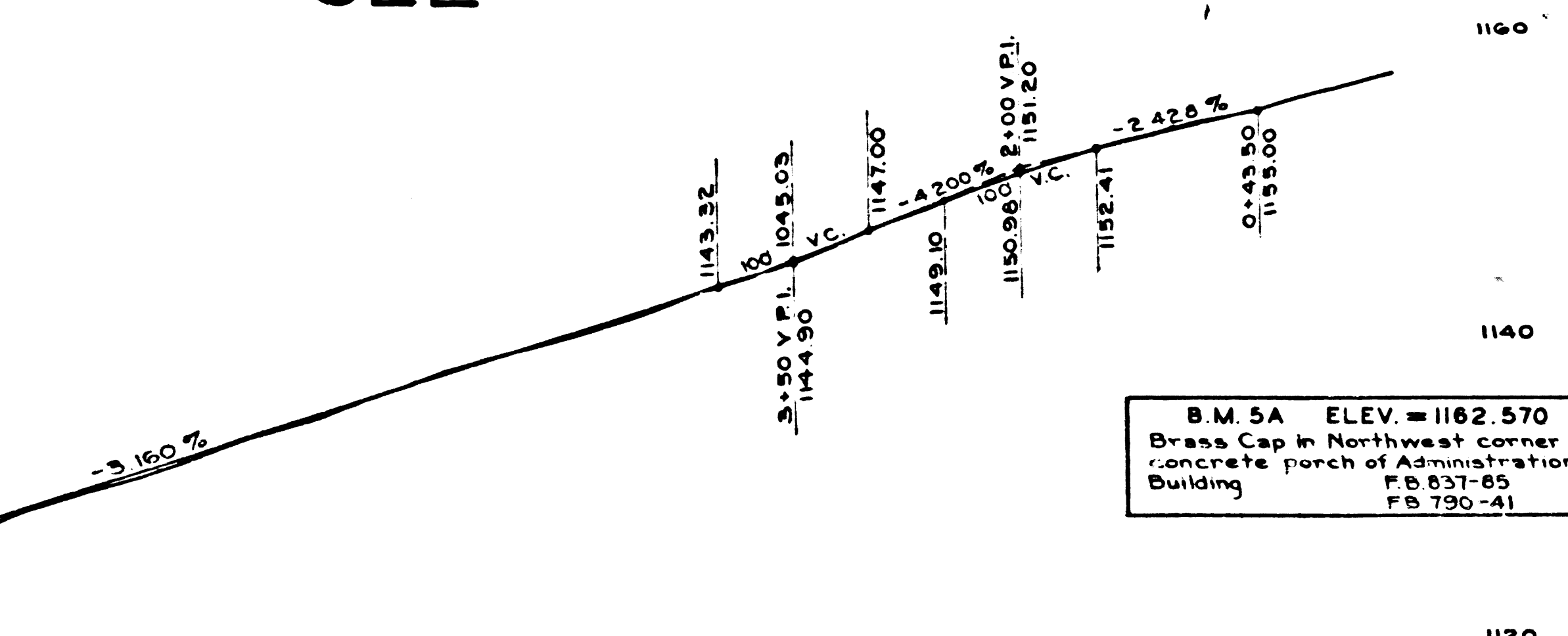

Cut Slopes 1:1
Fill Slopes 1 1/2:1
Road Bed 30 Ft.
Swell Factor 0.30

TYPICAL CROSS SECTION
FOR
UNSHAPED ROADBED

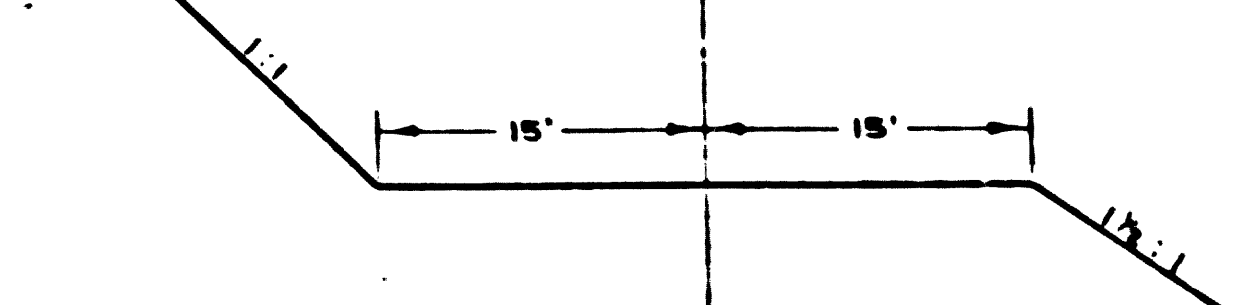

On Curves—County Surveyor's Standard Superelevation to be Used
(See Chart Below)

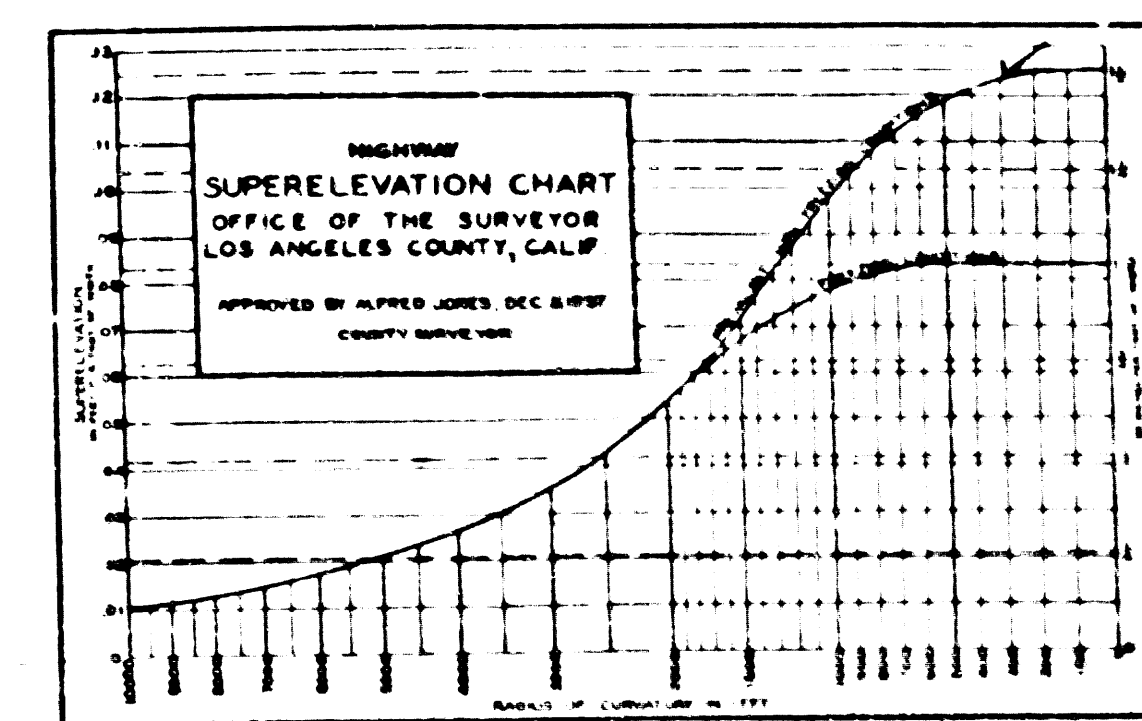

PLAN AND PROFILE OF
WAYSIDE HONOR FARM ROAD

FROM
CAMP HEADQUARTERS
TO
GOLDEN STATE HIGHWAY
COUNTY SURVEYORS MAP N°B-1630
SCALES - AS SHOWN

JOB NUMBER 8221
ALFRED JONES - COUNTY SURVEYOR
SURVEYED APRIL 1940 - NOVEMBER 1940
SURVEYED UNDER INSTRUCTIONS OF THE
BOARD OF SUPERVISORS PER ORDER DATED
SEPTEMBER 24, 1940

F. B. 837-75-120
FIELD WORK BY: F. C. HOWARD
OFFICE WORK BY: J. A. LYON
CHECKED BY: L. K. FREEMAN

DATUM - MEAN SEA LEVEL
ELEVATIONS SHOWN HEREON ARE BASED ON THE
1922 ADJUSTMENT OF U.S.C. & G.S. B.M. 152 (U.S. 2' 6.3)

CSB-1630
A1 OF A4

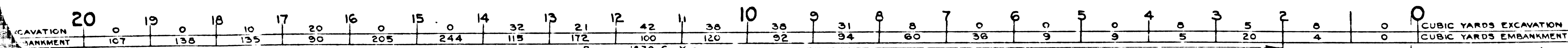

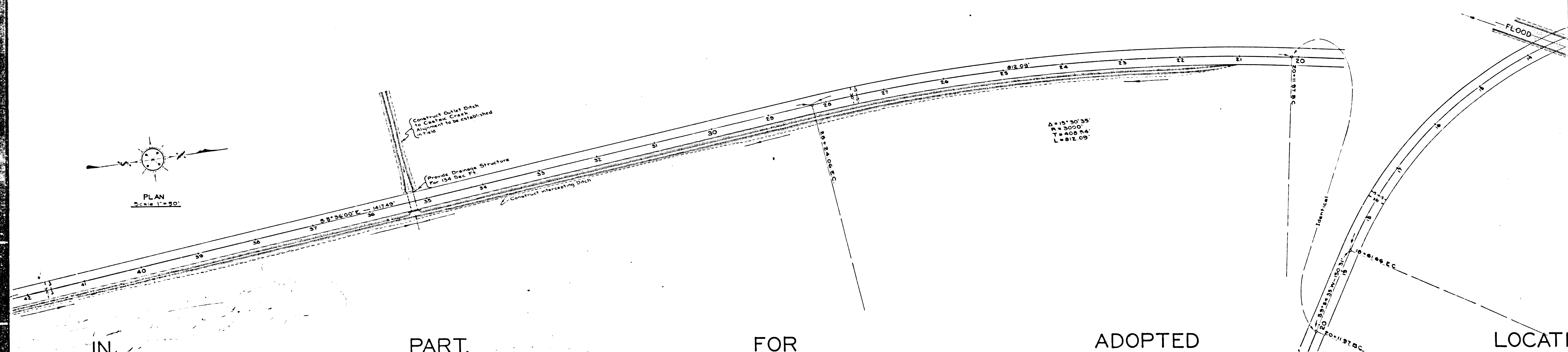
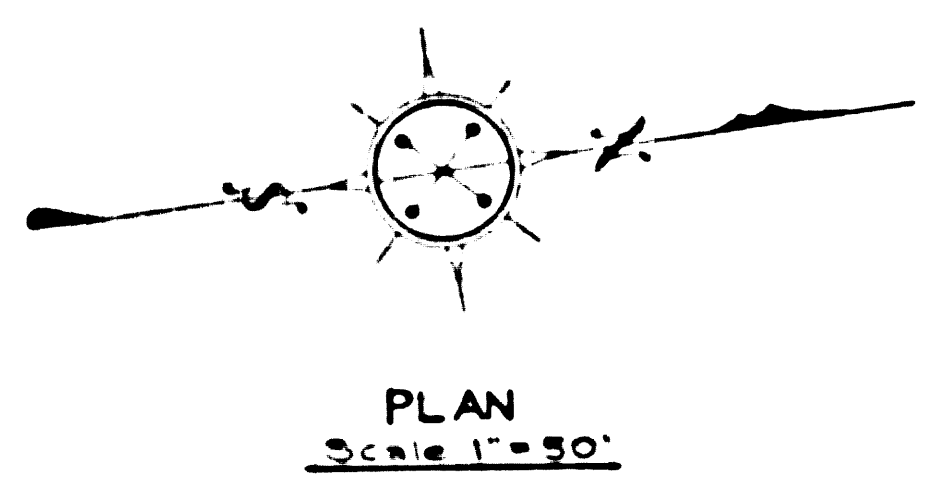

IN PART, FOR ADOPTED LOCATION

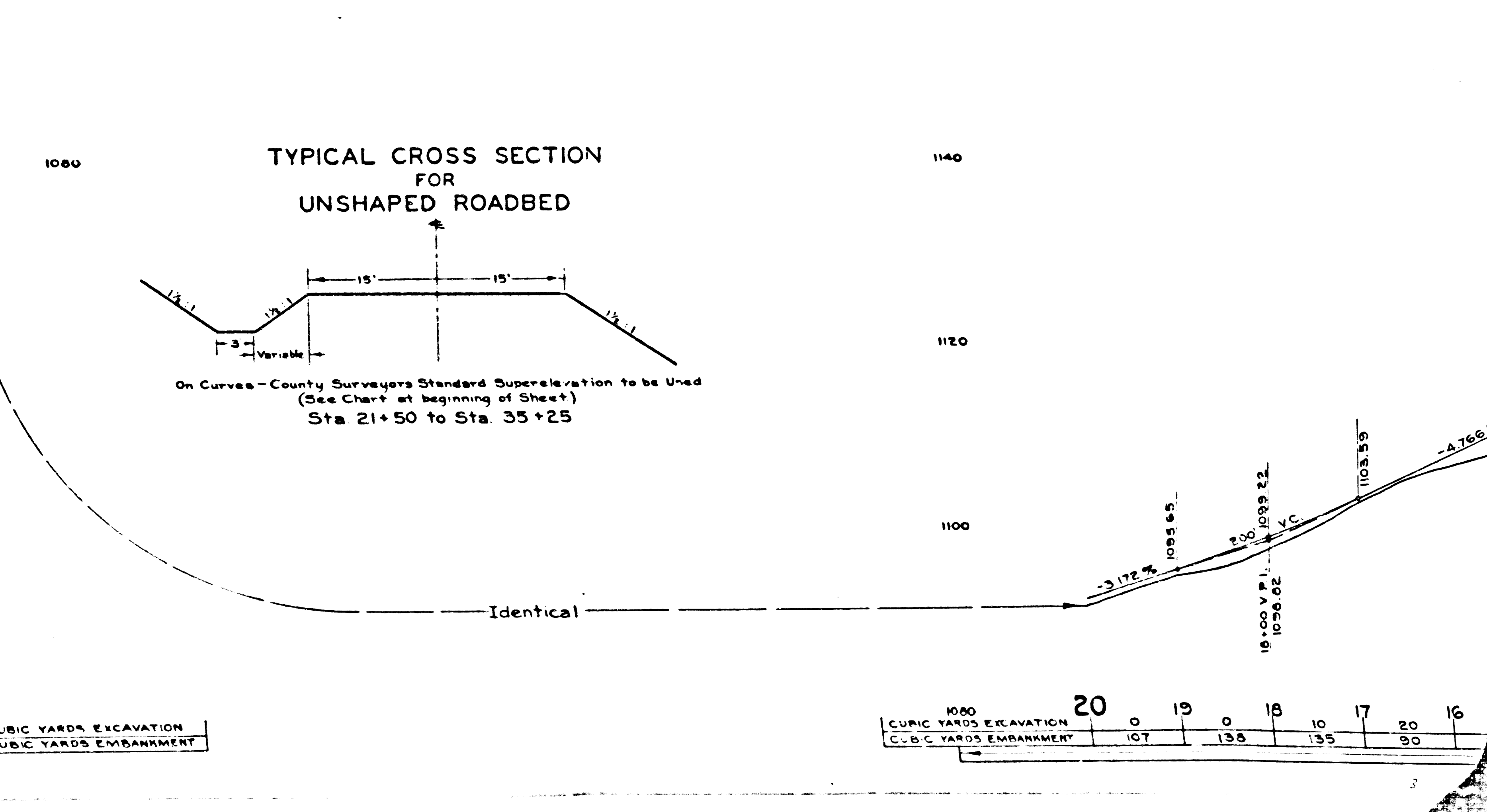
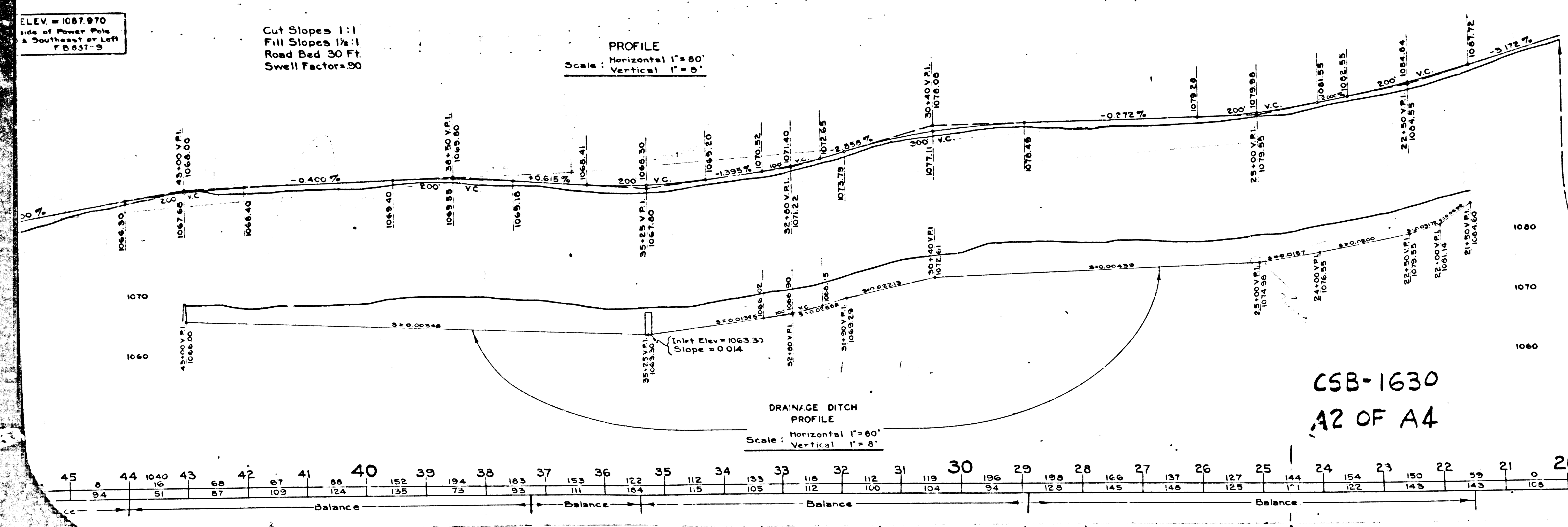

CSB-1630
A2 OF A4

Station	Excavation (Cubic Yards)	Embankment (Cubic Yards)
20	107	
19	135	
18	135	
17	135	
16	90	

