

TBM 2. ELEV. = 367.173
 Found Lead & rock, South end
 of curb return, Southeast
 corner 4th St. & College St.
 FB 1173-23

TBM 7. ELEV. = 478.159
 1/2" Stake on South Tract Line
 at West edge of Avocado
 Grove, 110th East of College
 Street intersection, FB 1173-28

T.B.M. 3 ELEV. = 380.581
 Found Lead & rock, middle
 of curb return, Northwest
 corner 4th St. & San Jose Ave.
 FB 1173-25

TBM 6 ELEV. = 561.4
 Set curbside washer &
 base of Eucalyptus
 west side of Drive,
 of San Jose Ave. w/c
 at Tract Line

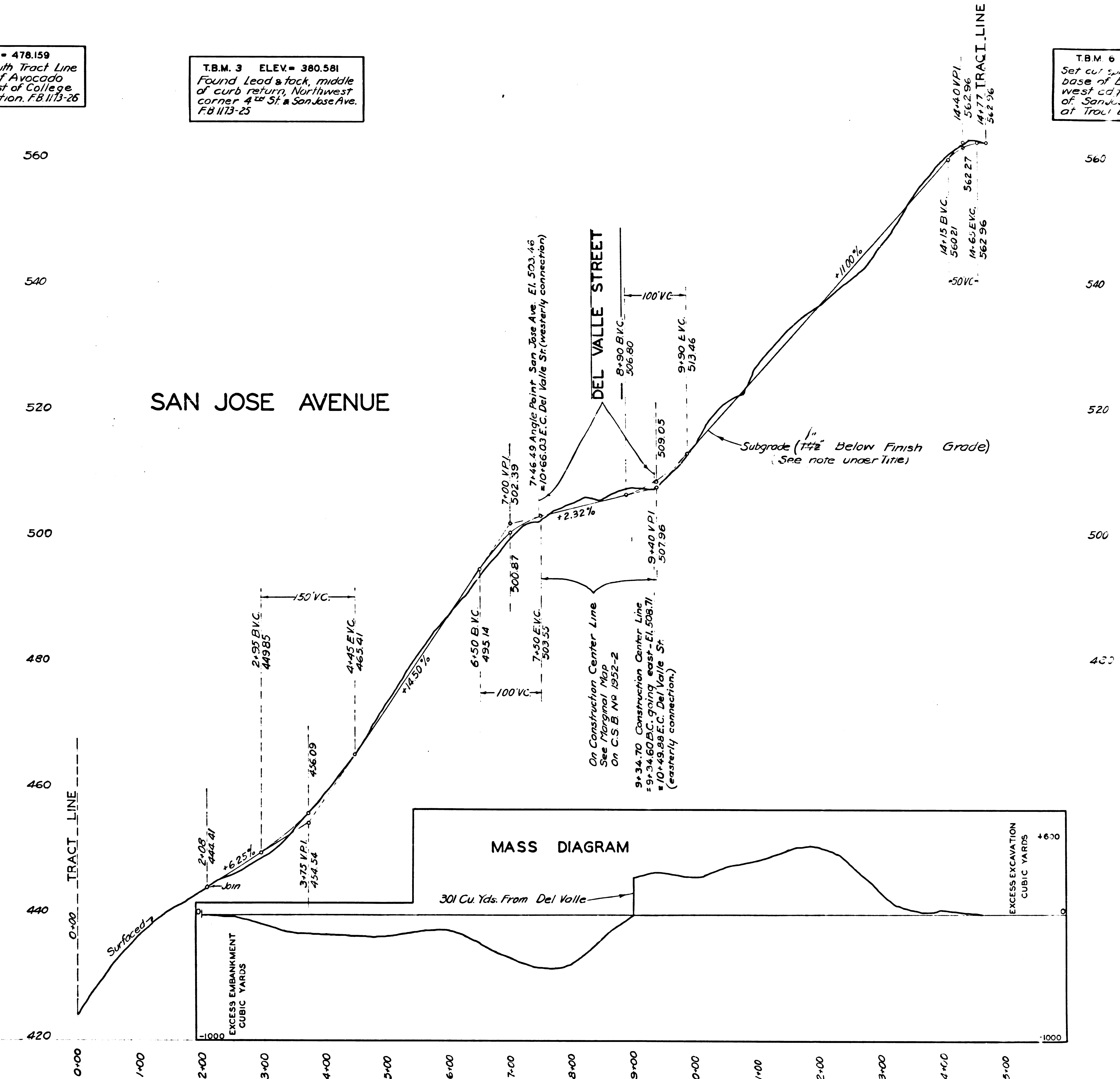
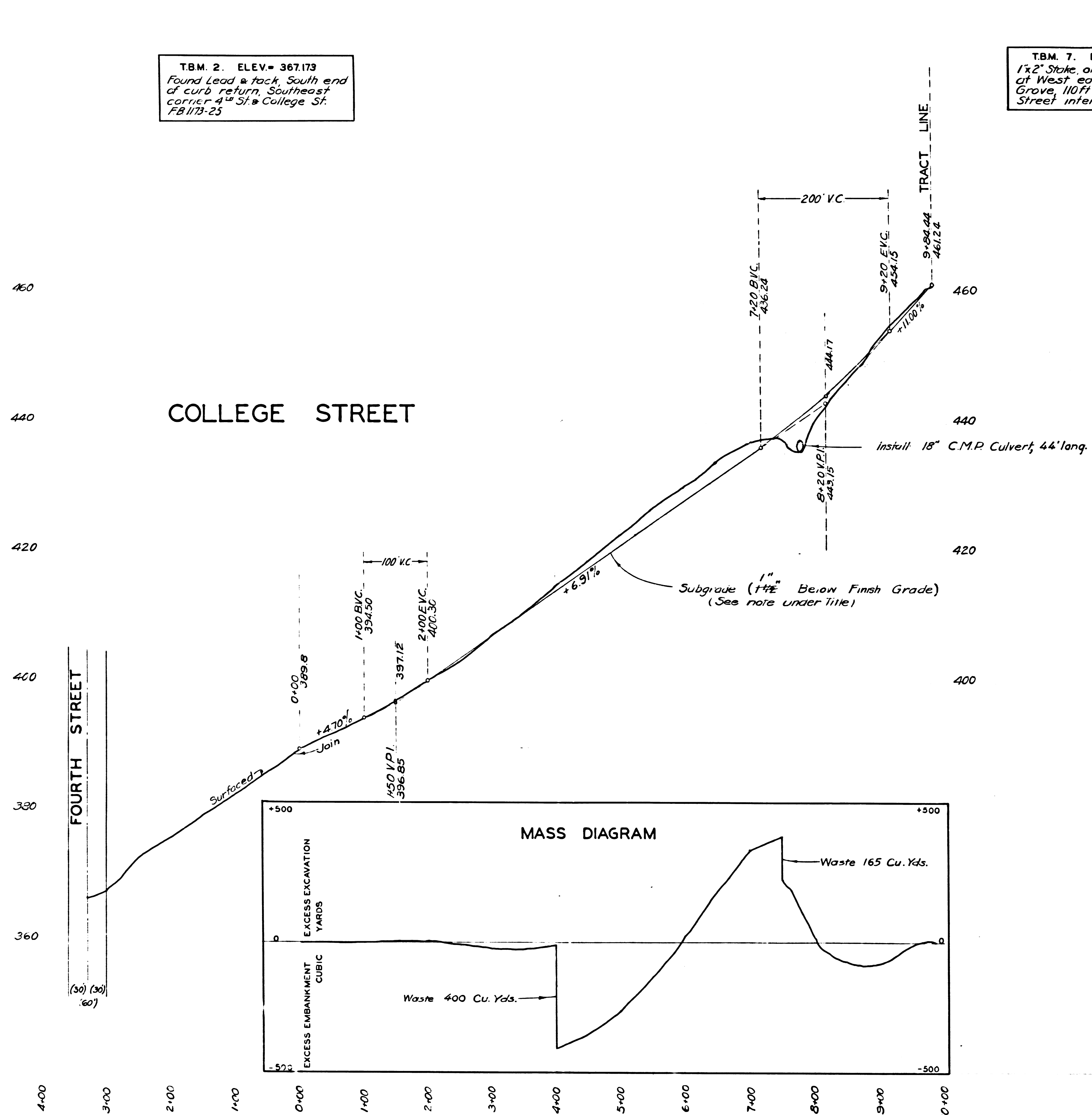

CSB 1952-1
 A1 OF A2

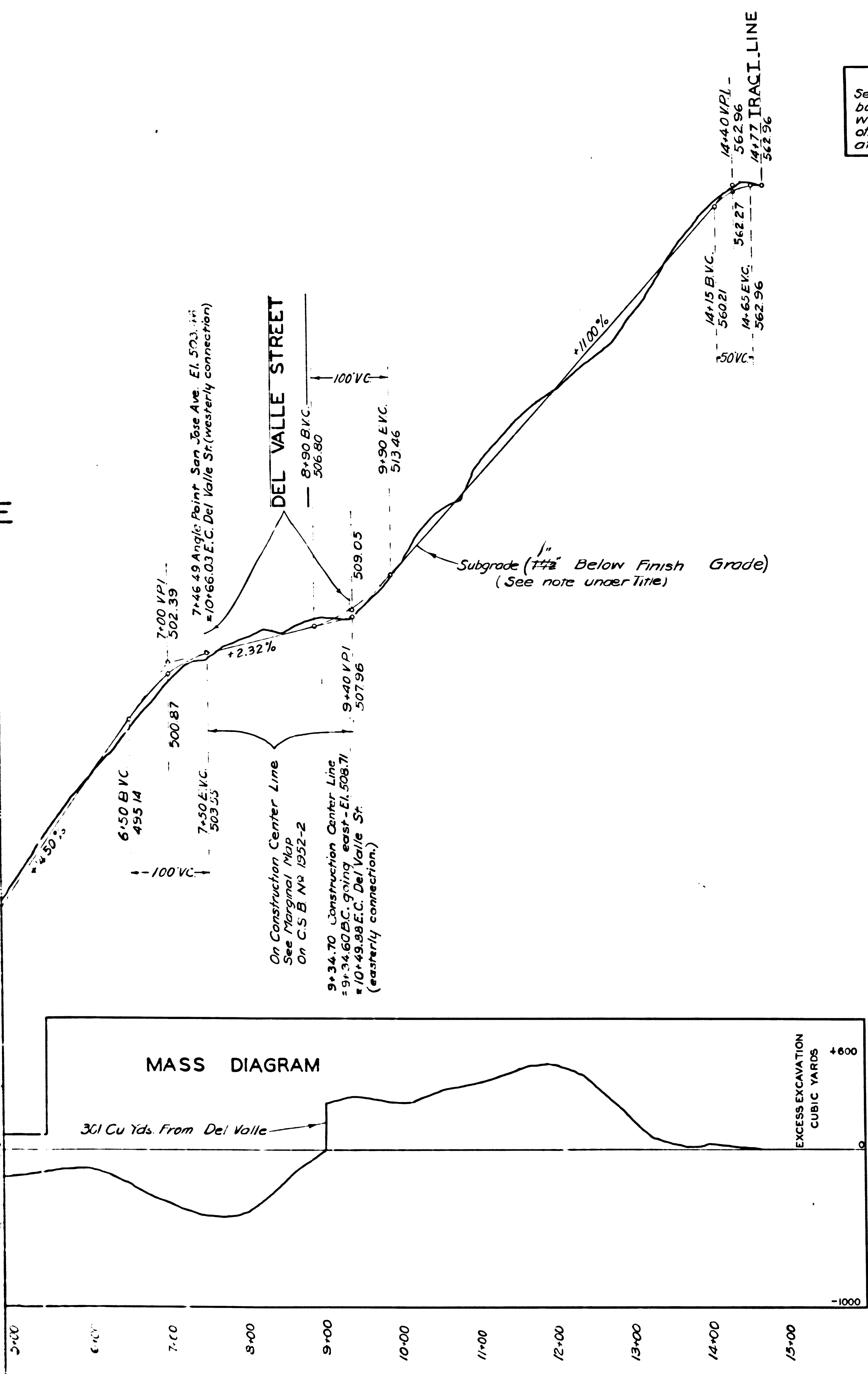

T.B.M. 6 ELEV. = 561.438
Set cut spike washer & tin in
base of Eucalyptus Tree at
west edge of Grave, 10 FT. S.
of San Jose Ave. produced
at Tract Line. FB 113-26

T.B.M. 5 ELEV. = 422.473
Found boat spike in lead, middle
of curb return, northeast corner
Hill Street & Del Valle Street
FB 117-25

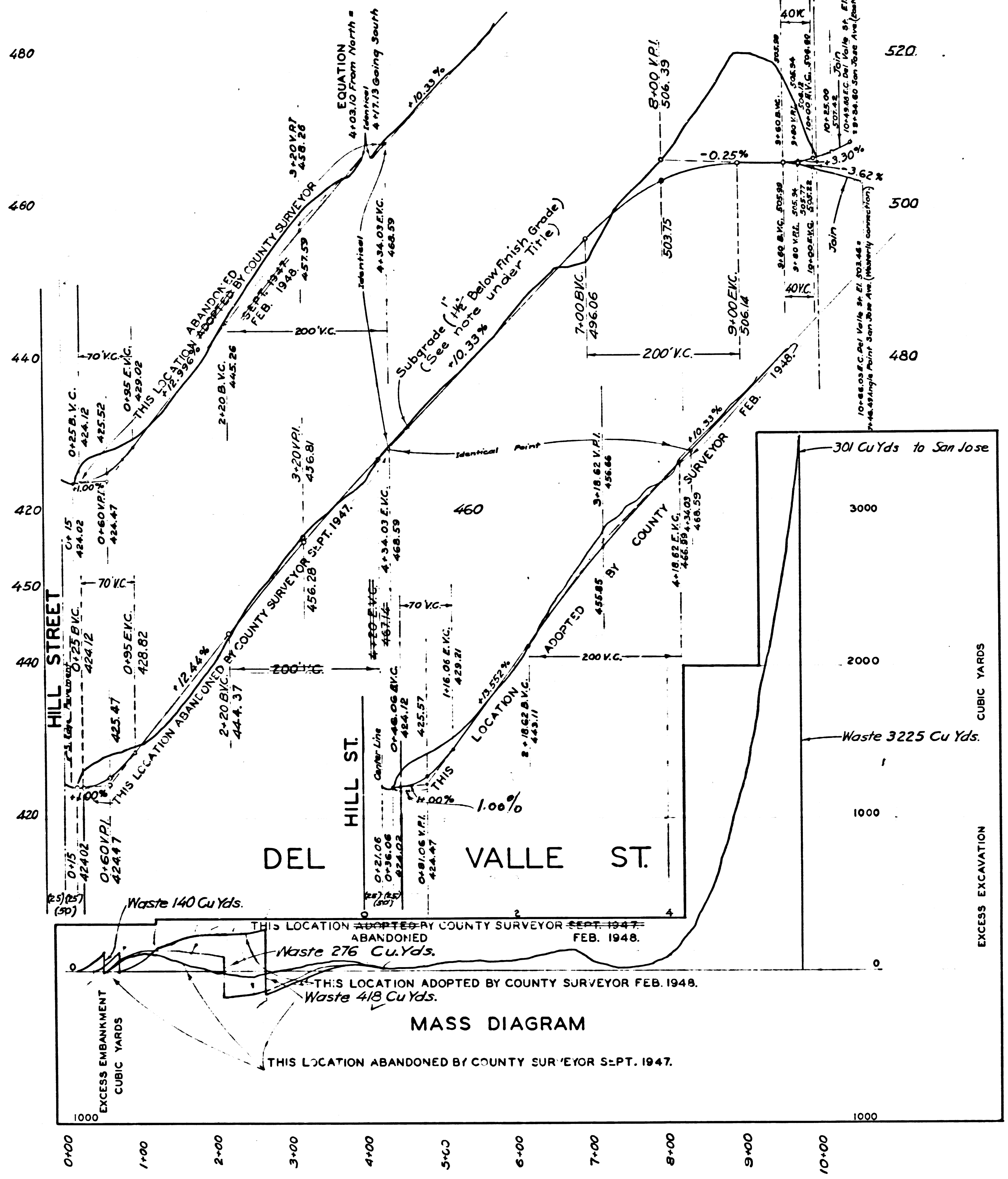

COUNTY OF LOS ANGELES

PROFILES OF
PROPOSED STREETS

IN
TRACT No 1211.

M.B. 17-171

COUNTY SURVEYORS MAP No B-1952

SHEET 1 OF 2 SHEETS
SCALES AS SHOWN

JOB NUMBER 8415

ALFRED JONES-COUNTY SURVEYOR
SURVEYED DECEMBER 1945 - APRIL 1946

FIELD WORK	OFFICE WORK	CHECKED
G.G.P.	F.B.L.C.M.	H.N.B.

FOR ALIGNMENT SEE CSB-1943
FOR CROSS SECTIONS SEE CSB-1952-2

DATUM-MEAN SEA LEVEL
ELEVATIONS SHOWN HEREON ARE BASED UPON
TBM FB 599-294 THE ELEVATION OF WHICH WAS
DETERMINED FROM USGS BM # 331 (U.S. 316)
BASED UPON THE U.S. & C.S. ADJUSTMENT OF 1928.

Note: Macadam decreased to 1 inch and
Decomposed Granite Base established as
5 inches (compressed) per letter from
Road Commissioner dated Oct. 14, 1946.
Therefore Finish Grade throughout this
job is lowered 1/2 inch.

Revised Dec 1947. H.N.B.
Revised March 1955. H.N.B.

CSB 1952-1
A2 OF A2