

E. 1400  
N. 2700

N. 2000

N. 1800

N. 1600

N. 1400

E. 1200

E. 1000

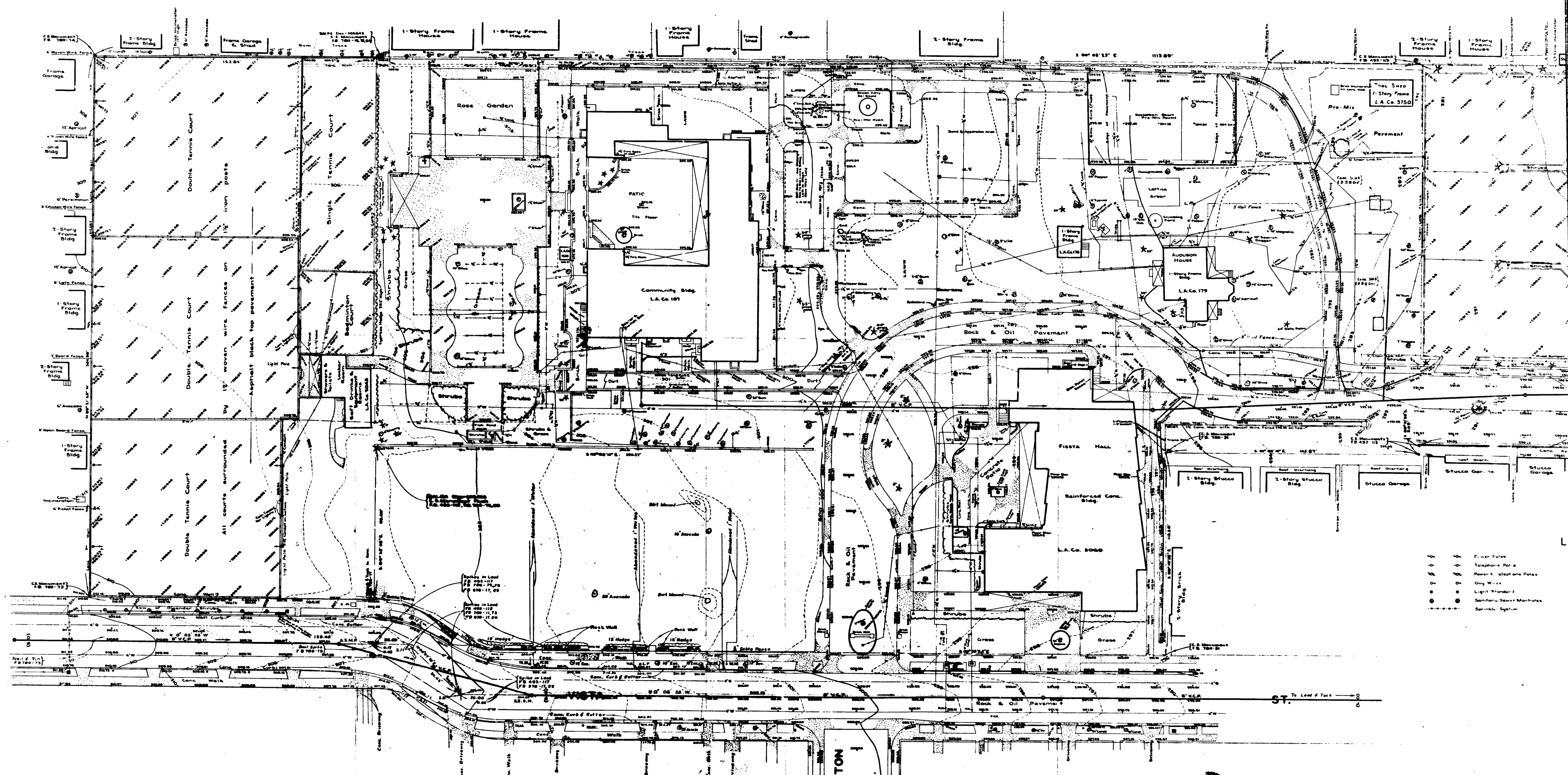

- Floor Fuses
- Telephone Poles
- Power & Telephone Poles
- Gas Works
- Light Fixtures
- Sanitary Sewer Manholes
- Sprinkler System

LEXINGTON AVE.

CSB 1999-2

A1 OF A2

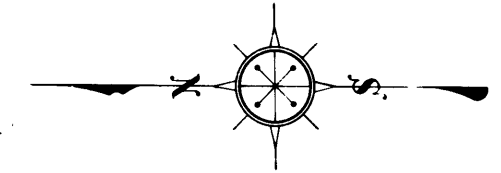
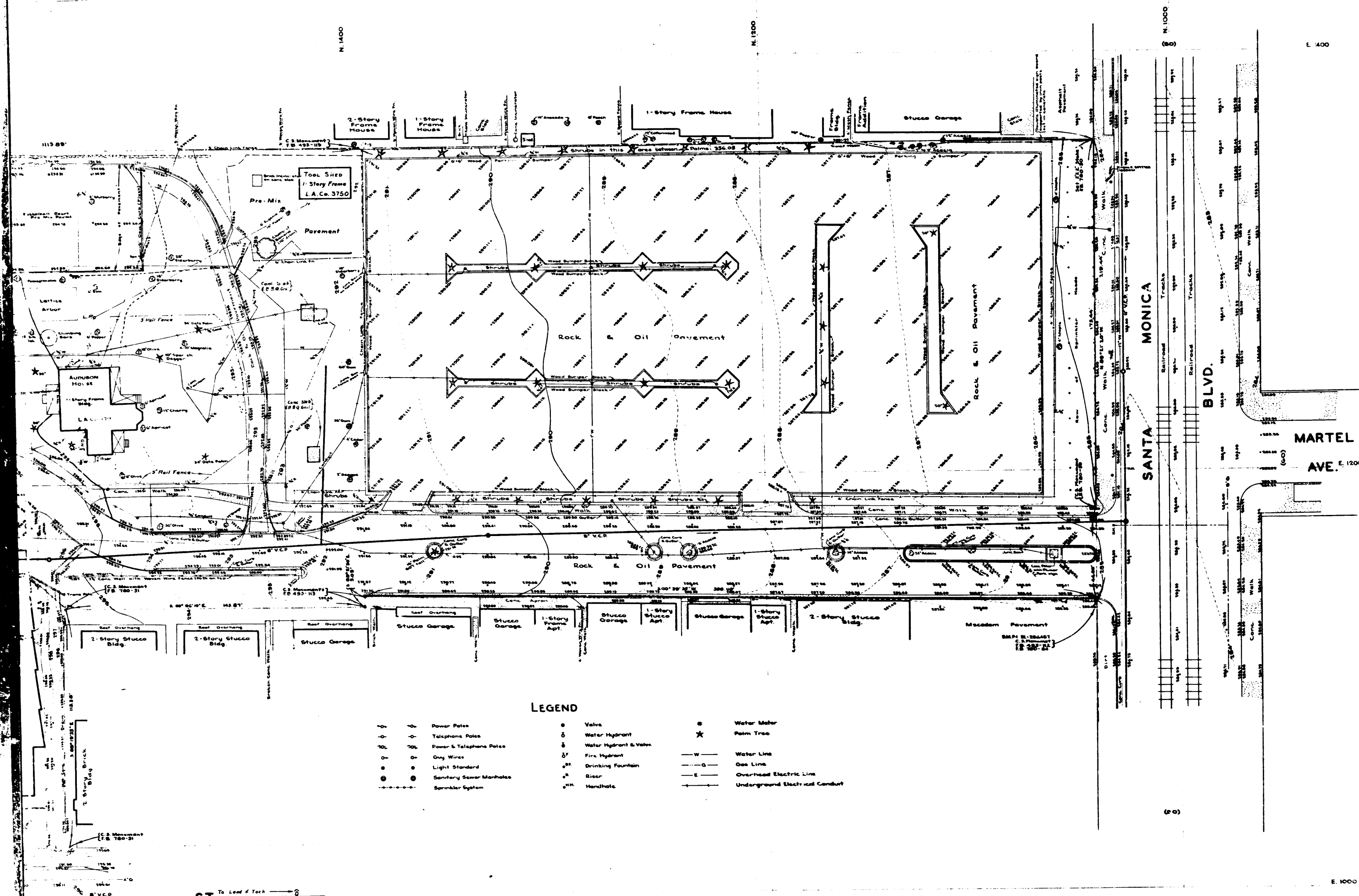

COUNTY OF LOS ANGELES  
 TOPOGRAPHIC MAP OF  
**PLUMMER PARK**  
 COUNTY SURVEYORS MAP N<sup>o</sup>B-1999  
 SHEET N<sup>o</sup> 2 OF 2 SHEETS  
 SCALE: 1 INCH=20 FEET  
 JOB NUMBER 0054.59

WILLIAM J. FOX - COUNTY SURVEYOR  
 SURVEYED JULY, 1953  
 SURVEYED ON REQUEST OF THE  
 SUPERINTENDENT OF PARKS & RECREATION  
 UNDER SEC. 19, ORD. 4099, BY LETTER  
 DATED JAN. 20, 1953  
 BEARINGS ARE BASED ON THE BEARING OF  
 SANTA MONICA BOULEVARD PER C.S.B-1311  
 PLANE TABLE SHEETS G-254, G-255,  
 AND G-442 F.B. 780  
 FIELD WORK BY..... R. C. BOWERS  
    J. P. TENNE  
    W. E. STADEN  
 OFFICE WORK BY..... Y. ITO  
 CHECKED BY..... C. F. RUGGLES

DATUM - MEAN SEA LEVEL  
 ELEVATIONS SHOWN HEREON ARE BASED UPON B. M. 5-1  
 (F.B. 633-16) THE ELEVATION OF WHICH WAS DETERMINED  
 FROM THE U.S.C. & G.S. B.M. 5-169 (U.S. 2913) BASED  
 UPON THE U.S.C. & G.S. ADJUSTMENT OF 1934.

THIS MAP FILED JANUARY, 1956  
 JOHN A. LAMBIE - COUNTY ENGINEER

FOR BOUNDARY SURVEY SEE C.S.B-1311  
 FOR OLD TOPOGRAPHY SEE C.S.B-1999-1

I.M. N<sup>o</sup> 22  
 TOPOGRAPHY REVISED BY: E. W. MILLER 7-7-58  
 Topography Revised by: J. C. Miller 12-1-62  
 Topography Revised by: H. H. Humberg 6-28-62

CSB 1999-2  
 A2 OF A2

**LEGEND**

○	Power Pole	○	Valve	○	Water Meter
○	Telephone Pole	○	Water Hydrant	★	Palm Tree
○	Power & Telephone Pole	○	Water Hydrant & Valve	—	Water Line
○	Gas Wire	○	Fire Hydrant	—	Gas Line
○	Light Standard	○	Drinking Fountain	—	Overhead Electric Line
○	Sanitary Sewer Manholes	○	Riser	—	Underground Electric and Conduit
○	Sprinkler System	○	Handhole		

ST. To Lead of Text