

COUNTY OF LOS ANGELES
 TOPOGRAPHIC MAP OF
REDONDO COUNTY BEACH
 AND
CLIFTON BEACH
 FROM
 KNOB HILL AVENUE
 TO
 CITY LIMITS OF PALOS VERDES ESTATES

COUNTY SURVEYORS MAP NO B-2070
 SHEET NO 2 OF 2 SHEETS
 SCALE 1 INCH = 50 FT.

INDEX 27

JOB NUMBER 7961
C. E. ARNOLD - COUNTY SURVEYOR
 SURVEYED NOV. 1947 - JAN. 1948
 SURVEYED ON REQUEST OF THE CHIEF
 MECHANICAL ENGINEER AND DIRECTOR,
 DEPT. OF PARKS AND RECREATION, UNDER
 SEC. 79, ORD. 4099, BY LETTERS DATED
 RESPECTIVELY SEPT. 12 AND SEPT. 29, 1947.
 BEARINGS ARE BASED ON THE CALIFORNIA
 COORDINATE SYSTEM, ZONE 7, PER CHAPTER
 1307, STATUTES 1947 - SEE C. S. 9423.
 PLANE TABLE SHEETS G-259, G-260,
 F. B. 836-40-47, H2, F. B. 825-09, 90.
 FIELD WORK BY..... R. C. BOWERS
 OFFICE WORK BY..... C. J. GALLI
 M. N. BRADSTREET
 CHECKED BY..... L. DETILLA

DATUM - MEAN SEA LEVEL
 ELEVATIONS SHOWN HEREON ARE BASED UPON B.M. R.P. 2-3-27
 (F.B. 1184-19) THE ELEVATION OF WHICH IS BASED ON MEAN
 LOWER LOW WATER DATUM, DETERMINED BY ADDING 2.80 FT. TO
 U.S.C. & G.S. 1938 ADJUSTMENT OF "CITY OF REDONDO" B.M. 48-48
 (U.S. 104) B.M. R.P. 2-3-27 HAS BEEN CORRECTED TO MEAN
 SEA LEVEL BY SUBTRACTING 2.80 FT. PER U.S.C. & G.S.
 TIDAL BULLETIN T-301, 1942.

NOTE: FOR BOUNDARY SURVEY SEE C.S.B.-2126

NOTE: FOR LATER TOPOGRAPHIC SURVEY
 SEE SURVEY DIVISION MAP NO PE-60-1
 - PT. 81

CSB-2070-2
 A1 OF A2

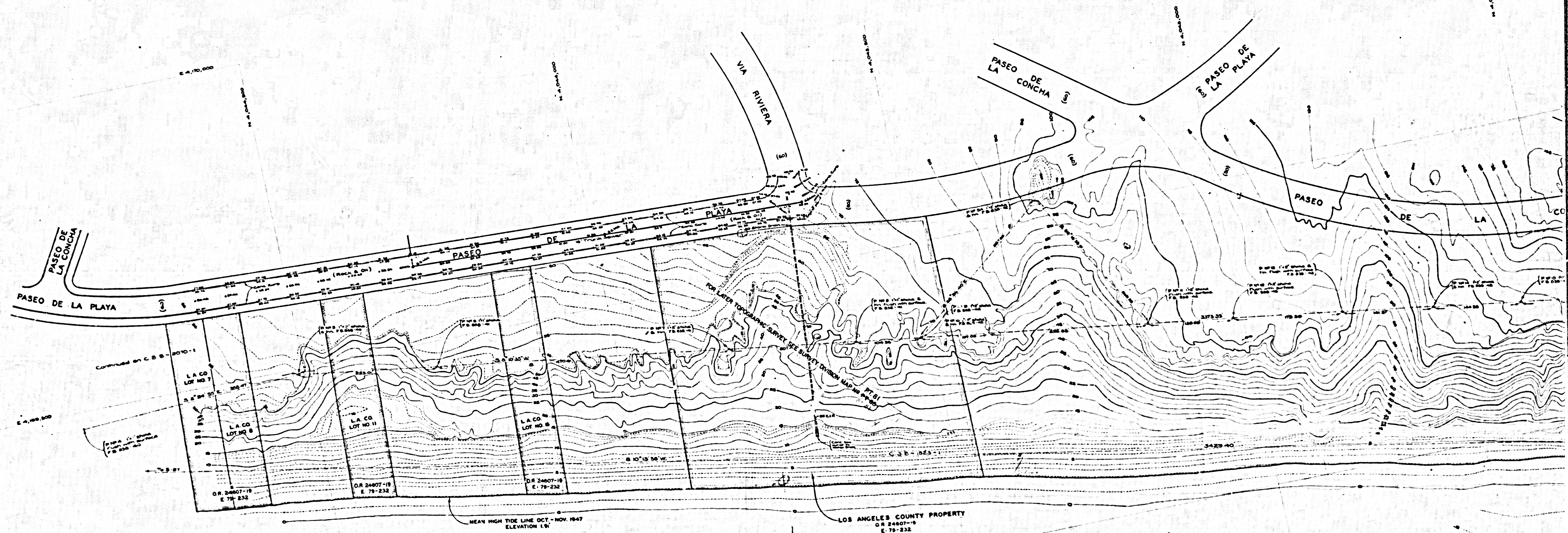

CSB-2070-2
A2 OF A2