

COUNTY OF LOS ANGELES  
 MAP OF  
**WHITTIER CIVIC CENTER**  
 BEING  
 LOTS 13, 14, 23, 24 AND THE NORTHERLY  
 30 FEET OF LOT 15 OF BLOCK 14 OF  
 STRAWBRIDGE AND WIGGINS ADDITION  
 TO WHITTIER ~ M. R. 26-79

COUNTY SURVEYORS MAP NO B-2213  
 SCALE: 1 INCH = 50 FT.

JOB NUMBER 8568

C. E. ARNOLD - COUNTY SURVEYOR  
 SURVEYED - OCT. 1949

SURVEYED ON REQUEST OF THE CHIEF  
 MECHANICAL ENGINEER UNDER SEC. 79,  
 ORD. 4099, BY LETTER DATED AUG. 22, 1949

BEARINGS ARE BASED ON THE BEARING OF  
 GREENLEAF AVE. AS SHOWN ON L. LANDRETH'S  
 ADDITION TO WHITTIER ~ M. B. 4-82

F. B. 1583-5-15

FIELD WORK BY . . . . . D. E. HOLMES Index 37  
 OFFICE WORK BY . . . . . C. W. COX  
 CHECKED BY . . . . . K. R. McPHERSON

CSB-2213  
 A10FA2

CONV. PLAN PROVISIONS YTHUCU

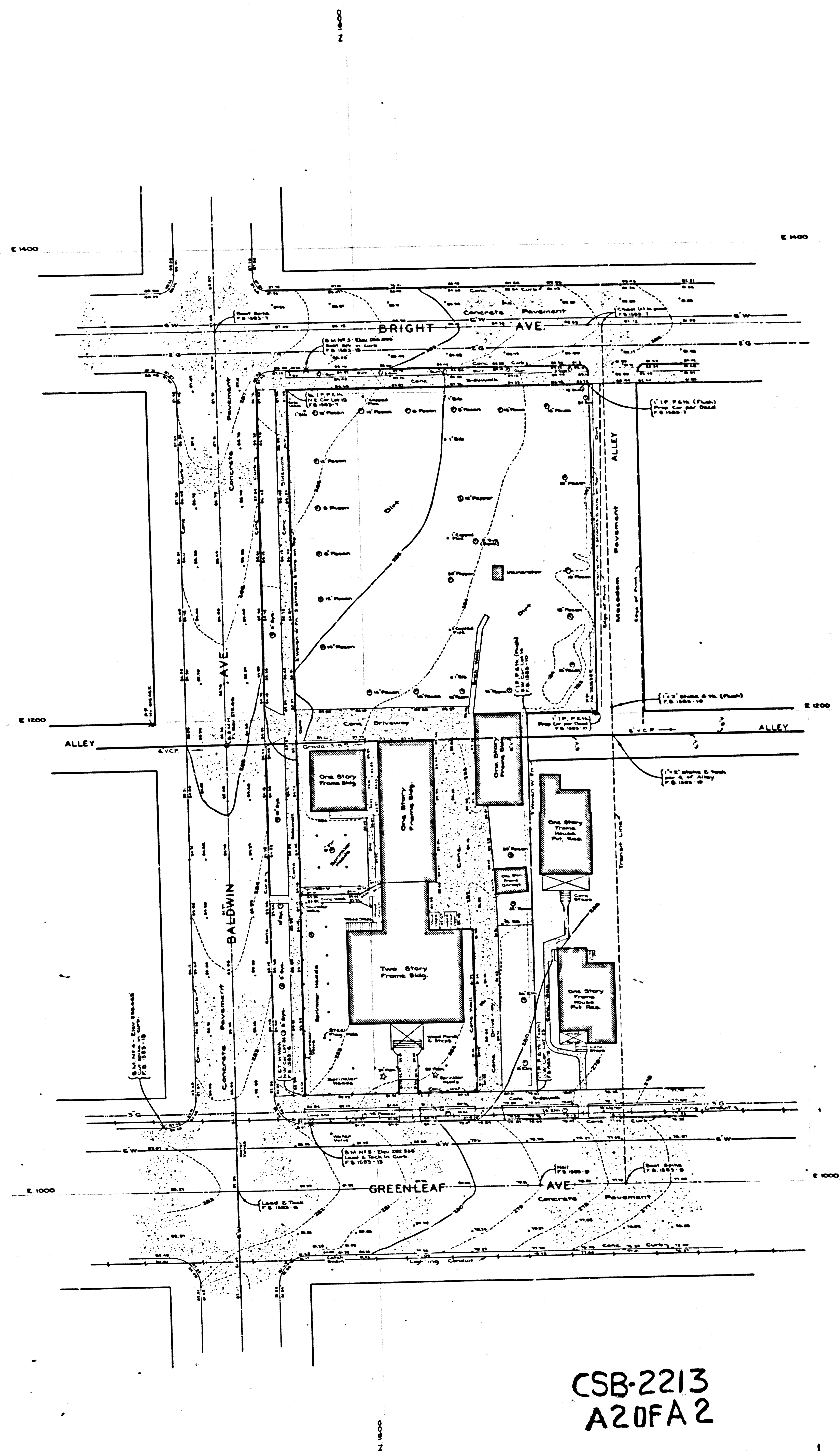

CONV. PLAN PROVISIONS YTHUCU

CSB-2213  
A20FA2

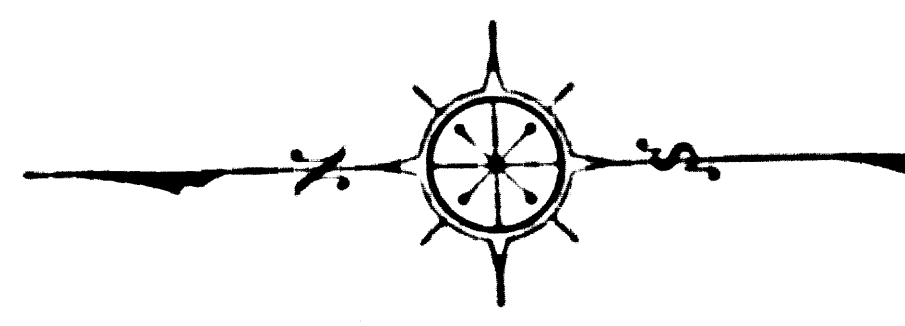

MARGINAL MAP  
SHOWING  
TOPOGRAPHY  
SCALE: 1 INCH = 20 FT.  
FIELD WORK BY..... L. L. BROWN  
OFFICE WORK BY..... C. J. GALLI  
CHECKED BY..... Y. ITO  
PLANE TABLE SHEET E-337

DATUM - MEAN SEA LEVEL  
ELEVATIONS SHOWN HEREON ARE BASED ON  
C. S. M. 1928 L. & G. 752-90. THE ELEVATION  
OF WHICH WAS DETERMINED FROM U.S.G.S.  
BM AT COLIMA RD. & MULBERRY ST (U.S. 243)  
BASED UPON THE 1928 U.S.C. & G.S. ADJUSTMENT

