

GRAPHY SEE
AP NO. P.T. 190

TOPOGRAPHY SEE
FOR LATER FILE MAP NO. P.T. 190
SURVEY DIV. MAY 1959

FOR TOPOGRAPHY OF THIS
AREA - SEE C.S.B. 2200-PT. 190

CSB-2261
A1 of A2

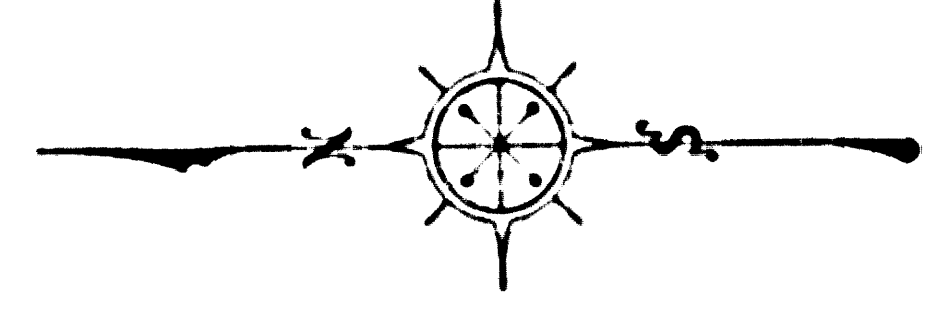

COUNTY OF LOS ANGELES
TOPOGRAPHIC MAP OF A PORTION OF
EATON CANYON PARK
BEING
A PORTION OF LOT 1 OF LANDS OF
A.B. CHAPMAN, C.F. 602, R.F. 561
AND A PORTION OF RANCHO SANTA
ANITA P. 1-97-98.

COUNTY SURVEYORS MAP N°B-2261
SCALE: 1 INCH = 50 FT.

JOB NUMBER 8596
C.E. ARNOLD - COUNTY SURVEYOR
SURVEYED JUNE 1950

SURVEYED ON REQUEST OF THE ACTING
DIRECTOR OF PARKS AND RECREATION
UNDER SEC. 73, ORD. 4099, BY LETTER
DATED APRIL 7, 1950.

BEARINGS ARE BASED ON THE BEARING
OF SIERRA MADRE VILLA AVE. AS SHOWN
ON C.S.B. 541-2.

PLANE TABLE SHEETS D-304 & D-307
P.B. 1144, P.B. 1238.

FIELD WORK BY ... D.S. WALTERMIRE
W.E. BRADEN
OFFICE WORK BY ... C.J. GALLI
CHECKED BY ... R.E. SHYDER
W.A. EDMONDSON

DATUM - MEAN SEA LEVEL
ELEVATIONS SHOWN HEREON ARE BASED ON B.M.
"SIERRA MADRE D.S." F.B. 1400-247, THE ELEVATION
OF WHICH WAS DETERMINED FROM METROPOLITAN
DIST. B.M.'S "53P, 53Q, 53R, 53T" BASED ON THE
U.S.C.G.S. PRELIMINARY ADJUSTMENT OF 1928

FOR BOUNDARY SURVEY - SEE C.S.B. 2208

THIS MAP FILED ... DECEMBER, 1951

WILLIAM J. FOX COUNTY SURVEYOR

PROPERTY FILE NO. 1946 - 194
REVISED PLAN NO. 1945 - 1947
REVISED PLAN NO. 22 - 1948

COPYRIGHT 1951 BY WILLIAM J. FOX

COUNTY SURVEYORS MAP NO. B-2261

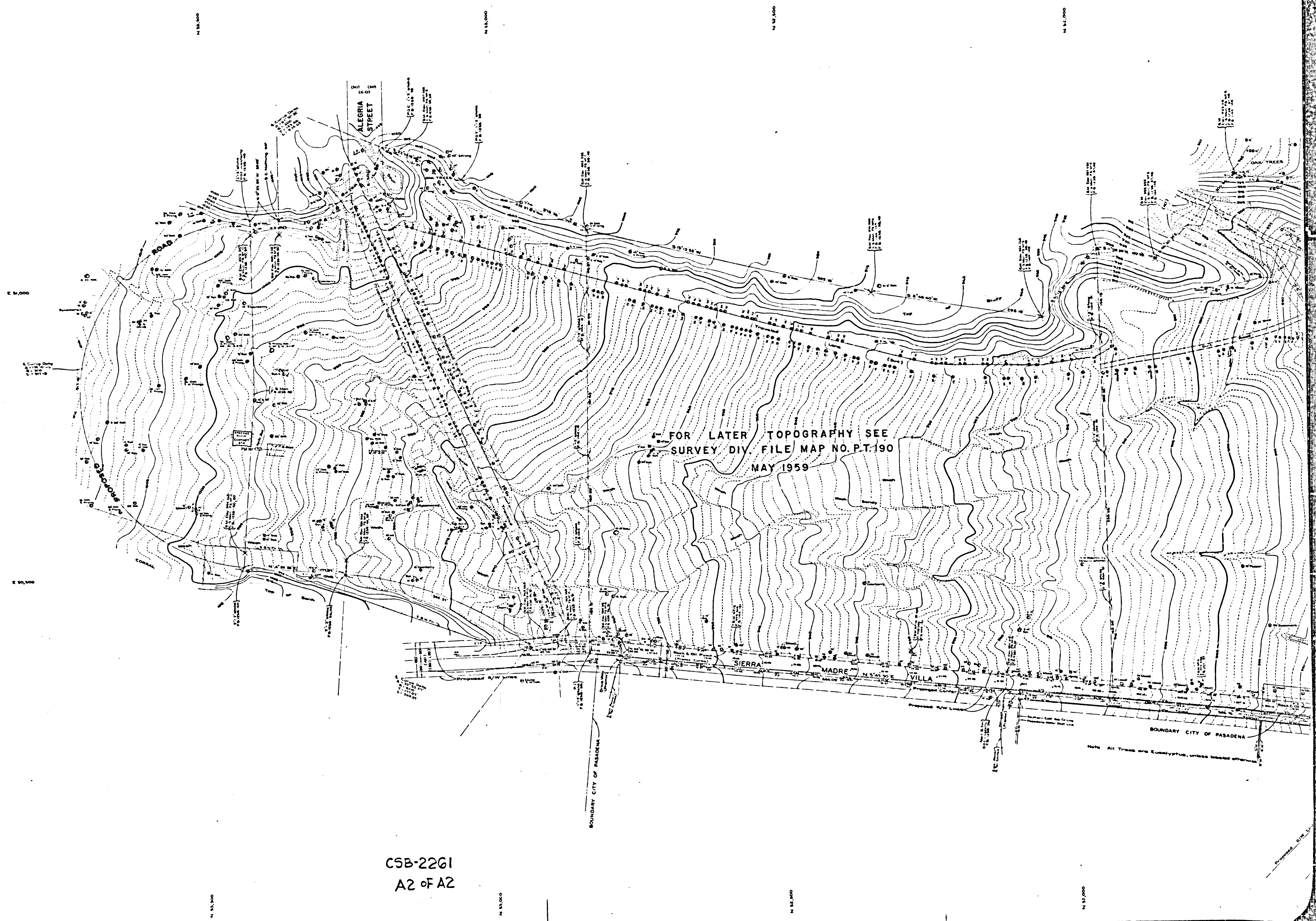

CSB-2261
A2 of A2