

CSB-2921-1  
A1 OF A2

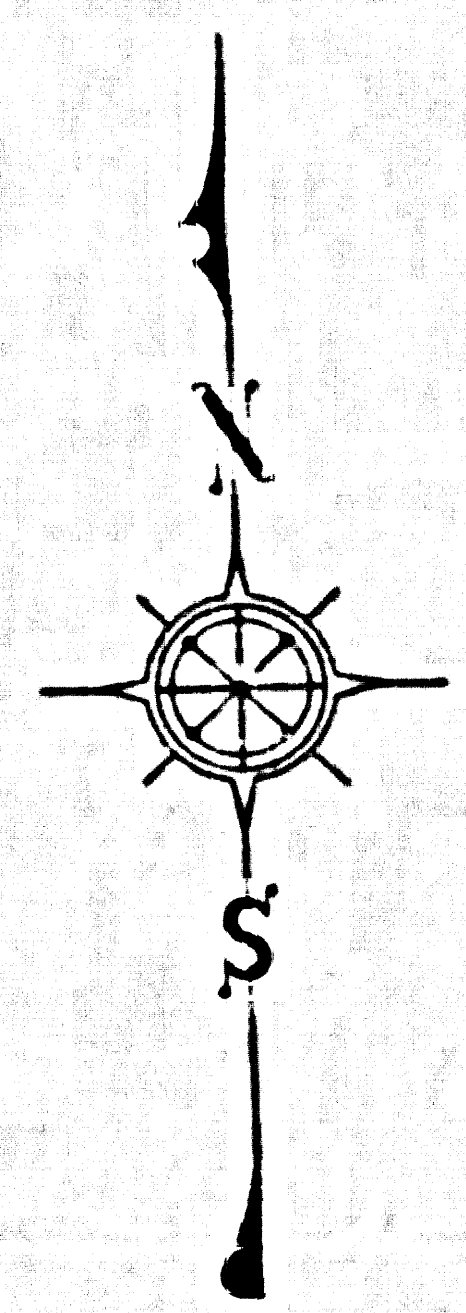

COUNTY OF LOS ANGELES  
MAP OF  
**SEPULVEDA BLVD.**  
FROM  
SANTA FE AVE  
TO  
ALAMEDA STREET  
COUNTY SURVEYORS MAP NO. B-2921  
SHEET NO. 1 OF 3 SHEETS  
SCALE: 1 INCH = 100 FT.

JOB NUMBER 0096.51  
JOHN A. LAMBIE - COUNTY ENGINEER  
SURVEYED JUNE - JULY 1966  
SURVEYED ON REQUEST OF THE REGIONAL  
PLANNING COMMISSION UNDER SEC. 79,  
ORD. 4099, BY LETTER DATED DEC. 11, 1964  
AND BY BOARD ORDER DATED DEC. 11, 1951  
BEARINGS ARE BASED ON THE CALIFORNIA  
COORDINATE SYSTEM ZONE 7 PER SEC. 8809  
PUBLIC RESOURCES CODE. SEE C.S. 9423.  
F.B. 3144 - 41 - 72  
FIELD WORK BY.....E.T. MANKEY, JR.  
OFFICE WORK BY.....R.S. DOWNS  
CHECKED BY.....J.J. EDWARDS  
BY.....A.E. DART

JOHN A. LAMBIE  
COUNTY ENGINEER  
FIELD: *John Lambie*  
DEPUTY: *John Lambie*

THE ALIGNMENT OF SEPULVEDA BLVD FROM TERMINAL ISLAND FREEWAY  
TO A POINT 860' S.W. 1/4 THEREOF REVISED OCT. 18, 1967, IN A  
268 1 E.C. MINUTES DATED MARCH 9, 1967

TRACT

MARIA

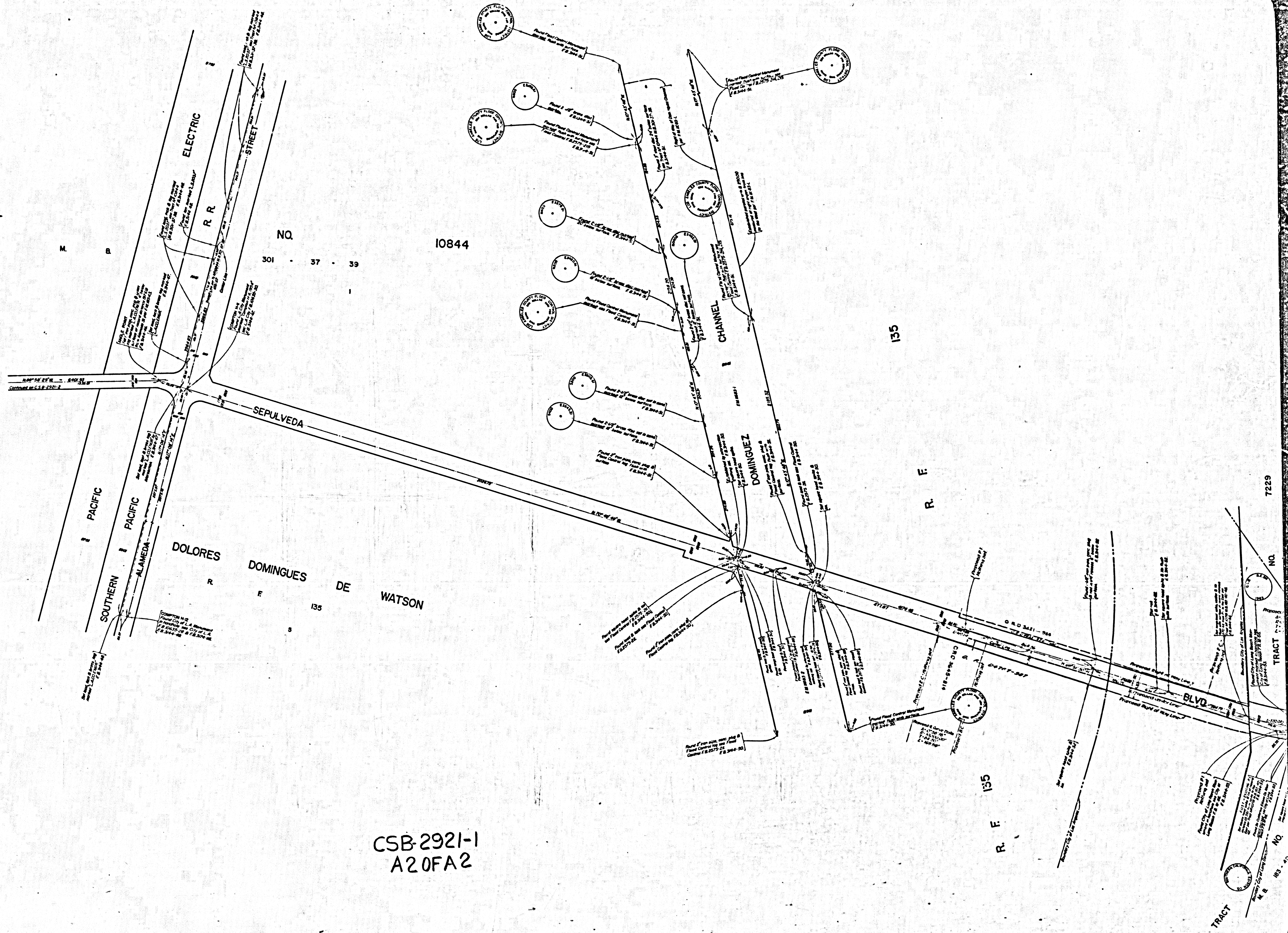

NO. 10844  
301 - 37 - 39

135

R. F.

7229

NO.

TRACT

NO.

TRACT

NO.

TRACT

NO.

TRACT

CSB-2921-1  
A20FA2

R. F. 135

TRACT