

Found 2" iron pipe, wood plug & nail of above surface. See Tract No. 5448, M.B. 56-78, L.A. County Rd. Dept. F.B. 2229-157, F.B. 2229-158.

Set large boat spike, washer & nut by proportion between found 2" iron pipe to the North and Elizabeth Lake Road per Tract No. 5448, M.B. 56-78, F.B. 2229-159.

Set 1x2 stake & nail flush with surface, NW corner Lot 3, Tract No. 5448, M.B. 56-78, F.B. 2229-159.

Set nail, F.B. 2229-153

Found lead & tack in concrete 4" below surface, F.B. 124-20, F.B. 2229-153

Set nail, F.B. 2229-153

Found wire stake & tin 4" above surface same in the West, County Engineer's Office, L.A. County, F.B. 2229-153.

Found stake per L.A. County Rd. Dept. F.B. 2229-153

Found 2 x 2 stake, 2 above surface, NW corner Lot 3, F.B. 2229-153

NOTE: The alignment of the Major Highway proposed in the Master-Plan of the ways not established March 1966.

Found 2" iron pipe with wood plug, NW corner Lot 4, Tract No. 5448, M.B. 56-78, F.B. 2229-155.

SE CORNER LOT 5 Found 2" iron pipe 616 Southern, brass tag marked: L.A. Co. Eng. flush with surface at SE corner Lot 5 per Tract No. 5448, M.B. 56-78, F.B. 2229-155.

Found 2" iron pipe, wood plug & nail, SW corner Lot 4, Tract No. 5448, M.B. 56-78, F.B. 2229-155.

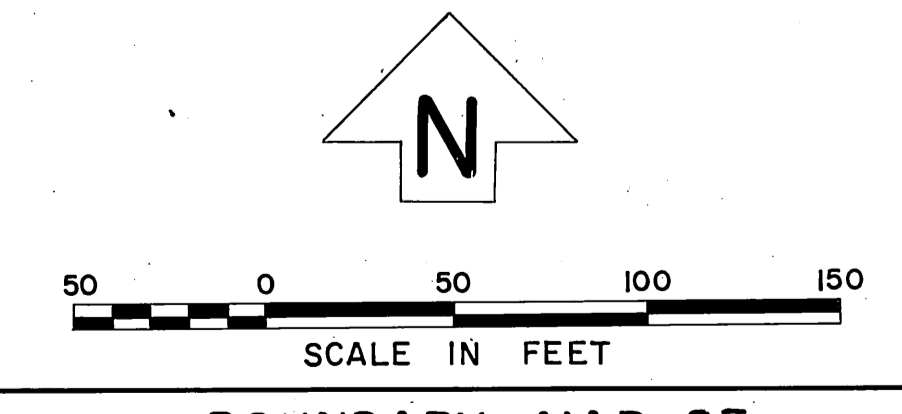
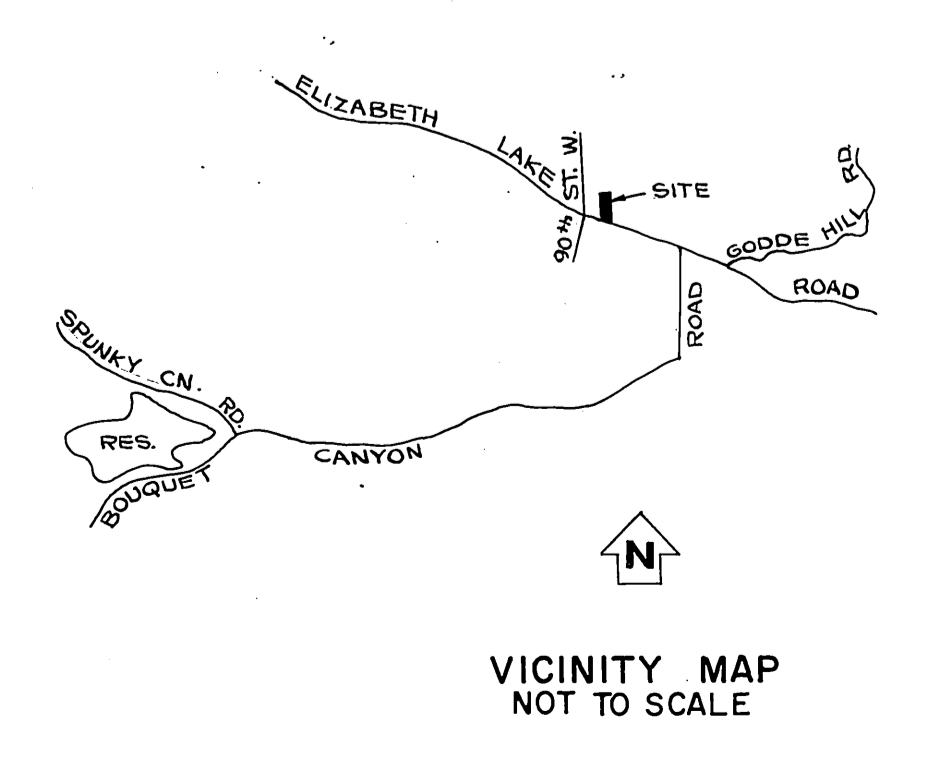

COUNTY OF LOS ANGELES DEPARTMENT OF COUNTY ENGINEER JOHN A. LAMBIE - COUNTY ENGINEER PREPARED BY SURVEY DIVISION C. E. BRUNY - DIVISION ENGINEER SURVEYED BY <u>W. C. PIERCE</u> CHECKED BY <u>J. A. CHURCH</u> DRAWN BY <u>R. R. SHEAN</u>	BOUNDARY MAP OF FIRE STATION SITE NO. 140 LEONA VALLEY		COUNTY SURVEYOR'S MAP NO. B-5002 SHEET 1 OF 1 SHEET FILED <u>1968</u> <u>Stemp</u> SURVEYED DECEMBER 1967 REFERENCE F. B. 2229-151-148 JOB NUMBER J. N. 0802.65	REVISION NO. BY DATE
	BASIS OF BEARINGS BEARINGS ARE BASED ON THE BEARING OF ELIZABETH LAKE ROAD PER C.S.B-1352-2			
	SCALE IN FEET 0 50 100 150			
	VICINITY MAP NOT TO SCALE			