

SECTION 30
T. 5 N., R. 16 W.

SECTION 25
T. 5 N., R. 17 W.

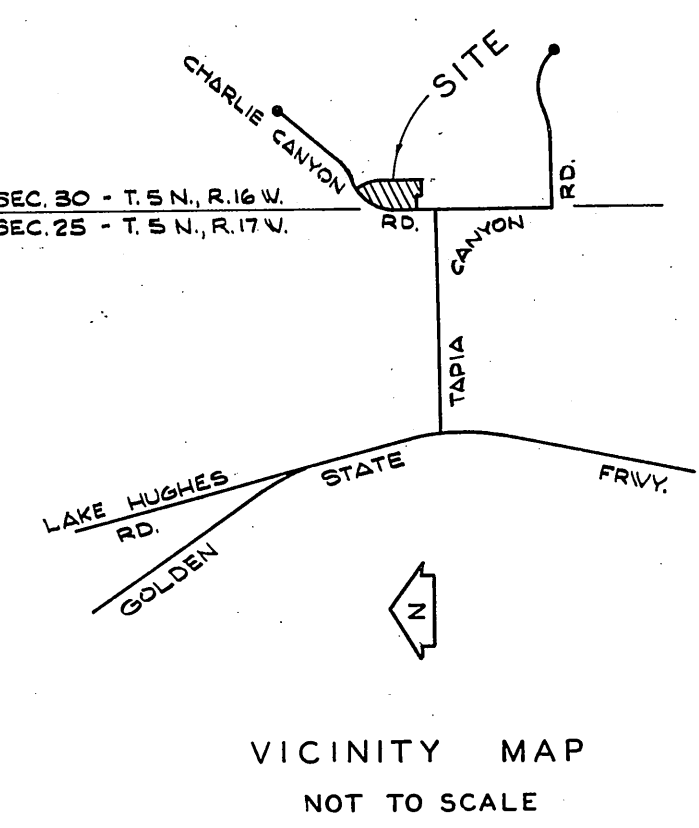

COUNTY OF LOS ANGELES DEPARTMENT OF COUNTY ENGINEER JOHN A. LAMBIE - COUNTY ENGINEER PREPARED BY SURVEY DIVISION C. E. BRUNY - DIVISION ENGINEER SURVEYED BY - J. P. MENNER CHECKED BY - J. M. CAVATAIO DRAWN BY - T. ABE	BOUNDARY MAP OF ANIMAL CONTROL CENTER NO. 6 CASTAIC AREA FOR TOPOGRAPHY SEE SURVEY DIVISION FILE MAP NO. P.T. 400-2		COUNTY SURVEYOR'S MAP NO. B-5062 SHEET 1 OF 1 SHEET FILED: 7-30-1969 SURVEYED APRIL & MAY 1969 REFERENCE F. B. 1533 - 85 - 100		REVISION NO. BY DATE	
	BASIS OF BEARINGS OF THE WEST LINE OF SECTION 30, T. 5 N., R. 16 W. (N 0° 32' 45" W) AS SHOWN ON TRACT NO. 14955, M. B. 354 - 39 - 46		JOB NUMBER 0056.06		INDEX MAP NO. 77	