

Found County Surveyor Monument marked, 12" below surface. See F.B. 973-213, F.B. 3259-18.

Found County Surveyor Monument marked, in handhole. See F.B. 594-134 & F.B. 2678-9, F.B. 3259-8.

Set large boat spike, washer & tin flush with surface. F.B. 3259-18 & 32.

Found County Surveyor Monument marked, 6" below surface. See F.B. 973-213, F.B. 3259-18 & 32.

Proposed P.I. Set 2" iron pipe, conc. plug, tack & brass tag marked, L.A.C.O. ENGR. 12" below surface. F.B. 3259-32.

Proposed E.C. Set 1" iron pipe, conc. plug, tack & brass tag marked, L.A.C.O. ENGR. 12" below surface. F.B. 3259-33 & 37.

Proposed P.I. Set 2" iron pipe, conc. plug, tack & brass tag marked, L.A.C.O. ENGR. 12" below surface. F.B. 3259-37.

Proposed P.I. Set 2" iron pipe, conc. plug, tack & brass tag marked, L.A.C.O. ENGR. 12" below surface. F.B. 3259-38.

F.C.C. - Set large boat spike washer & tin flush with surface. F.B. 3259-34 & 35.

Found County Surveyor Monument marked, in handhole. See F.B. 594-135 & F.B. 2678-9, F.B. 3259-8, 20 & 34.

Set large boat spike, washer & tin flush with surface. F.B. 3259-8, 20 & 34.

REVISION:
 ① Proposed Right of Way Line for Valley Street revised per C.S.B-5152-1.

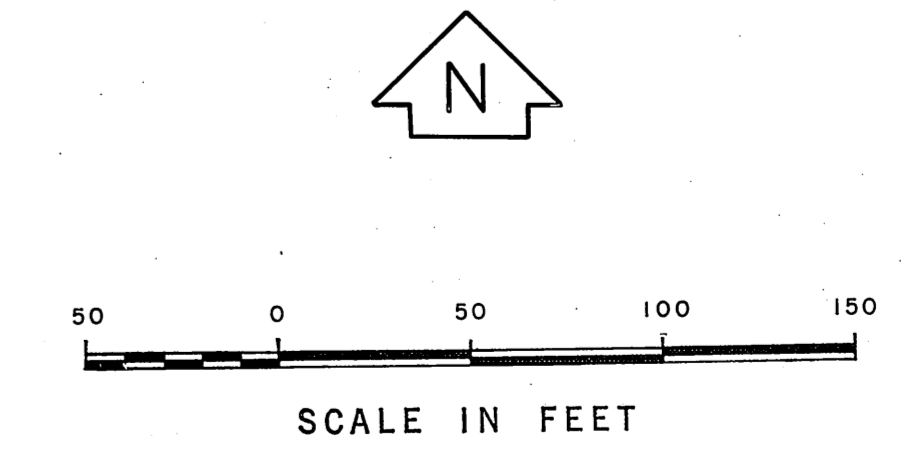
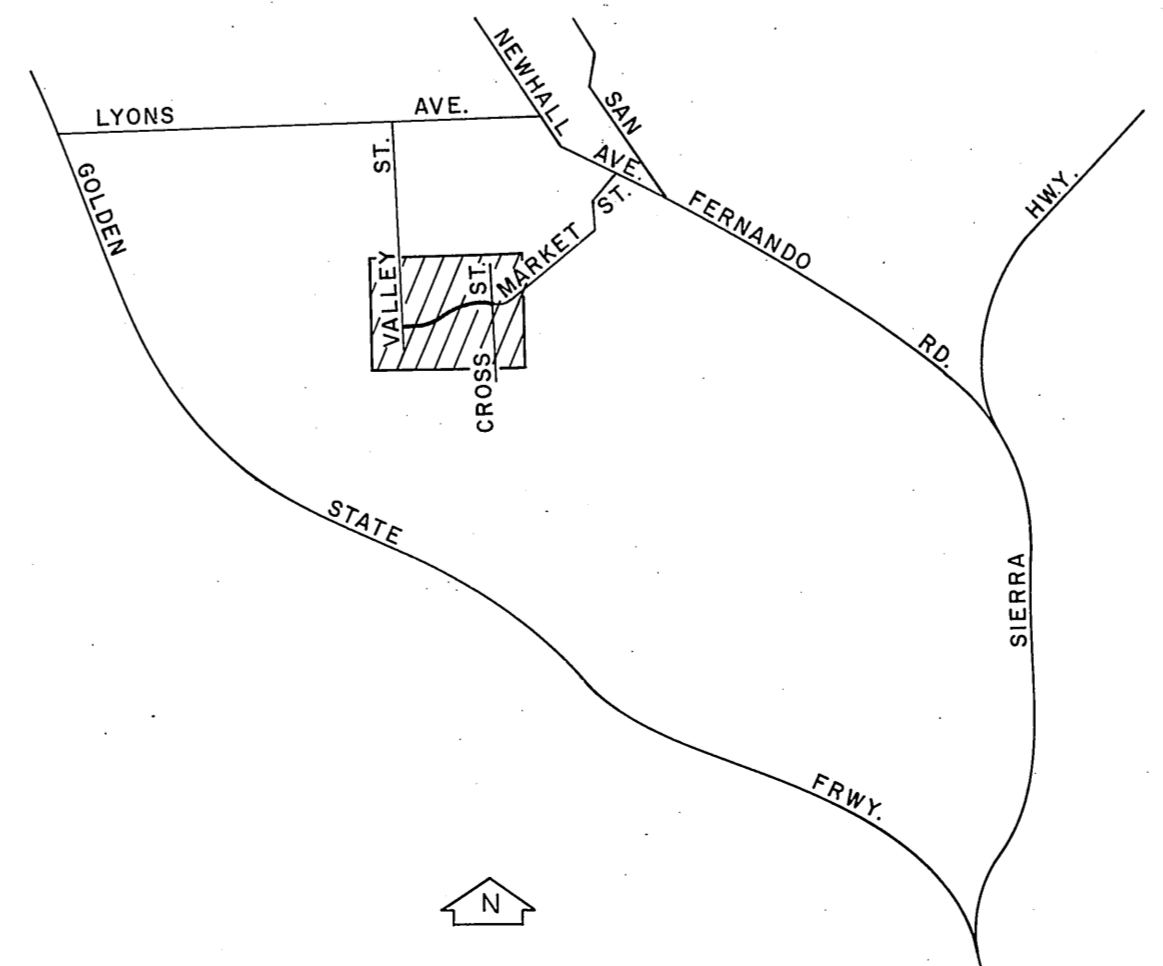

COUNTY OF LOS ANGELES DEPARTMENT OF COUNTY ENGINEER JOHN A. LAMBIE - COUNTY ENGINEER PREPARED BY SURVEY DIVISION I. H. ALEXANDER - DIVISION ENGINEER SURVEYED BY <u>C. WRIGHT</u> CHECKED BY <u>D. SAPPPELL</u> DRAWN BY <u>S. BRIONES</u>	ALIGNMENT MAP OF MARKET STREET FROM CROSS STREET TO VALLEY STREET		COUNTY SURVEYOR'S MAP NO. B-5107 SHEET 1 OF 1 SHEET FILED: <u>July 23, 19 20</u> <u>Joe A. Oberlander</u> COUNTY SURVEYOR SEPT. 1965 & NOV. 1969 REFERENCE F.B. 3259-8-38 JOB NUMBER 0095.12 INDEX MAP NO. 234-117	REVISION NO. BY DATE ① B.H.T. 10-14-71
	BASIS OF BEARINGS THE BEARING OF CROSS STREET (N.4°30'45"W.) AS SHOWN ON C.S.B-1609.			