

FOR SUBDIVISION OF SECTION  
SEE MARGINAL MAP AT LEFT

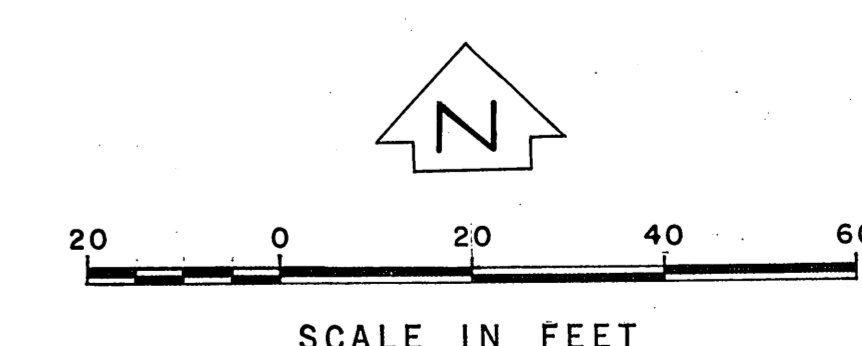

CLOSING CORNER  
Found a County Surveyor's  
Monument marked: flush  
with surface. See F.B. 246-  
108, 113 & C.S.B-126-1  
F.B.3444-29

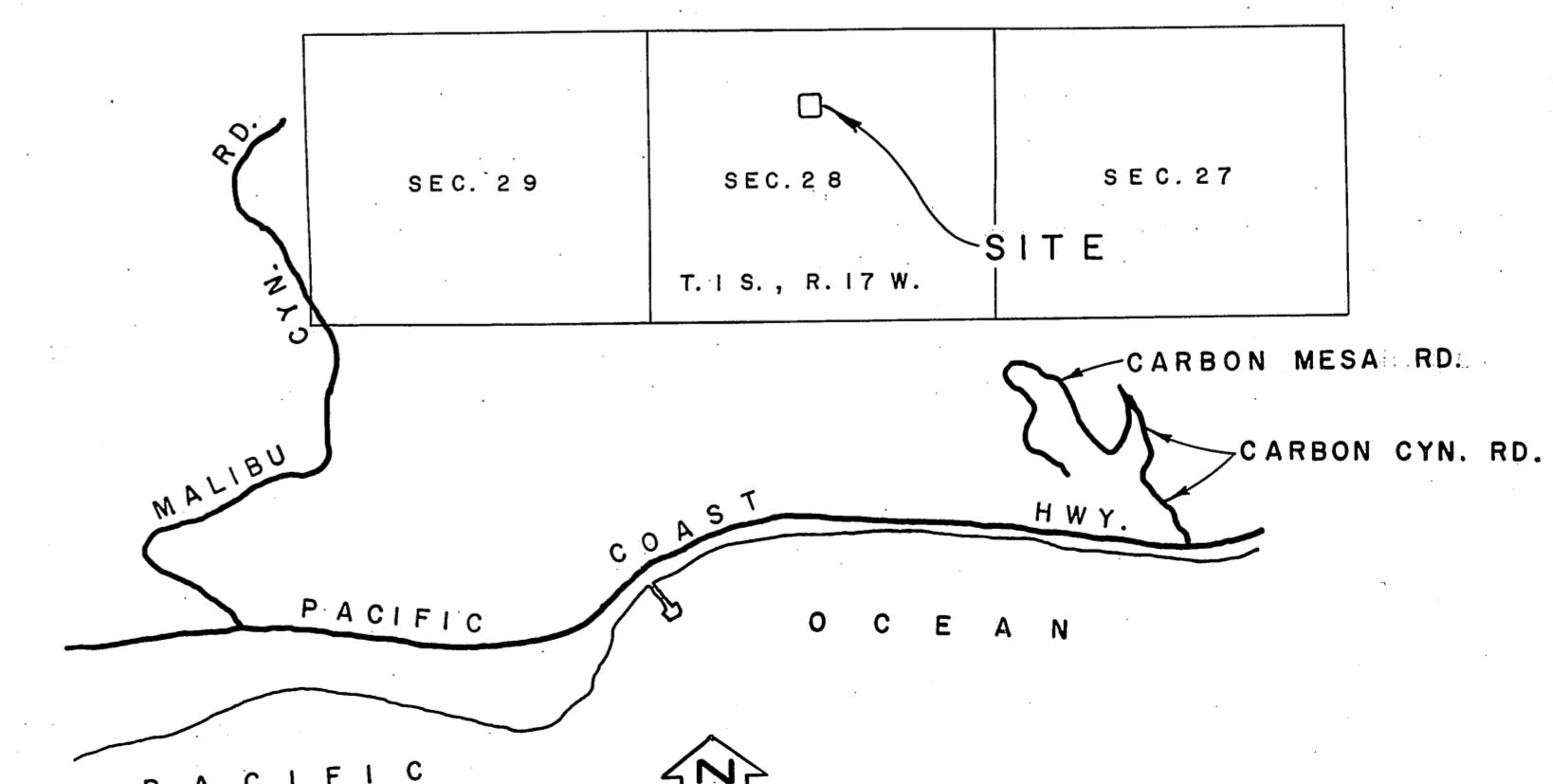
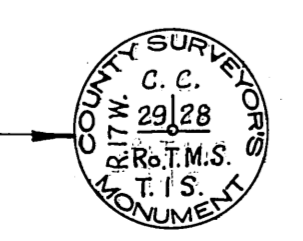

Established by inter-  
section. Nothing Set.



CLOSING CORNER  
A County Surveyor's Monu-  
ment marked: 4\"/>

MARGINAL MAP  
SHOWING  
SUBDIVISION OF SECTION  
SCALE: 1" = 200'

COUNTY OF LOS ANGELES DEPARTMENT OF COUNTY ENGINEER JOHN A. LAMMIE, COUNTY ENGINEER PREPARED BY SURVEY DIVISION IRA E. ALEXANDER, DIVISION ENGINEER SURVEYED BY C. K. LIND CHECKED BY G. D. BAILEY DRAWN BY B. H. TABATA	BOUNDARY MAP OF DEPARTMENT OF COMMUNICATIONS <b>MICROWAVE REFLECTOR SITE</b> MALIBU AREA		COUNTY SURVEYOR'S MAP NO. <b>B-5112</b>	REVISION NO. BY DATE	
	SHEET 1 OF 1 SHEET FILED: <i>Feb 18 1970</i> <i>John A. Lammie</i> COUNTY ENGINEER		SURVEYED <b>FEB. 1970</b>		
	BASIS OF BEARINGS CALIFORNIA COORDINATE SYSTEM, ZONE 7		REFERENCE F.B. 3444-25-35		
	JOB NUMBER 0090.03		INDEX MAP NO. 129-077		