

DETAIL SCALE 1" = 40'

SCALE IN FEET

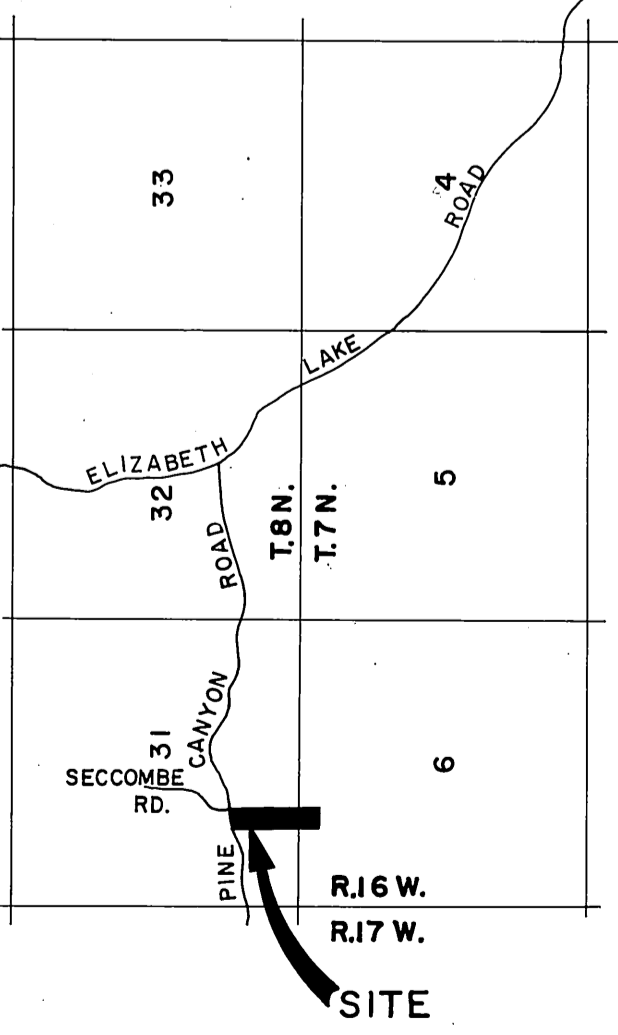

COUNTY OF LOS ANGELES
 DEPARTMENT OF
 COUNTY ENGINEER
 HARVEY T. BRANDT - COUNTY ENGINEER
 PREPARED BY
 SURVEY DIVISION
 GEORGE J. FRANCISCHINI - DIVISION ENGINEER
 SURVEYED BY W. J. VOGE
 CHECKED BY D. SAPPPELL
 DRAWN BY R. R. SHEAN

BOUNDARY MAP OF
 FIRE STATION SITE NO. 130
 AND
 FORESTRY CAMP NO. 1
 PINE CANYON AREA
 FOR TOPOGRAPHY SEE SURVEY DIVISION
 FILE MAP NO. P.T. 458, & P.T. 491.
 CALIFORNIA COORDINATE SYSTEM, ZONE 7

COUNTY SURVEYORS MAP NO.		REVISION	
B-5153		NO.	DATE
SHEET 1 OF 1 SHEET			
FILED: <i>Relway 10 1972</i>			
SURVEYED BY: <i>R. J. MATELLO</i>			
DATE: DEC. 1969 - MARCH 1971			
REFERENCE: F. B. 1698-85-176			
JOB NUMBER: 02928	INDEX MAP NO. 73		