

Found railroad spike. See
L.A. City FB 228-149-101 &
Tr. No. 24998, M.B. 808-46-47.
F.B. 3146-257-262

TRACT

M. B.

LOT

808-46-47

Set squarehead spike & tin.
F.B. 3146-262

24998

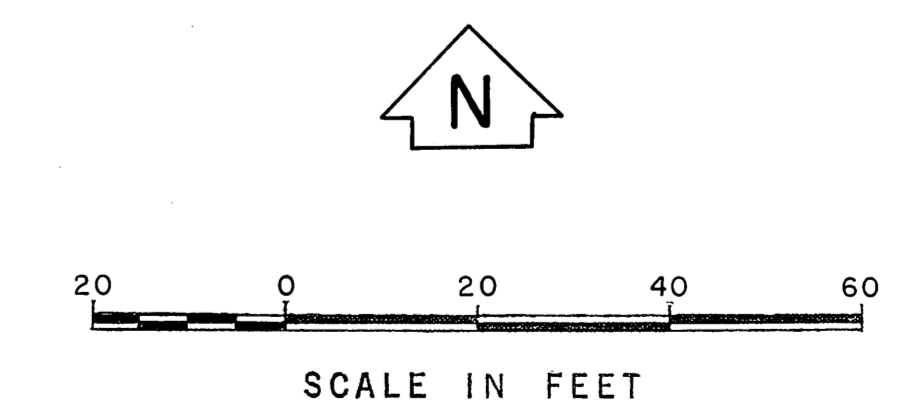
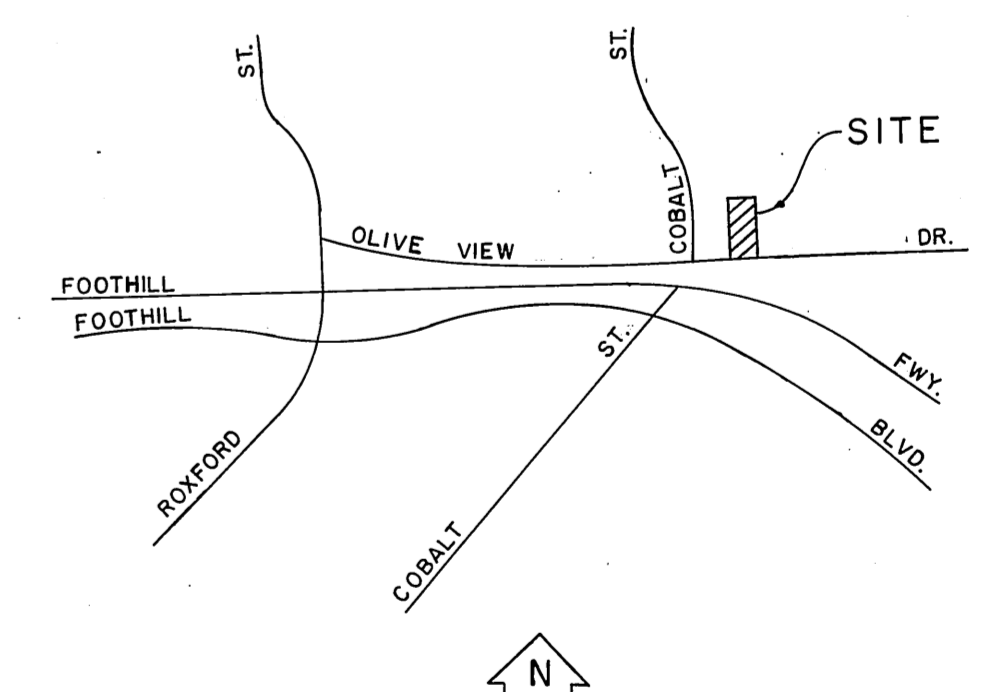

| | | | |
|--|---|---|-------------------------|
| COUNTY OF LOS ANGELES DEPARTMENT OF COUNTY ENGINEER HARVEY T. BRANDT—COUNTY ENGINEER PREPARED BY SURVEY DIVISION GEORGE J. FRANCESCHINI—DIVISION ENGINEER SURVEYED BY <u>R. DALE</u> CHECKED BY <u>R. HILARIO</u> DRAWN BY <u>C. MOTEN</u> | BOUNDARY MAP OF FIRE STATION SITE NO. 46 OLIVE VIEW FOR TOPOGRAPHY SEE SURVEY DIVISION FILE MAP NO. PT.-J-46. BASIS OF BEARINGS THE CENTERLINE OF OLIVE VIEW DR. (N.86 34' 50" E.) AS SHOWN ON TRACT NO. 24998, M.B. 808-46-47. | COUNTY SURVEYOR'S MAP NO. B-5179 | REVISION NO. BY DATE |
| | | SHEET 1 OF 1 SHEET FILED: <u>August 23 1972</u> SURVEYED JULY 1972 REFERENCE F.B. 3146 - 262 JOB NUMBER 0039.17 INDEX MAP NO. 53 | |