

S E C T I O N

33

T. 6 N.,

R. 13 W.

MT. MCDILL
TRANSMITTER SITE
(PALMDALE AREA)

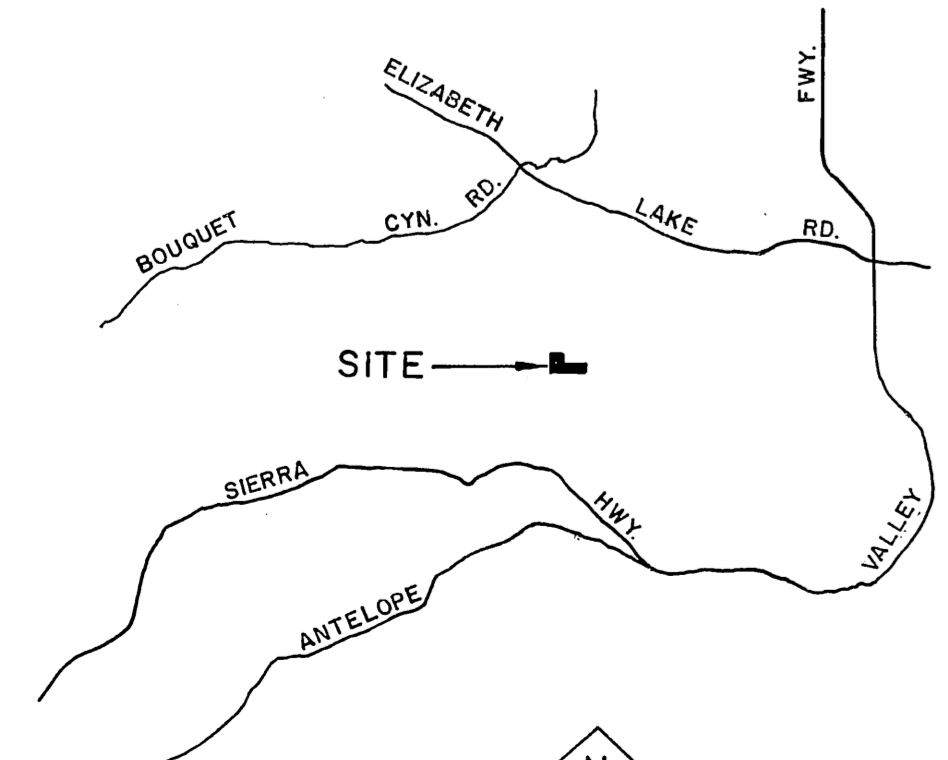

VICINITY MAP
NOT TO SCALE

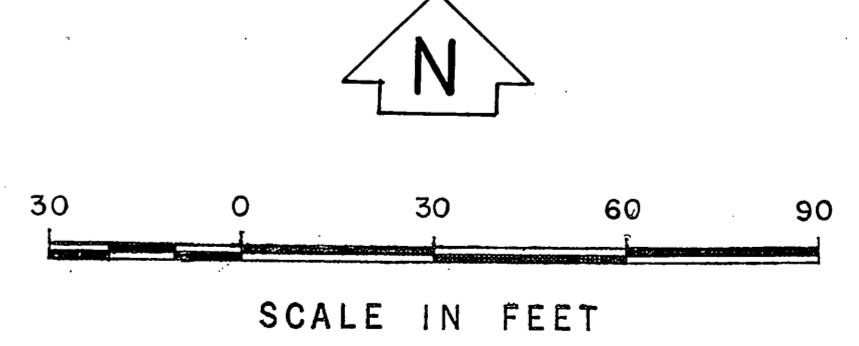

| | | | | |
|--|---|--|---|-------------------------|
| COUNTY OF LOS ANGELES DEPARTMENT OF COUNTY ENGINEER HARVEY T. BRANDT—COUNTY ENGINEER PREPARED BY SURVEY DIVISION GEORGE J. FRANCISCHINI—DIVISION ENGINEER SURVEYED BY K. KING CHECKED BY R. BARTHOLOMEW DRAWN BY C. MOTEN | BOUNDARY MAP OF MT. MCDILL TRANSMITTER SITE (PALMDALE AREA) | | COUNTY SURVEYOR'S MAP NO. B-5259 | REVISION NO. BY DATE |
| | SHEET 1 OF 1 SHEET FILED: June 23 1972 <i>R. J. Moten</i> DEPUTY | | MARCH 1975 - APRIL 1975 | |
| | BASIS OF BEARINGS THE ELY LINE OF SECTION 33, T. 6 N., R. 13 W. (N. 0° 18' 27" W.) AS SHOWN ON R. S. 67-26. | | REFERENCE F.B. 4137 F.B. 3202 R.S. 67-26 | |
| | JOB NUMBER 0018.66 | | INDEX MAP NO. 64 | |