

DETAIL MAP NOT TO SCALE

DETAIL MAP NOT TO SCALE

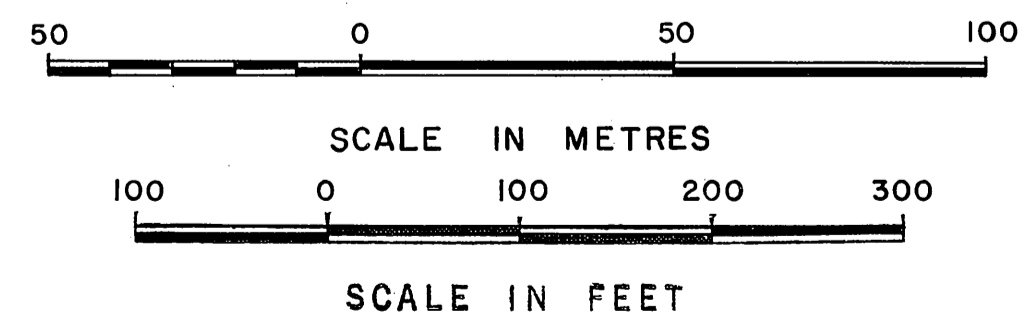
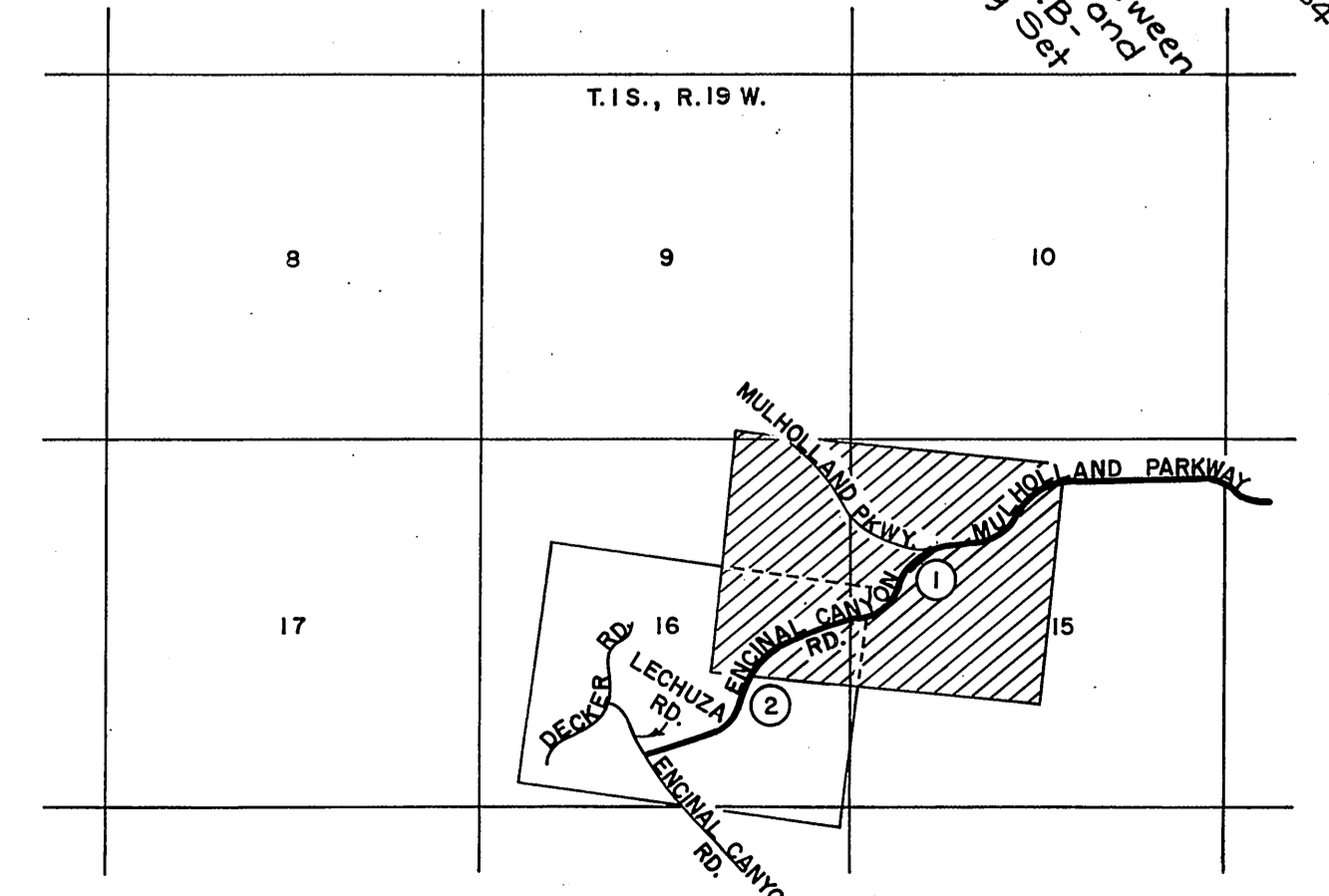

COUNTY OF LOS ANGELES DEPARTMENT OF COUNTY ENGINEER STEPHEN J. KOONCE - ACTING COUNTY ENGINEER PREPARED BY SURVEY DIVISION RICHARD J. MITCHELL - DIVISION ENGINEER SURVEYED BY <u>R.C. DALE</u> CHECKED BY <u>R.G. HILARIO</u> DRAWN BY <u>A. MITCHELL</u>	ALIGNMENT MAP OF ENCINAL CANYON ROAD FROM MULHOLLAND HIGHWAY TO LECHUZZA ROAD BASIS OF BEARINGS CALIFORNIA COORDINATE SYSTEM, ZONE 7		COUNTY SURVEYOR'S MAP NO. B-5275 SHEET 1 OF 2 SHEETS FILED: <u>Step 27</u> <u>Richard J. Mitchell</u> DEPUTY DEC. 1967 - MAR. 1969 REFERENCE FB. 3443-5-110 JOB NUMBER 0055.96 INDEX MAP NO. 153-817	REVISION NO. BY DATE

C.S.B-2512-S



SURVEY CONTROL STATION DUME Pt. C-3
 Found L.A. Co. Survey Control System monument. See F.B. 2458-11, 112; F.B. 3443-76
 N. 4, 140, 980.30
 E. 4, 021, 689.18 (1968 Adjustment)

SURVEY CONTROL STATION RUSSELL VALLEY E-12
 Found L.A. Co. Survey Control System monument. See F.B. 2458-123, 130; F.B. 3443-76
 N. 4, 149, 470.82
 E. 4, 025, 642.69 (1965 Adjustment)

Found 3/4" iron pipe, wood plug and tin. See Fig. 1437-B and Rd. Dept. F.B. 327-56, 65. Removed and set 2" iron pipe, conc. plug and brass tag marked "L.A. CO. ENGR." 1' below surface. F.B. 3443-9, 76

Found 2" Rd. Dept. brass cap monument marked "L.A. CO. Rd. Dept." in handhole. See Rd. Dept. F.B. 327-65. F.B. 3443-10

Found spike, washer and tin 3" below surface. See Rd. Dept. F.B. 327-57, 66. F.B. 3443-11

Found 2" Rd. Dept. brass cap monument marked "L.A. CO. Rd. Dept." in handhole. See Rd. Dept. F.B. 327-66. F.B. 3443-11

Found 3/4" iron pipe, no plug. See Rd. Dept. F.B. 327-37. F.B. 3443-11

1/4 SECTION CORNER
 Found County Surveyors monument marked in concrete. See F.B. 3443-60
 F.B. 463-56

NOTE
 THE ALIGNMENT OF ENCINAL CANYON RD. AND MULHOLLAND HIGHWAY, A PROPOSED RD. ON THE EAST SIDE OF ENCINAL CANYON, HAD NOT BEEN ESTABLISHED AT THE TIME OF THE FILING OF THIS MAP.

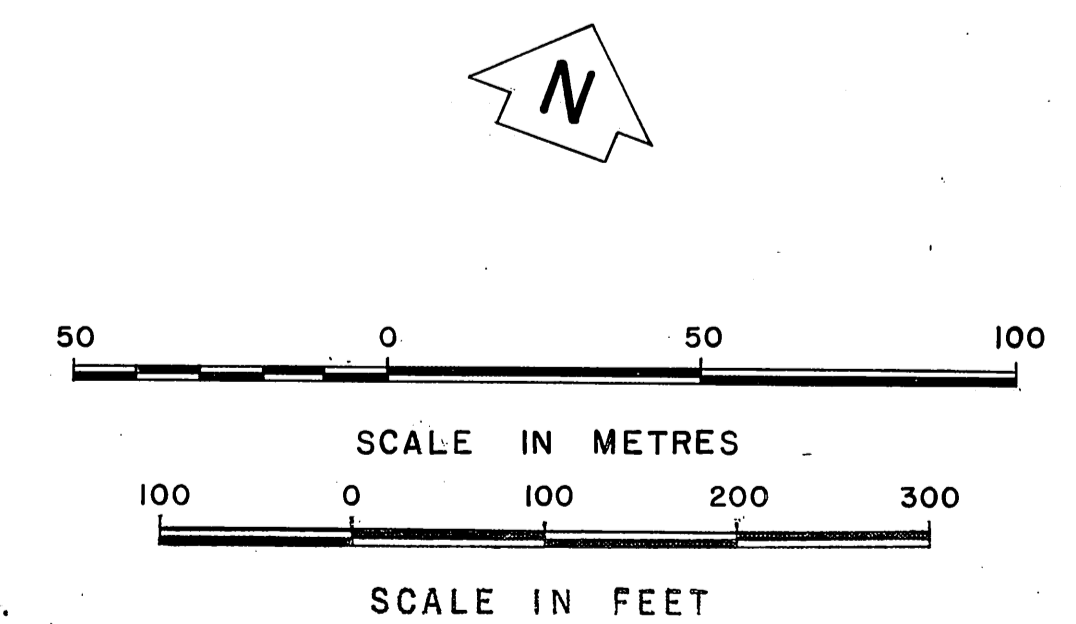
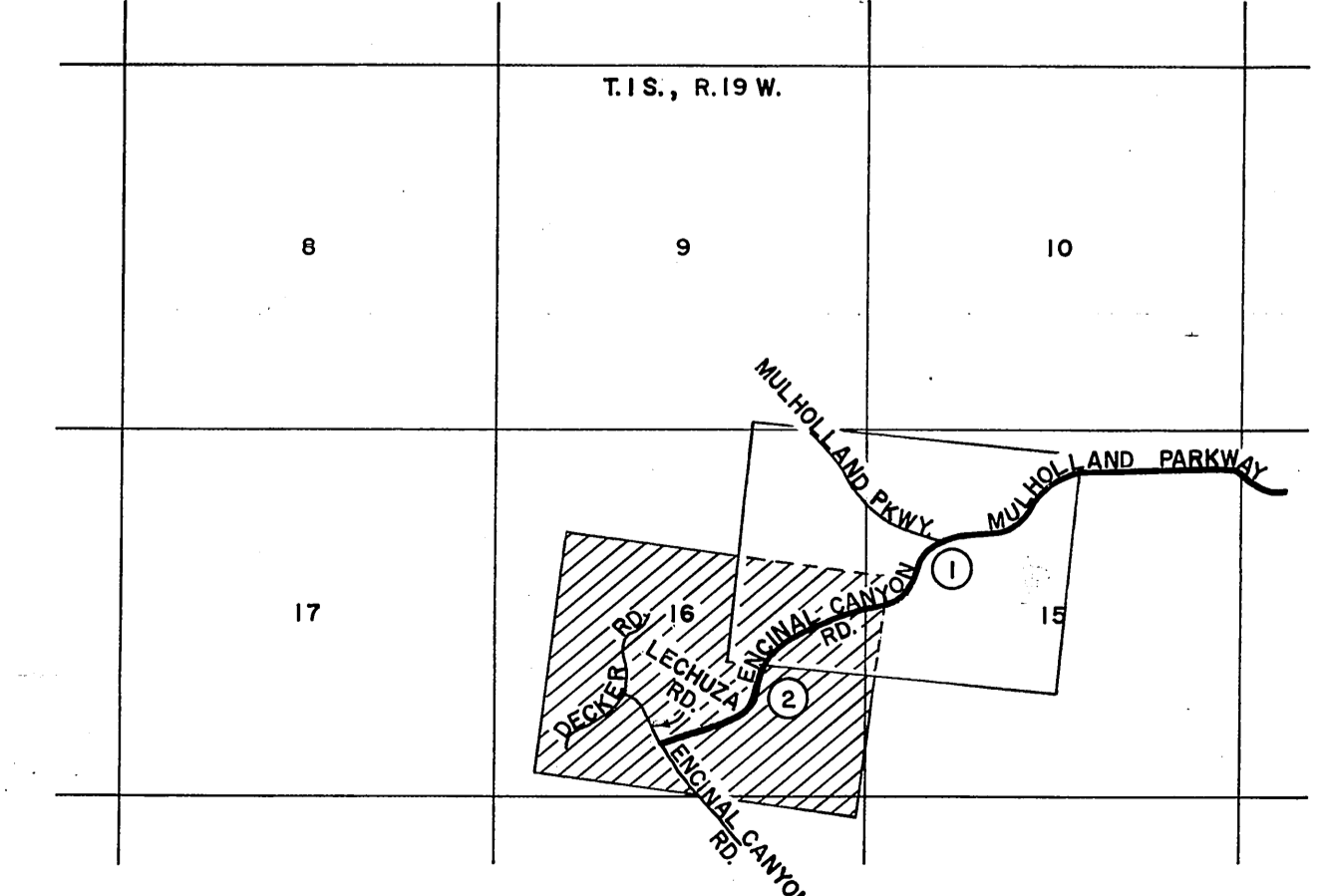

COUNTY OF LOS ANGELES DEPARTMENT OF COUNTY ENGINEER STEPHEN J. KOONCE-ACTING COUNTY ENGINEER PREPARED BY SURVEY DIVISION RICHARD J. MITCHELL DIVISION ENGINEER SURVEYED BY R.G. PALER CHECKED BY R.G. MILARIO DRAWN BY A. MITCHELL	ALIGNMENT MAP OF ENCINAL CANYON ROAD FROM MULHOLLAND HIGHWAY TO LECHUZA ROAD BASIS OF BEARINGS CALIFORNIA COORDINATE SYSTEM, ZONE 7	COUNTY SURVEYOR'S MAP NO. B-5275 SHEET 2 OF 2 SHEETS FILED <i>July 24 1969</i> DEPUTY SURVEYOR DEC. 1967 - MAR. 1969 REFERENCE F.B. 3443-5-110 JOB NUMBER 0095.96 INDEX MAP NO. 23-017 144-917	REVISION NO. BY DATE
		DRAWN BY A. MITCHELL	REVISION NO. BY DATE

C.S.B-2512-S