

### WEST ROWLAND HEIGHTS PARK

NO	Δ	R	T	L
1	11°26'20"	210.312	21.064	41.988
2	11°31'08"	210.312	21.211	42.282
3	11°30'53"	210.312	21.205	42.266
4	11°31'02"	210.312	21.209	42.276
5	42°11'48"	152.400	58.801	112.238
6	07°12'45"	91.440		11.511
7	40°32'30"	91.440		64.701
8	47°45'15"	91.440	40.478	76.212
9	11°26'20"	219.456	21.980	43.814
10	11°31'08"	201.168	20.290	40.443
11	11°30'53"	201.168	20.283	40.429
12	11°31'02"	219.456	22.131	44.114
13	90°00'17"	4.572	4.572	7.182
14	42°11'48"	143.256	55.273	105.504
15	07°12'45"	82.296		10.360

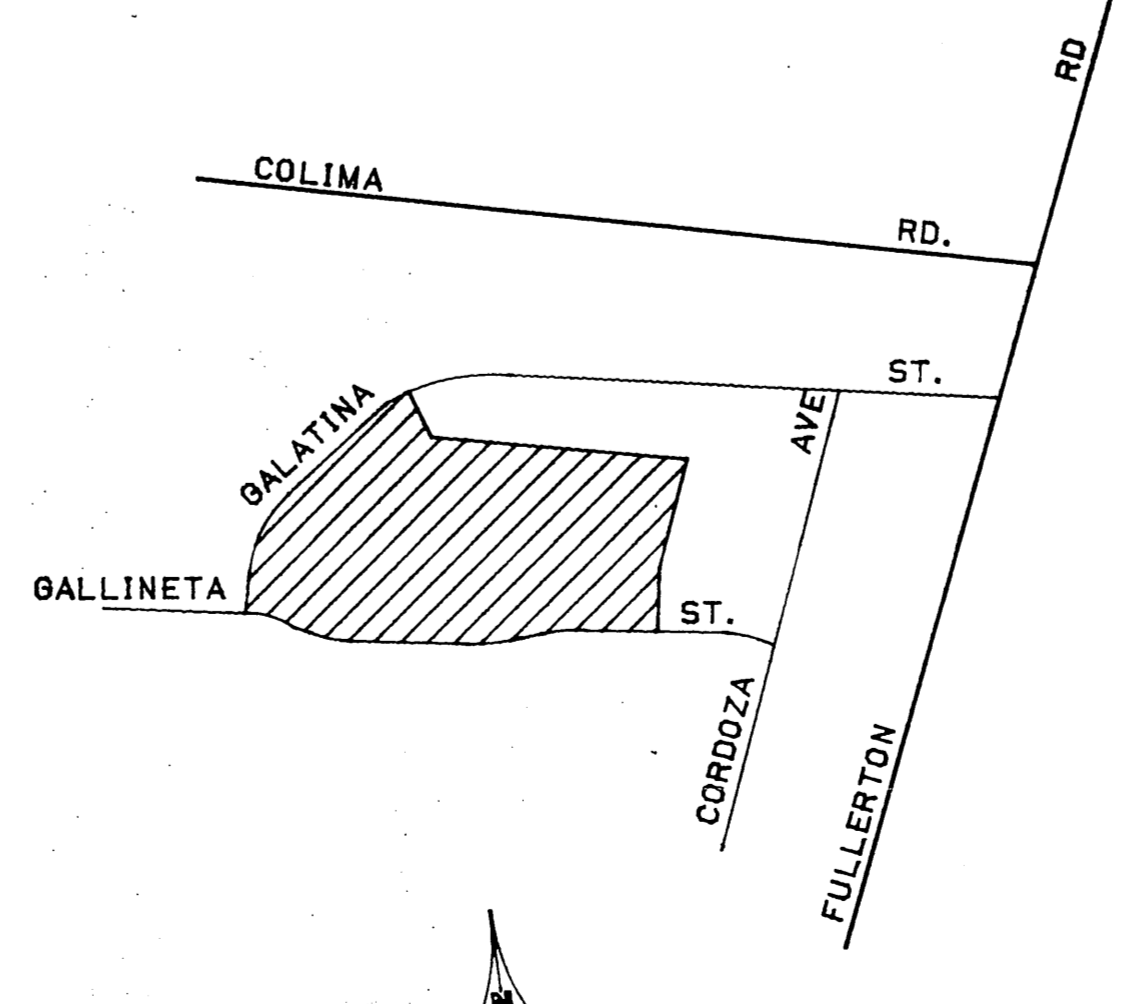

NOTE : ALL DIMENSIONALS SHOWN HEREON ARE IN METERS AND DECIMAL FRACTIONS THEREOF  
1 METER = 39.37/12 U.S. SURVEY FEET EXACTLY

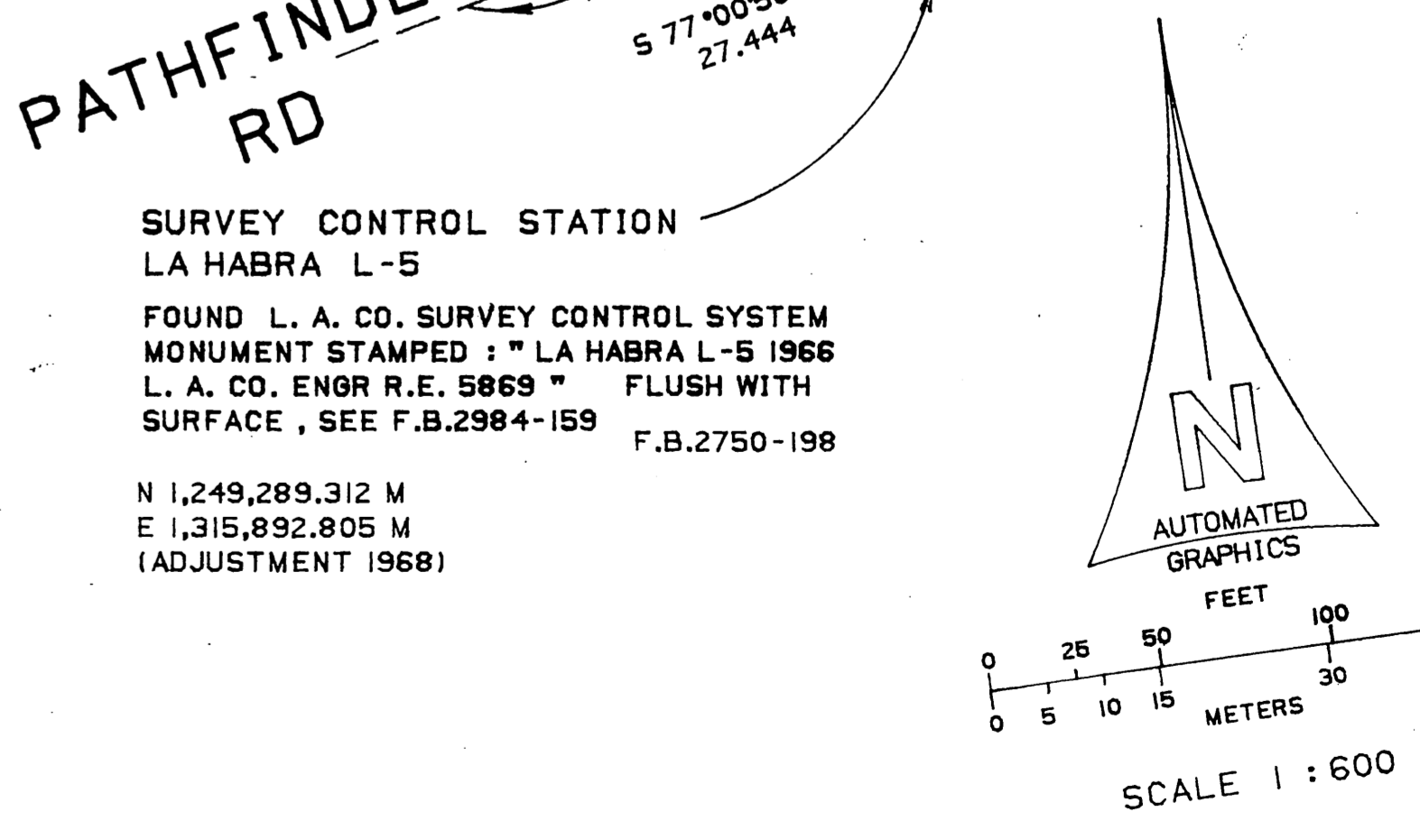

COUNTY OF LOS ANGELES DEPARTMENT OF COUNTY ENGINEER-FACILITIES STEPHEN J. KOONCE-COUNTY ENGINEER PREPARED BY SURVEY DIVISION RICHARD J. MITCHELL ASSISTANT DEPUTY COUNTY ENGINEER SURVEYED BY M. E. WACKER CHECKED BY R. HILARIO DRAWN BY E. FONG	<b>BOUNDARY MAP OF          WEST ROWLAND HEIGHTS PARK          ( ROWLAND HEIGHTS )</b> FOR TOPOGRAPHY SEE SURVEY DIVISION FILE MAP NO. J-211 BASIS OF BEARINGS CALIFORNIA COORDINATE SYSTEM, ZONE 7		COUNTY SURVEYOR'S MAP NO <b>B-5400</b> SHEET 1 OF 17 SHEETS FILED: <i>Richard J. Mitchell</i> , 1982 DEPUTY SURVEYED APRIL 1982 REFERENCE F.B. 2724 F.B. 2750 F.B. 1871 F.B. 4425 F.B. 1876 TRACT NO. 23442 M.B. 745-39-41 JOB NUMBER INDEX MAP NO 0209.06 099-297	REVISION NO BY DATE
			1939 RE 2177 COVINA C-12 (ADJUSTMENT 1968)	
			SURVEY CONTROL STATION COVINA C-12 FOUND L.A. CO. SURVEY CONTROL SYSTEM MONUMENT MARKED : "LA HABRA L-5 1966 L. A. CO. ENGR. R. E. 5889" FLUSH WITH SURFACE, SEE F.B. 2984-159 F.B. 2750-198 N 1,249,289.312 M E 1,315,892.805 M (ADJUSTMENT 1968)	
			SURVEY CONTROL STATION LA HABRA L-5 FOUND L. A. CO. SURVEY CONTROL SYSTEM MONUMENT STAMPED : "LA HABRA L-5 1966 L. A. CO. ENGR. R. E. 5889" FLUSH WITH SURFACE, SEE F.B. 2984-159 F.B. 2750-198 N 1,249,289.312 M E 1,315,892.805 M (ADJUSTMENT 1968)	