

Plat

of

a lot of land situated in the City and County of Los Angeles State of California, described in a Mortgage recorded in liber N:4 Mortgages pages 499 and 500 in the Record of Los Angeles County, and surveyed request of Señor Don Augustin Olvera on the 15th day of March 1867. by George Hansen, County Surveyor.

Scale of one inch to 80 feet.

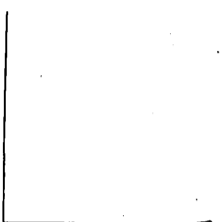
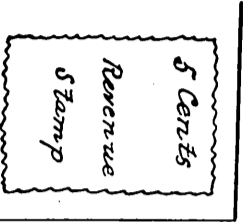

Calle de las Virgenes

State of California }
County of Los Angeles }
County Surveyor's Office
Los Angeles City March 15th 1867
I hereby certify the above to be a correct plat of a Survey executed by me to day on request of Señor Don Augustin Olvera.
George Hansen, County Surveyor.

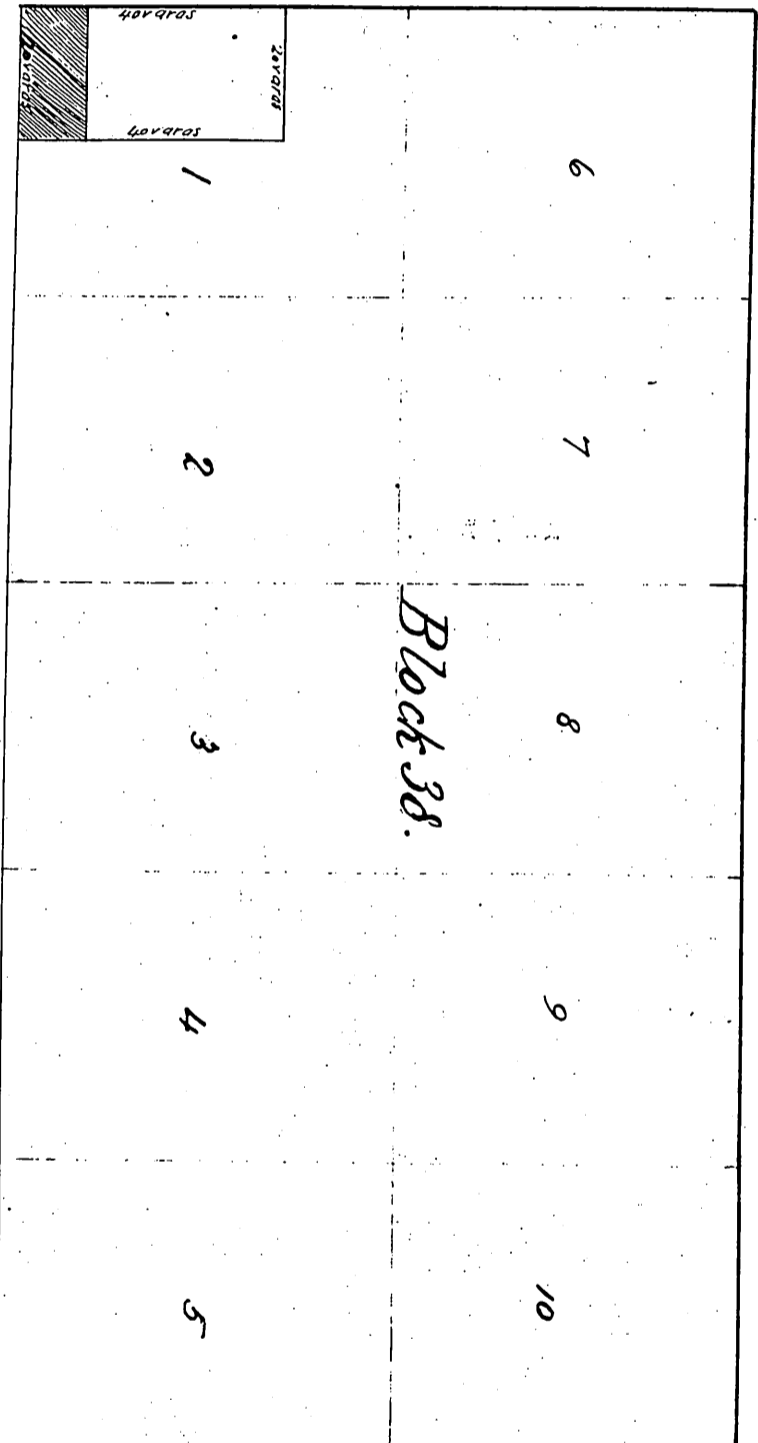

Calle de las Arispas

Calle del Toro

Calle del Colegio

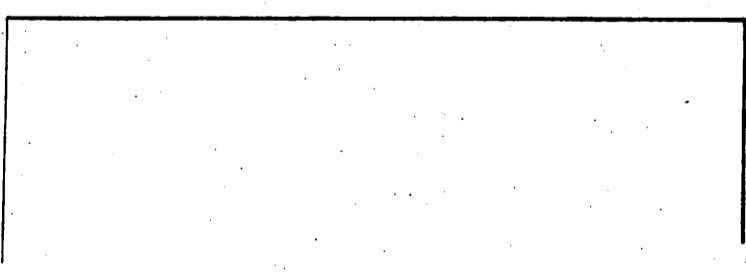

Recorded March 27th 1867, at 10^{am}.
at request of E. Naud.

Comp. by
G. Hansen