

DM 1595-305

30

24

PACIFIC OCEAN

BEACH

NORTH MANHATTAN BEACH

MANHATTAN BEACH

2 feet soft

S 89° 42' W 2168.1 feet

Sec. Cor. N.E. cor. Sec. 23 T.35. R.16W. S.B.M.

Geo. H. Peck, Jr. to L.A., Hermosa Beach & Redondo Ry. Co.

High Water Line RY RIGHT OF WAY S 20° 00' E 2799.7 ft.

High Water Line RY RIGHT OF WAY S 23° 45' E 2149.6 ft.

High Water Line RY RIGHT OF WAY S 26° 30' E 718.6 ft.

High Water Line RY RIGHT OF WAY S 23° 00' E 602.4 ft.

Section Corner Sec. 24 Sec. 25

Witness post on high water mark west 20.15 ft. from Sec. cor.

Witness post on high water mark south 44.25 ft. from Sec. cor.

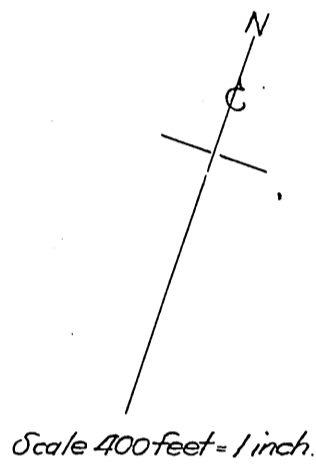

N 67° 18' E 2 feet

M. B4-266

Recorded July 21, 1902.

A 87

D. 1595