

Southern Pacific Company  
to  
Thomas H. Brown.

TOLUCA  
Los Angeles Co. Cal.  
Showing Lots 10 & 11 in Block 20  
Scale 100' = 1" Dec 1903.

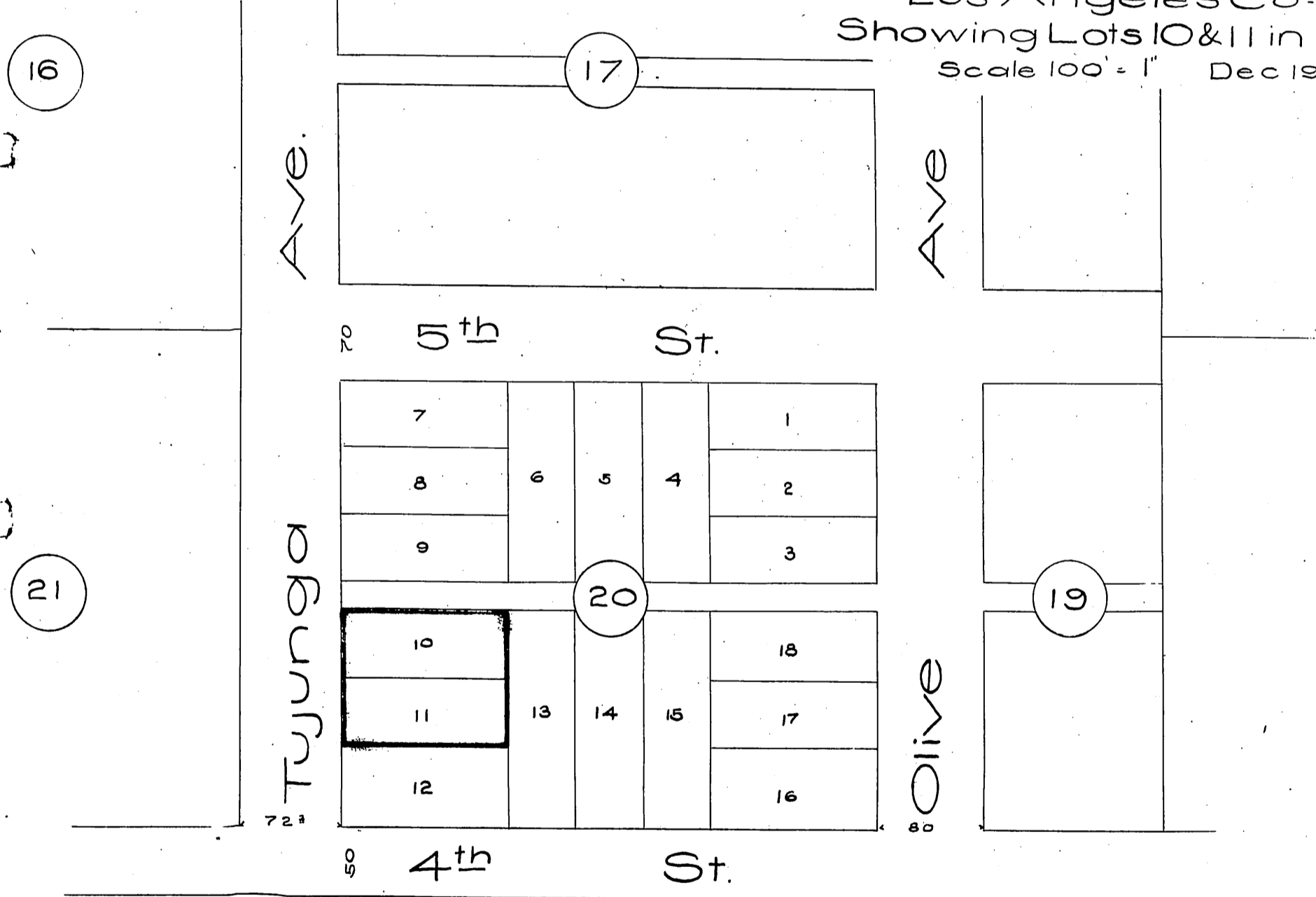

Recorded Jul. 24, 1905

Sht. O.K. ~~See M-28-93~~ ?  
A. 127

*[Handwritten signature]*