

Indenture of License  
between  
Atchison Topeka and Santa Fe  
Railway Company  
and  
City of Los Angeles

EXHIBIT "A"  
ATTACHED TO CONTRACT BETWEEN  
THE A.T.&S.F.RY.CO.  
AND  
CITY OF LOS ANGELES

Los Angeles, Cal  
December 9th 1905

C.A. Morse  
Acting Chief Engineer

Correct as to Description  
M.B. Terrass  
Resident Engineer

Scale 100' = 1 inch

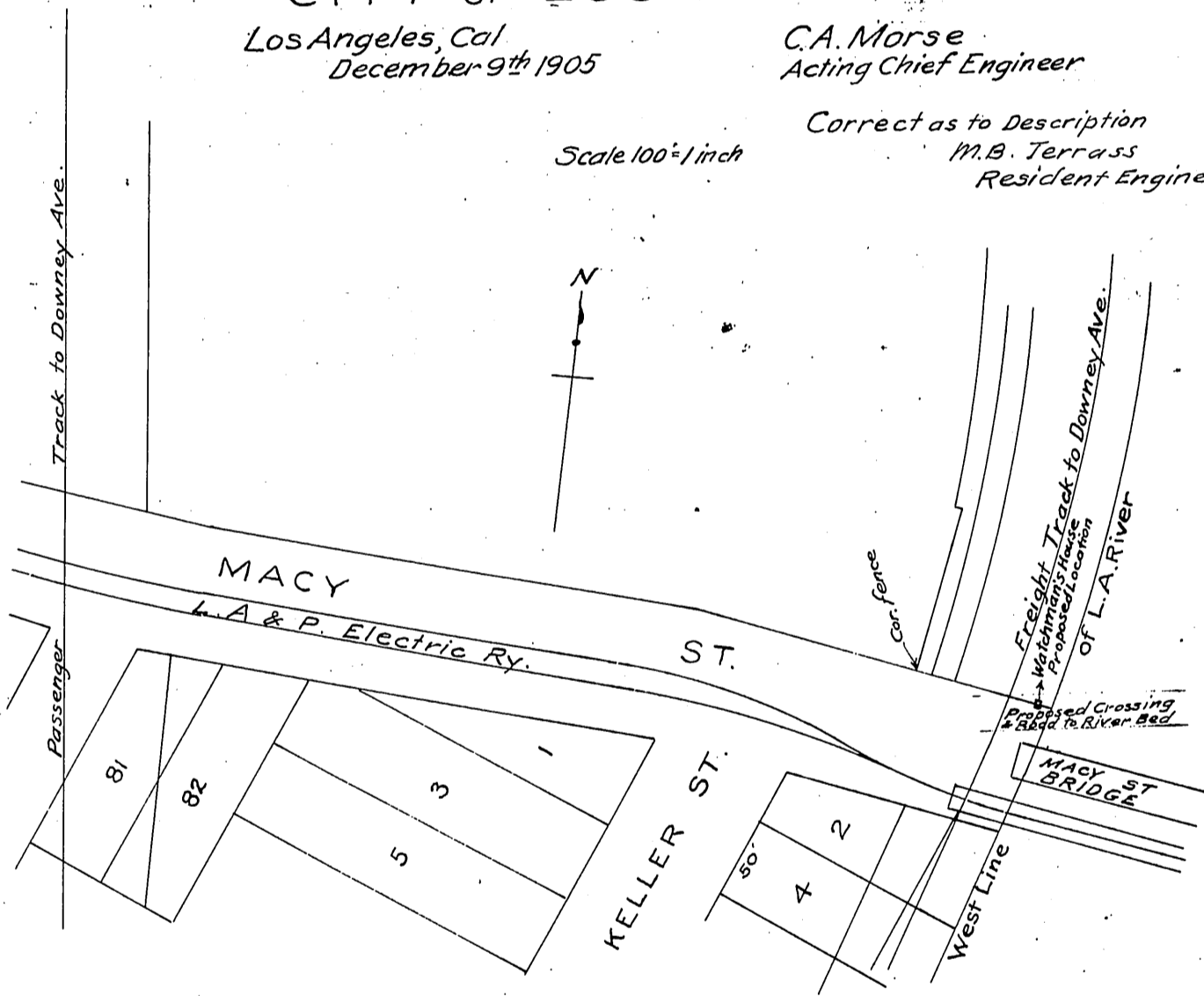

Proposed Road Crossing to River shown between red lines

Recorded Apr. 12, 1906