

DM 3075-264

12

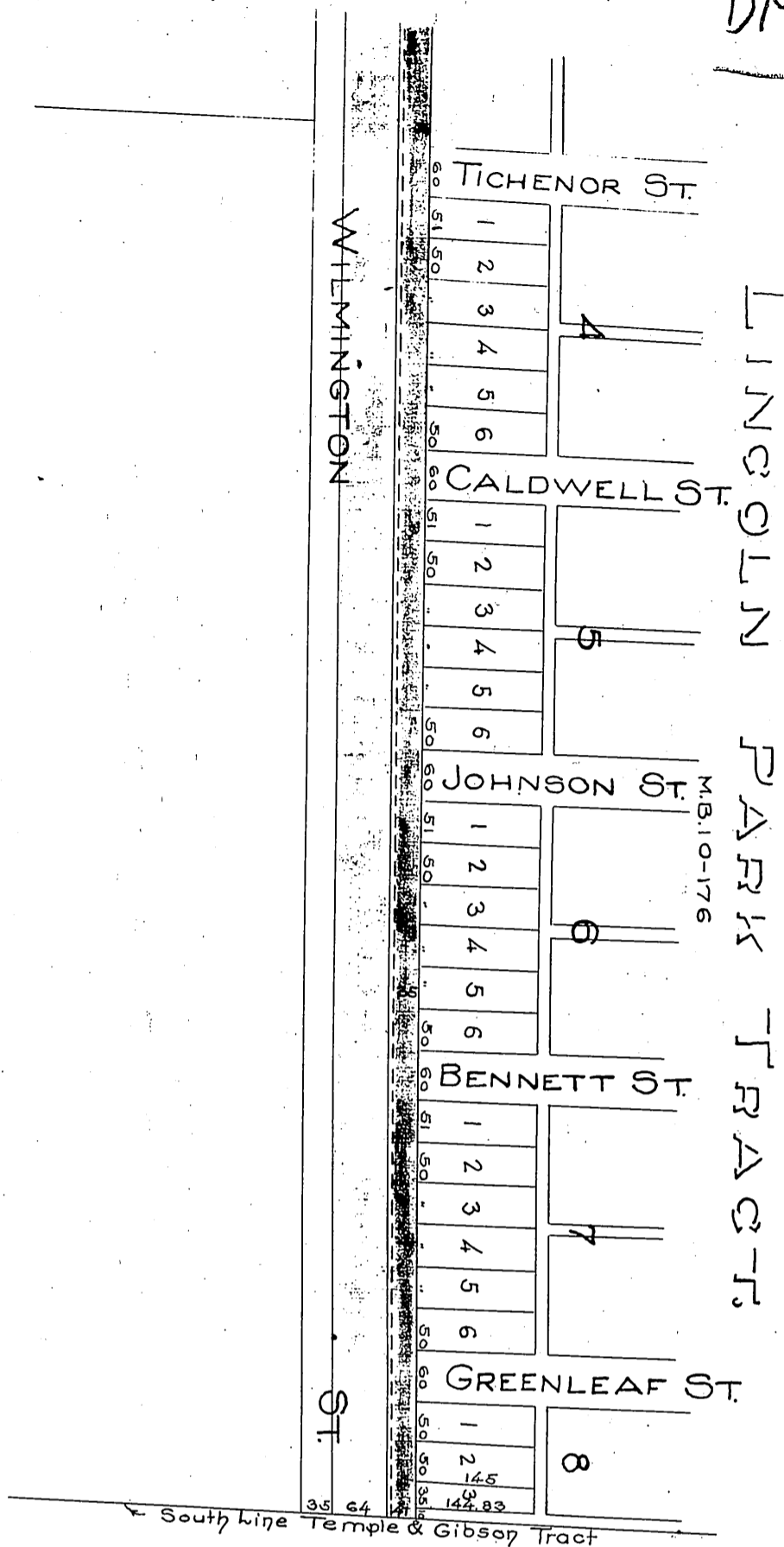

Proprietors.

- Compton Land Co.
- Methodist Episcopal Church of Compton.
- Compton City School District
- J.J. Harshman
- J. F. Avery
- W.J. Horne
- C.C. Willits
- Willoughby H. Corbin
- John R. Hann
- S.M. Bise
- S.T. Mears
- C.F. Mears
- Sazaire Courville
- Delia Courville
- Nelson Courville
- Mary Courville
- Mrs Sarah A. Bise
- Arminda Mears
- Jennie A. Harshman
- Frank X. Boyer
- Caroline Boyer
- Mrs Ada Mears
- Mrs Nellie Corbin
- C.L. Thompson
- Mrs Jennie H. Thompson
- Lois A. Avery
- Carrie F. Horne
- J. B. Giel
- T.C. Chopman Trustee
- J.J. Morton. Admin. of estate of Mary A. Burlingame dec.
- Mrs C.B. Giel
- A.B. Renfro

Mortgagees

- Title Insurance & Trust Co
- John Shaffer
- Wm Shamrock.
- W. I. Stevens
- Calvin Thornton
- David Gates
- Mary J. Gates

Proprietors

- R.P. Menefee
- Anna D. Menefee
- F.U. Elser
- Mrs Lizzie Elser
- John F. Hawk
- Martha E. Hawk.
- Mabel Marleau
- Chas M. Marleau
- Mrs Mary Hebert
- Jesse Marleau
- Pearl Marleau
- Adelia C. Renfro
- W. I. Stevens
- Admiral F. Borden
- Alta Imbert.
- D.I. Imbert
- E.S. Robinson
- Jessie Robinson
- Maggie Camp formerly Maggie Soffstrom
- Thos. G. Peachey
- A. Jud Shepard
- Mary G. Shepard
- Ellen R. Ramie
- Annie M. Marleau

to Pacific Electric Land Co

Recorded June 14, '07

M. C. H.