

The Atchison, Topeka and Santa Fe Ry. Co
-to-
City of Los Angeles

Exhibit "A"
Attached to a contract between
The A.T. & S.F. Ry. Co.
AND
City of Los Angeles
San Bernardino, Cal. Correct as to Description
Sept. 15, 1909 R. J. Arey.
Scale 1"=100' Division Engineer.
Revised Nov. 15, 1909
Revised June 17, 1910.

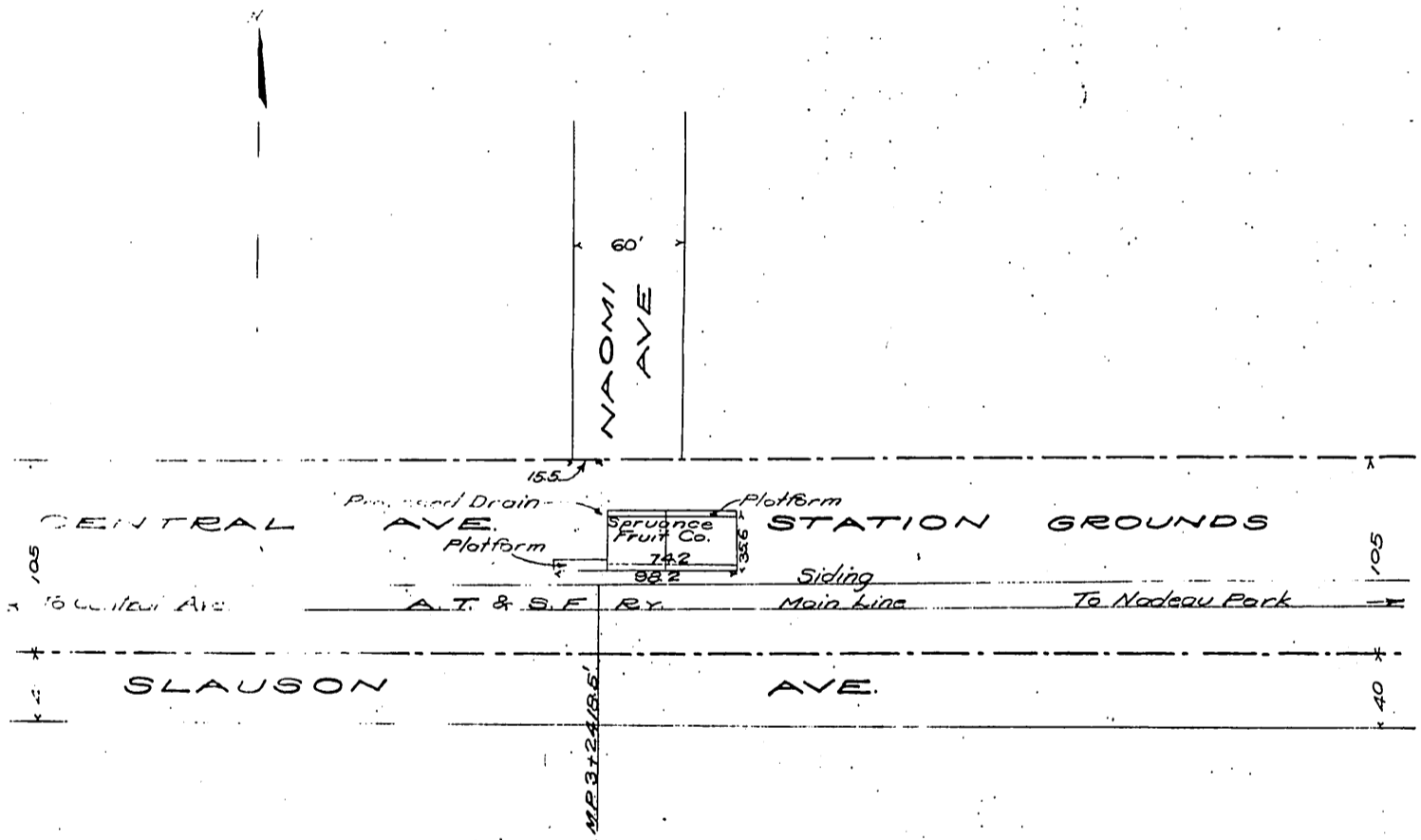

Description:

Proposed cast iron or reinforced concrete pipe not to exceed 18 inches in internal diameter or reinforced concrete culvert not to exceed 12 inches x 16 inches internal dimensions, the center line of which crosses under the tracks of The A. T. & S. F. Ry. Co at M.P. 3+24.85 feet, shown dotted red.

At Los Angeles, Los Angeles Co., Cal.

Division Engineer's Drawing No 200-2731
39-D.4

Sec. D: 16-38

Recorded Nov. 16, 1910.

Comp. H.C.T.