

Los Angeles Railway Corporation
-to-
City of Los Angeles

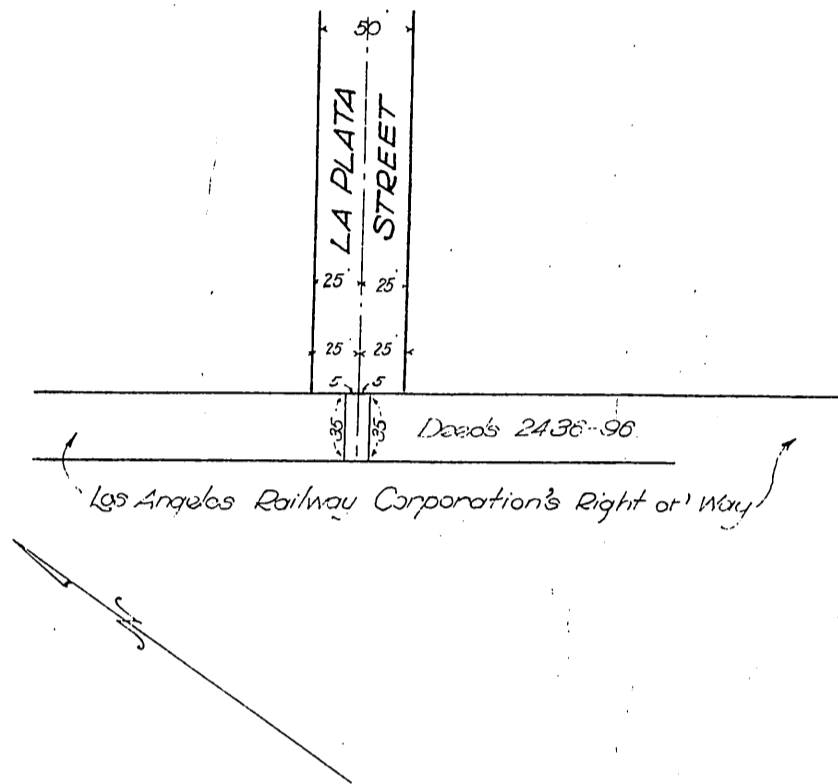

SAN FERNANDO ROAD DISTRICT
City of Los Angeles

PLAN

Showing proposed Right of Way for Servers
across the
Right of Way of the Los Angeles Railway Corporation
at

LA PLATA STREET

Scale: 1"=100'

HOMER HAMLIN CITY ENGINEER

Drawn by Williams 9/28 1915

Checked by Swf 9/29 15

Approved HOMER HAMLIN
City Engineer

By *[Signature]*
Chief Deputy

Note: Red tint shows proposed Right of Way

Recorded Dec 1, 1915