

R.M. Teague }  
R.W. Teague } ~ to ~ The Pacific Light and Power Corporation

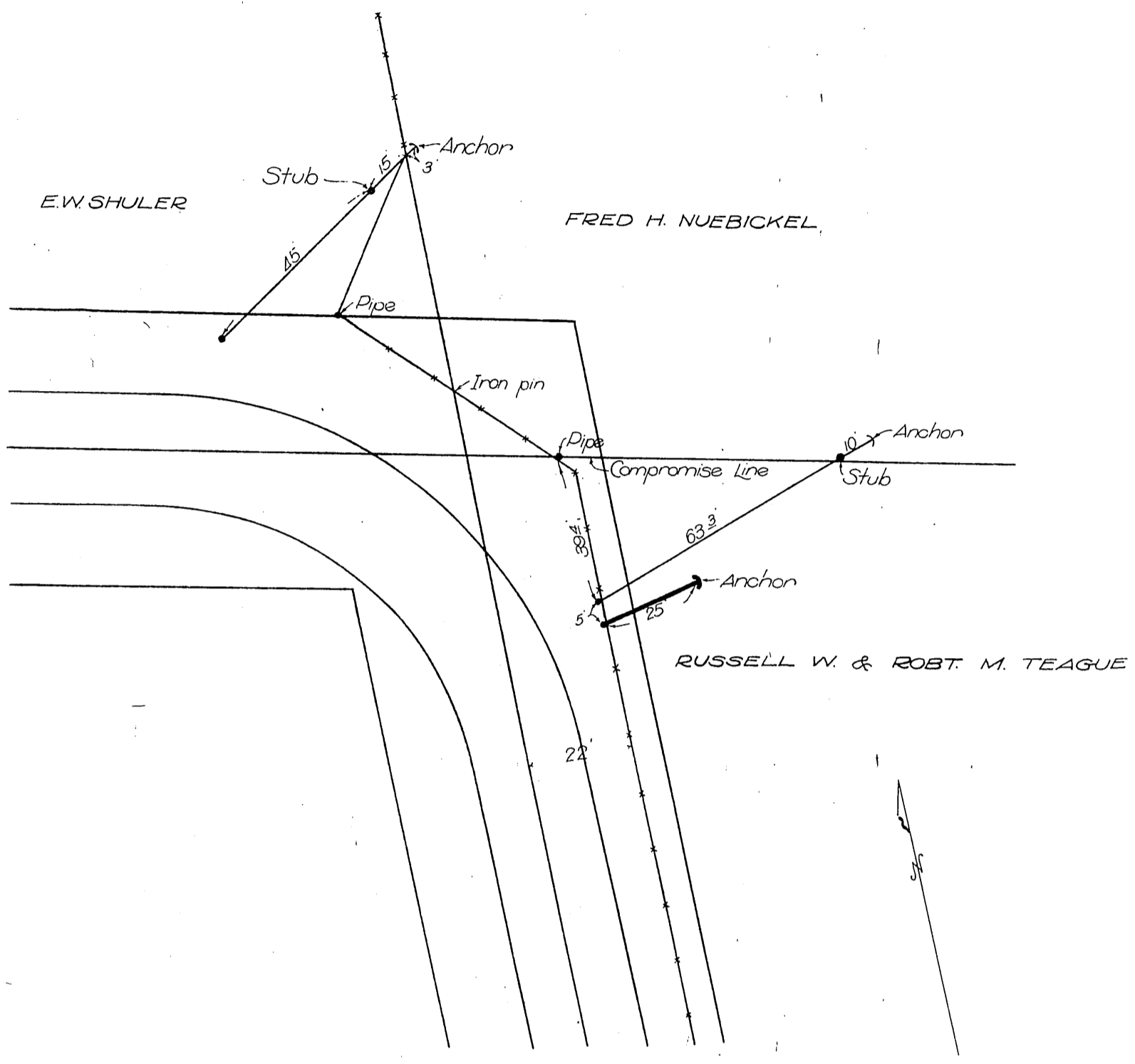

Location of Stubs & Anchors  
for 15 K.V. Line along Foothill Boulevard  
AT SAN DIMAS AVENUE  
in S.E. 1/4 Sec. 34 T.1N. R.9W. S.B.M.  
Los Angeles County, California

PACIFIC LIGHT and POWER CORP.	
LOS ANGELES, CALIFORNIA	
Drawn by _____	Traced by _____
Checked _____	Scale 1"=30'
App. _____	Date _____
19-1	

Recorded Mar. 14, 1916