

Los Angeles Trust and Savings Bank
- to -
City of Los Angeles

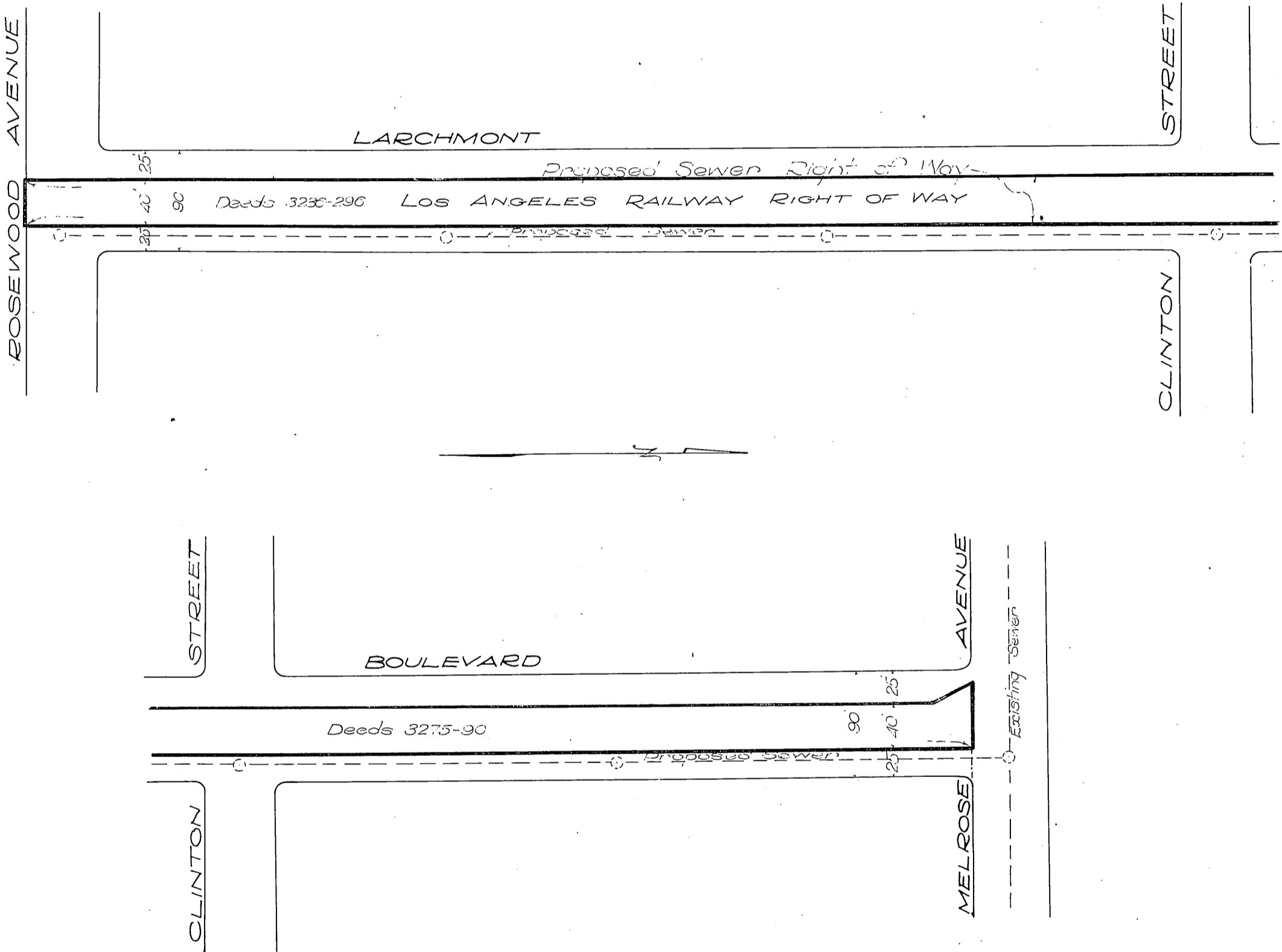

LARCHMONT BOULEVARD DISTRICT
City of Los Angeles
Plan showing right of way for proposed sewers in
LARCHMONT BOULEVARD
between MELROSE AVENUE & ROSEWOOD AVENUE
Homer Hornlin - City Engineer
Scale 1"=100'

Drawn by Walters
Checked by G.V.L. 10/22/15

Approved 10-29-1915
Homer Hornlin - City Engineer
By A.C. Hansen
Chief Deputy

Note: Boundary of Proposed Sewer Right of Way outlined by red tint.

Recorded Mar 1, 1916.