

Frederick H. Nusbickel  
 ~ to ~  
 The Pacific Light and Power Corp.

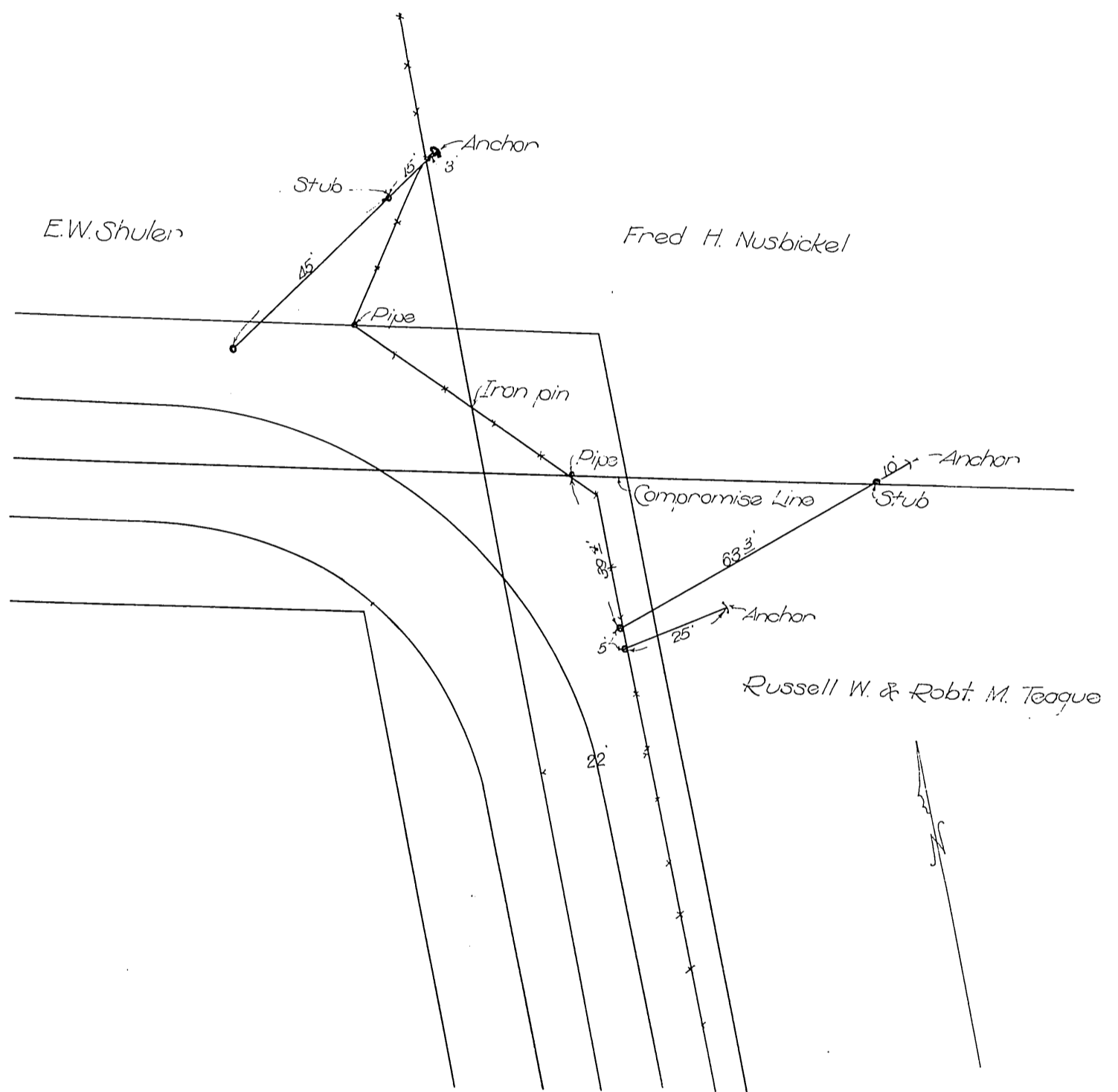

Location of Stubs & Anchors  
 for 15KV. line along Foothill Boulevard  
 at San Dimas Avenue  
 in S.E. 1/4 Sec. 34 T.1N., R.9W. S. B.M.  
 Los Angeles County, California

|   |                 |
|---|-----------------|
| <b>PACIFIC LIGHT and POWER CORP.</b><br>LOS ANGELES, CALIFORNIA |                 |
| Drawn by _____  | Traced by _____ |
| Checked _____   | Scale 1"=30'    |
| App. _____  | Date _____      |
| 19-1  |                 |

Recorded Mar 21, 1916