

DM 6267-100

105

5

Torrance, Marshall & Co. }
Ross E. Whitley } ~to~ City of Los Angeles

CITY OF LOS ANGELES
DEPARTMENT OF PUBLIC SERVICE
BUREAU OF
WATER WORKS AND SUPPLY
ENGINEERING DEPARTMENT

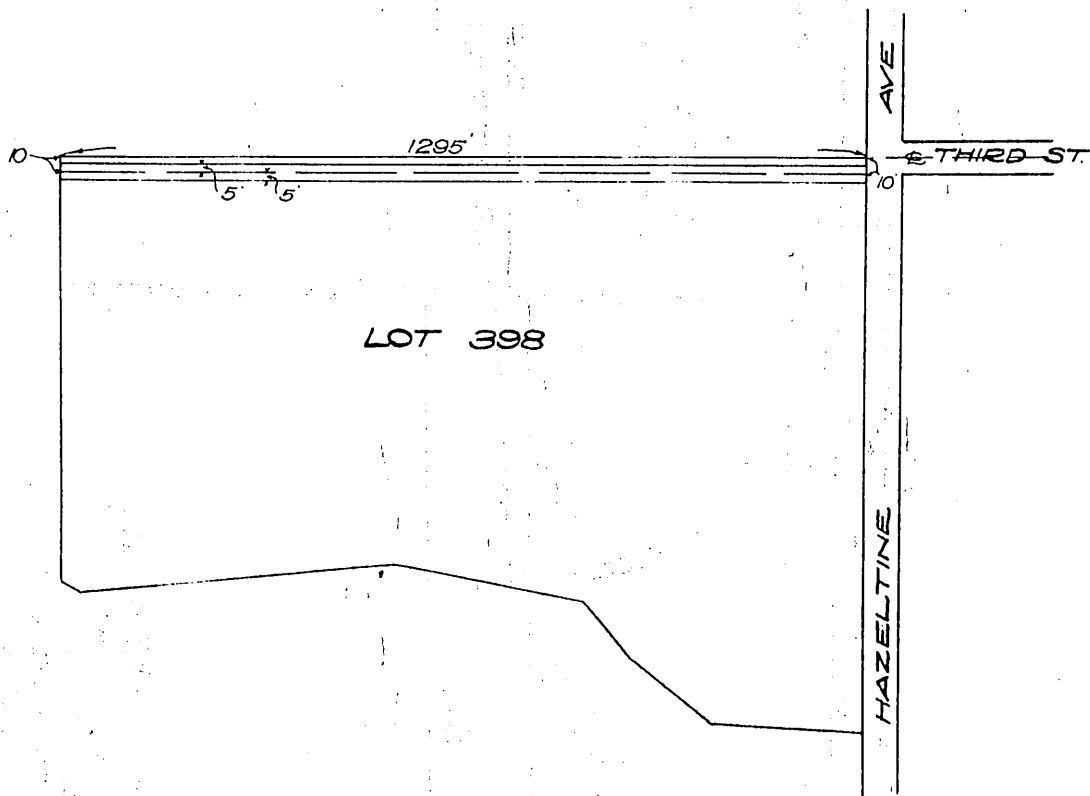

Right of Way for lateral 90 west 1/4 mile on
Third St. through Lot 398 TRACT No 1000 owned
by Thos. D. Campbell
March 24, 1916

Recorded Apr 22, 1916

D:6267