

DM 6298-157

Pacific Electric Railway Co. 35  
to  
County of Los Angeles.

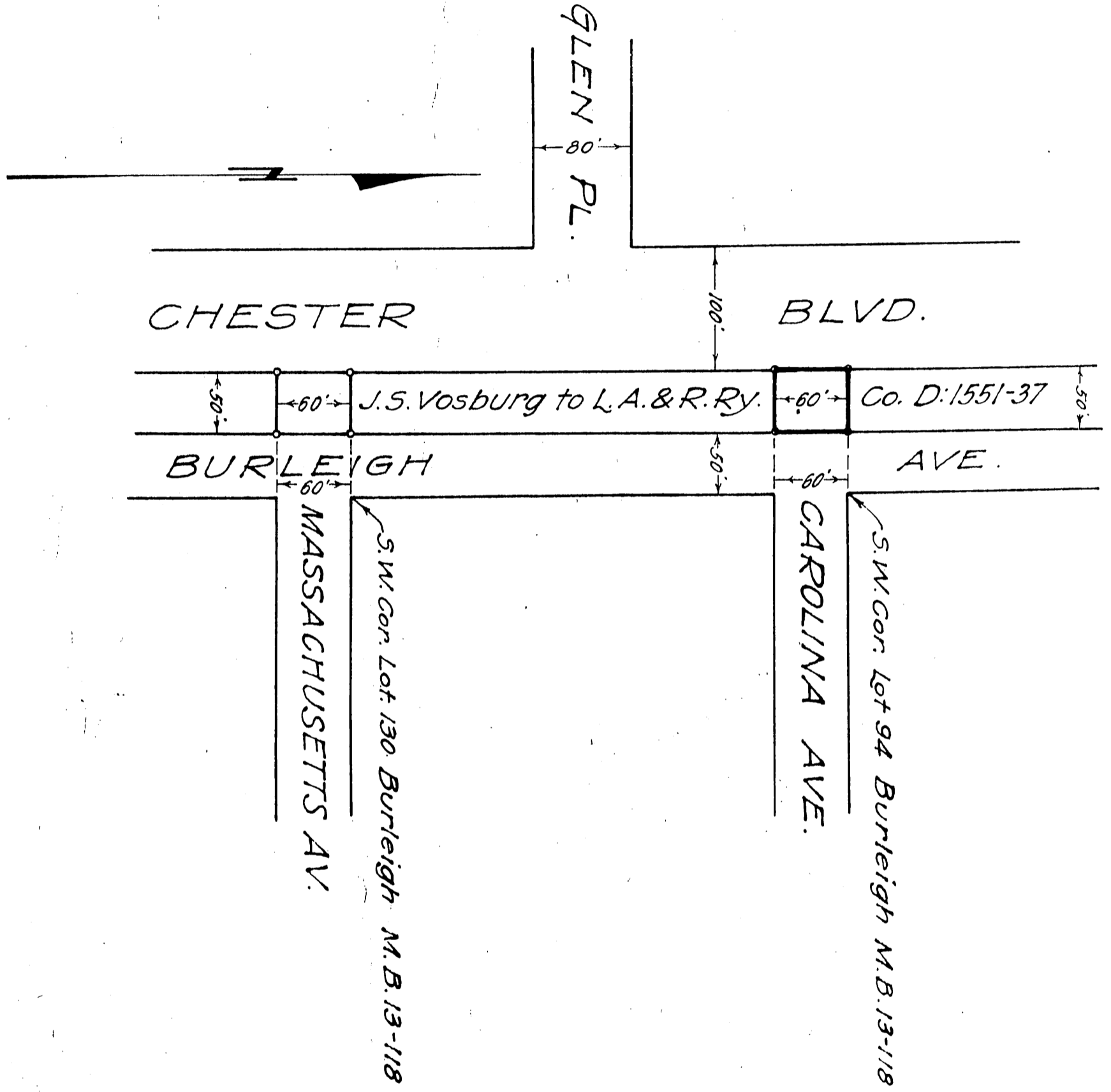

Scale 1" = 100' H. Nov. 29-1915.

Carolina Ave. changed to 132 <sup>nd</sup> St.	} E: 23-95
Massachusetts Ave. " " 133 <sup>rd</sup> St	
Hawthorne Ave. (Burleigh Ave) " " Hawthorne Blvd.	

Easement to L.A. Co. at Carolina Ave.
Crossing to be vacated at Mass. Ave.
Hawthorne Branch.
M. W. K. 235.

A 167

Recorded - July 10-1916.

J/11/25