

Southern Pacific Railroad Co. }  
Southern Pacific Co. } - to - County of Los Angeles

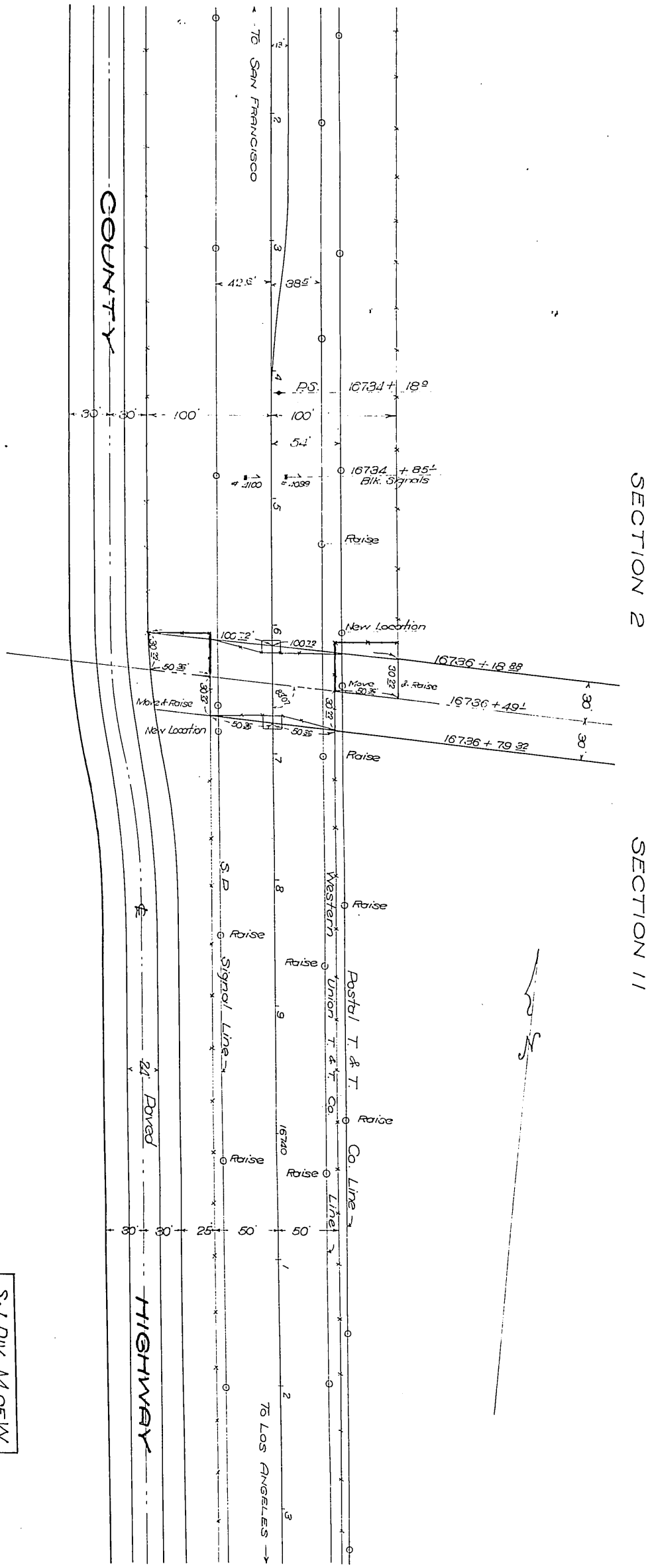

**DENIS**  
 Secs. 2 & 11 T. 6 N. R. 12 W. S. B. M.  
 LOS ANGELES CO. CAL.  
 Prop. County Road X-117  
 Scale 1" = 100'  
 gn. Jan. 28-1916

SU. DIV. M. OF W.
A-259
SHEET NO.
DRAWN BY
SEC.
Revised

Crossing named Avenue N - D: 49-164

Recorded Apr. 27, 1917.