

OFFICE OF THE COUNTY SURVEYOR OF THE COUNTY OF LOS ANGELES HIGHWAY DEDICATION MAP

LEGEND

COUNTY SURVEYOR'S MAP NO. NONE FIELD BOOK NO. MAP NO. FIELD BOOK NO. INDEX MAP NO. 32, (D4) SEARCH MAP NO. Georgia Ave. 1, 2 Monroe St. 1, 2

WORDS AND FIGURES SHOWN QUOTED ON MAP ARE AS DESCRIBED IN THE CONVEYANCE. FIGURES SHOWN IN PARENTHESES ON MAP ARE TAKEN FROM PREVIOUS RECORDS OR ARE CALCULATED THEREFROM. LAND INCLUDED IN CONVEYANCE SHOWN IN COLORED TINT. DEDICATION STATUS SCALE INDICATES RELATIVE IMPORTANCE OF GRANTEE'S INTERESTS IN EACH PARCEL.

POSTING CHECKED table with columns for H. D. MAP BOOK, SEARCH MAP, TRACTS, C.S.M., ASSESSOR'S BOOK, C. S. INDEX MAP.

Main table with columns: LINE NO., PARCEL NO., OFFICIAL RECORDS, DATE RECORDED, 'D' BOOK PAGE, DATE OF CONVEYANCE, NATURE OF CONVEYANCE, PURPOSE, NAME, CONSIDERATION, CONDITIONS, GRANTEE, GRANTORS, DEDICATION STATUS SCALE, and various tracking columns.

OFFICE OF THE
COUNTY SURVEYOR
 OF THE COUNTY OF LOS ANGELES
HIGHWAY DEDICATION MAP

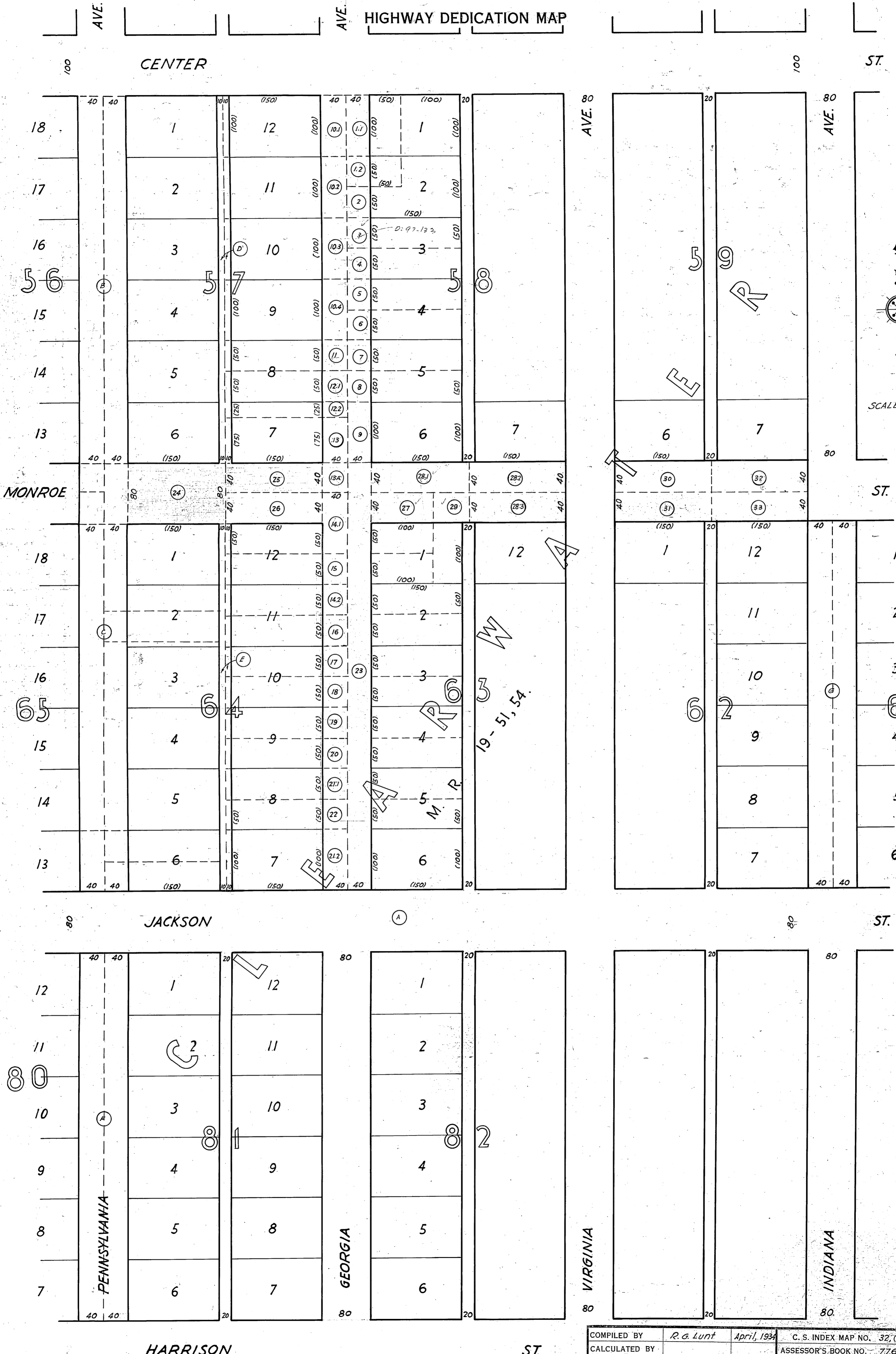

COMPILED BY	<i>R. G. Lunt</i>	<i>April, 1934</i>	C. S. INDEX MAP NO. 32, (D4)
CALCULATED BY			ASSESSOR'S BOOK NO. 776.
DRAWN BY	" "	" "	H:54
TRACED BY	" "	" "	
CHECKED BY	<i>C. H. Hughes</i>	" "	