

Note by County Recorder

The original is on a scale of 20 chains to the inch and was reduced as below to accommodate the size of this book.

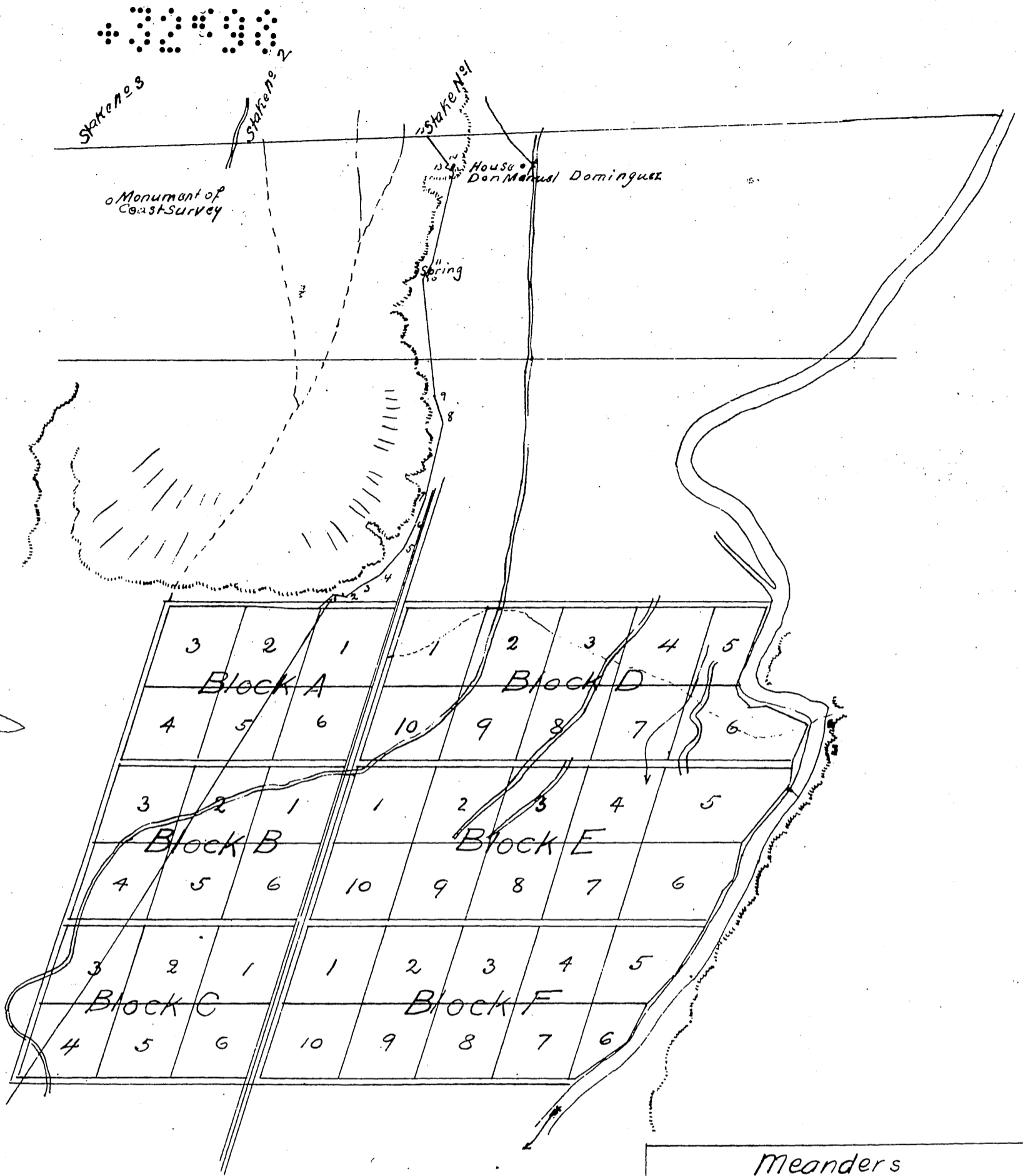

| Meanders to connect with Township corner | | | | | | |
|---|-------------|--------|-------|--------|--------|-------|
| Sta | Course | Dist | N | S | E | W |
| Sec 34 ^{2x} | N 61 1/2° E | 99.88 | 47.66 | | 37.77 | |
| Sanz de la Buzita Post 1 | N 88° E | 247.89 | 8.65 | | 247.74 | |
| | S 31° E | 9.62 | | 8.24 | 4.96 | |
| SW. corner | S 20 3/4° W | 0.14 | | 0.13 | | 0.05 |
| | S 68 1/4° E | 2.09 | | 0.77 | 1.94 | |
| SE corner of corridor | S 14 1/2° W | 24.00 | | 23.24 | | 6.01 |
| 11 | S 26 1/2° W | 5.00 | | 4.48 | | 2.21 |
| 10 | S 5° E | 30.44 | | 29.89 | 2.61 | |
| 9 | S 12° E | 7.00 | | 6.85 | 1.46 | |
| 8 | S 9 1/2° W | 20.00 | | 19.73 | | 3.30 |
| 7 | S 17° W | 7.00 | | 6.69 | | 3.05 |
| 6 | S 30 3/4° W | 6.00 | | 5.16 | | 3.07 |
| 5 | S 47° W | 10.00 | | 6.82 | | 7.31 |
| 4 | S 60° W | 4.50 | | 2.25 | | 3.89 |
| 3 | S 51 1/4° W | 6.50 | | 4.07 | | 5.07 |
| 2 | N 76° W | 2.50 | 0.60 | | | 2.42 |
| 1 | S 52 3/4° W | 4.50 | | 2.72 | | 3.58 |
| | | | 56.91 | 121.04 | 346.48 | 38.96 |
| | | | | 56.91 | 38.96 | |
| | | | | 64.13 | 307.52 | |

A full, true and correct copy of the original recorded May 2nd 1870 at 4 o'clock P.M. at request of Manuel Dominguez

Thomas D. Mott Recorder
By S.H. Mott Deputy