

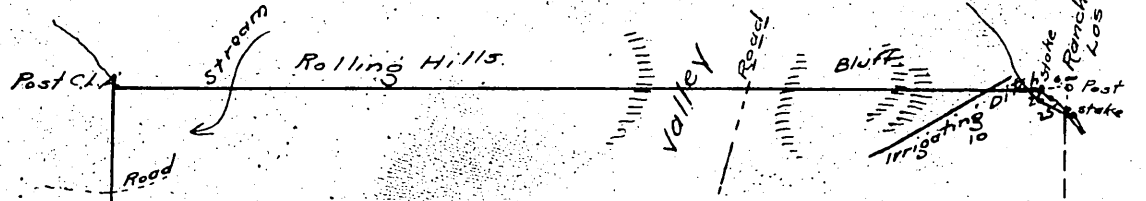

# Rancho Los Feliz



### Boundaries

| No. | Course     | Dist.  | No. | Course     | Dist.  |
|-----|------------|--------|-----|------------|--------|
| 1   | East       | 210.68 | 15  | N 4 1/2 E  | 28.00  |
| 2   | North      | 421.36 | 16  | N 1 1/2 W  | 17.00  |
| 3   | West       | 63.00  | 17  | N 30 W     | 12.00  |
| 4   | S 7 1/2 W  | 33.00  | 18  | N 60 1/2 W | 14.00  |
| 5   | S 45 1/2 W | 22.00  | 19  | N 67 W     | 7.00   |
| 6   | N 84 1/2 W | 9.00   | 20  | N 85 W     | 3.00   |
| 7   | S 59 1/2 W | 9.00   | 21  | S 75 W     | 6.00   |
| 8   | S 88 W     | 7.00   | 22  | S 80 W     | 5.00   |
| 9   | S 76 1/2 W | 15.00  | 23  | N 60 W     | 7.00   |
| 10  | S 48 W     | 23.00  | 24  | N 51 1/2 W | 4.50   |
| 11  | S 26 1/2 W | 12.00  | 25  | N 68 W     | 5.00   |
| 12  | S 35 W     | 12.00  | 26  | N 47 1/2 W | 1.11   |
| 13  | N 35 W     | 15.00  | 27  | West       | 204.68 |
| 14  | N 43 W     | 7.00   | 28  | South      | 421.36 |
|     |            |        | 29  | East       | 210.68 |

859.04 210.68 738.65  
 aggregate of exterior boundary 210.68  
 Miles. chs. 1/4. 1305.57  
 22 - 45 - 37

## Plat OF THE City Lands of Los Angeles.

finally confirmed to  
 The Mayor and Common Council of the City of  
 Los Angeles.  
 Surveyed under instructions from the  
 U.S. Surveyor General  
 By  
 Henry Hancock Dep. Sur.  
 September 1858  
 Containing 17,172 3/4 Acres  
 Scale 40 chs. to 1 inch.  
 Variation 13° 35' East.

Note: A notice of the approval of this plat of Survey has been published in accordance with the Act of Congress of June 14, 1860 in the "Los Angeles Star" the first publication thereof being on the 29<sup>th</sup> of September 1860 and the last on the 20<sup>th</sup> of October, also in the paper nearest the land being the "San Bernardino Herald" the first publication being on the 27<sup>th</sup> September 1860 and the last on the 10<sup>th</sup> of October, 1861. This plat has remained in this Office subject to inspection from the date of the approval thereof.

J. W. Mandeville  
 U.S. Surveyor Gen'l.  
 Cal.

T. 1 S.  
 Lot No.

Public Land

Post C.L.A.

The field notes of the "City lands of Los Angeles" and from which this plat has been made out have been examined and approved and are on file in this Office  
 U.S. Surveyor Gen'l. Office  
 San Francisco California.  
 July 2<sup>nd</sup> 1859.

J. W. Mandeville  
 U.S. Surveyor Gen'l. Cal.

Sec. 36 Sec. 31  
 Sec. 1. Sec. 6

Post C.L.A.

Public Land

T. 2 S.  
 Lot

U.S. Surveyor Gen'l's Office  
 San Francisco California.

I hereby certify this to be a full true and correct copy of the original Map on file in this Office of the Official Survey of the City Lands of Los Angeles finally confirmed to the Mayor and Common Council of the City of Los Angeles.

In Witness Whereof I have hereunto signed my name and caused the seal of this Office to be affixed this 8<sup>th</sup> day of June 1867

L. Upson  
 U.S. Surveyor Gen'l. Cal.

Stake of Rancho Cañada de Los Nogales

North 210.68 chs.

Beginning

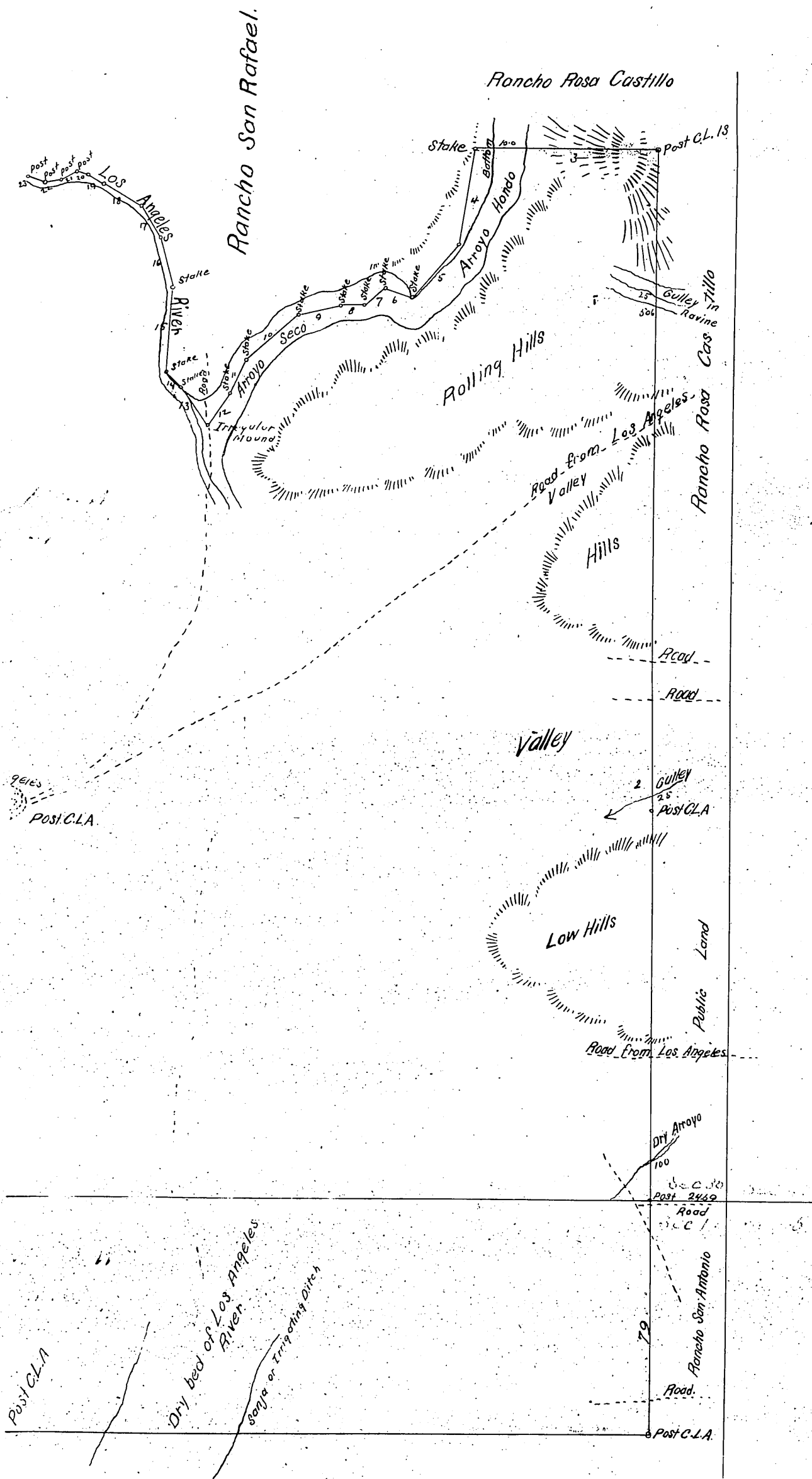

Rancho San Antonio

Grant deed to County D: 81-187, O.R. 10143-161

- Por. to City of L.A. - D: 84-217, O.R. 11075-21.
- Por. " " " for opening new st. - C.F. 1772
- Por. " " " for street purposes - D: 86-94, O.R. 11406-302.
- Por. to City of Los Angeles E: 12-227, O.R. 14521-387
- Por. " " " E: 15-122, O.R. 14863-141.
- Por. condemned for Storm Drain - C.F. 2005.

Recorded Feb 21 1874 at 12 M.  
at request of A.W. Hutton.

Sht. # 8  
Sht. 2  
Sht. 3  
Sht. 4

2