

For copy of this map
See M.R. 32-58

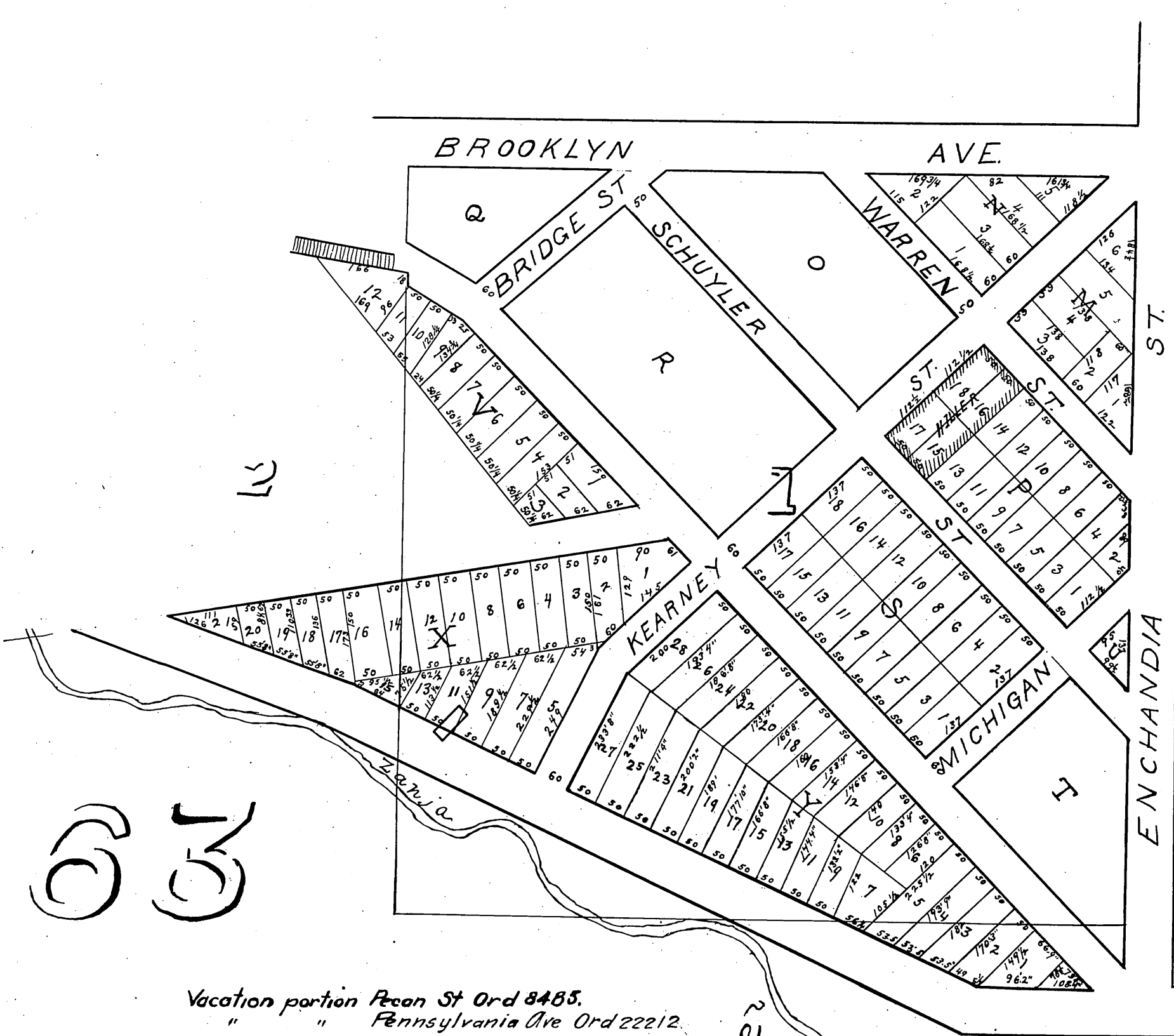

MOUNT PLEASANT TRACT
being a
SUBDIVISION
of parts of
Lots 1, 2, and 6 of Block 63
Hancocks Survey
Aug 1875
Scale 200 ft one inch Moore & Kelleher.



Vacation portion Pecon St Ord 8485.
" " Pennsylvania Ave Ord 22212.

A full, true, and correct copy of the original map recorded Aug. 25, 1875 at 35 mins past 11

For J. Lazzarevich. - J. A. Gillette. County Recorder.

Deed for St par BIK Q D:11-167 D:3530-169
" " " " " D:11-168 D:3470-281