

SCHILLER TRACT

Property of the Real Estate Association
of Los Angeles, as subdivided by J.M.
Baldwin and G. Bridger April 1875
Scale 40 ft per inch

Hill St widening See CF 514 D: 16-9
Main St " " CF 521.

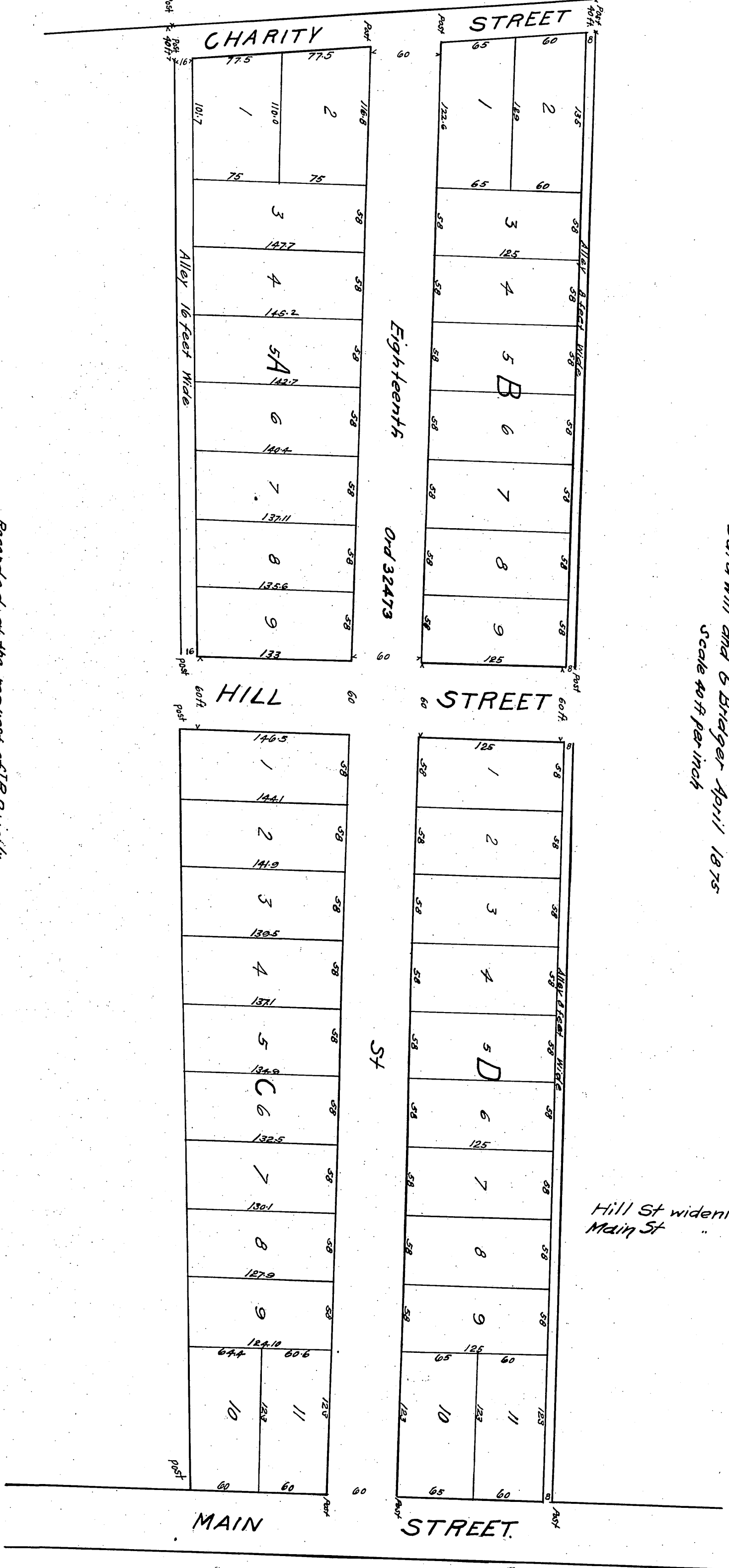

Recorded at the request of J.R. Bravley
Dec 6 1875 at 11:42 AM.

Compd. J.R. Bravley