

COURSES AND WIDTHS OF STREETS			
Name of Street	True Courses	Magnetic	Width
Aliso	S. 80 3/4 E.	N. 84 3/4 E.	96 ft.
Sainsevain	"	"	50 "
Lazard	"	"	50 "
Weill	"	"	50 "
Turner	"	"	50 "
Banning	"	"	50 "
First	"	"	60 "
Keller	N. 42 E.	N. 27 1/2 E.	80 "
Front	N. 9 1/4 E.	N. 5 1/4 W.	50 "
Center	"	"	50 "
Vignes	"	"	50 "

Scale: 120 Feet to 1 Inch.
 This Scale has been here reduced to 360 feet to 1 inch to accommodate the Size of this Book.

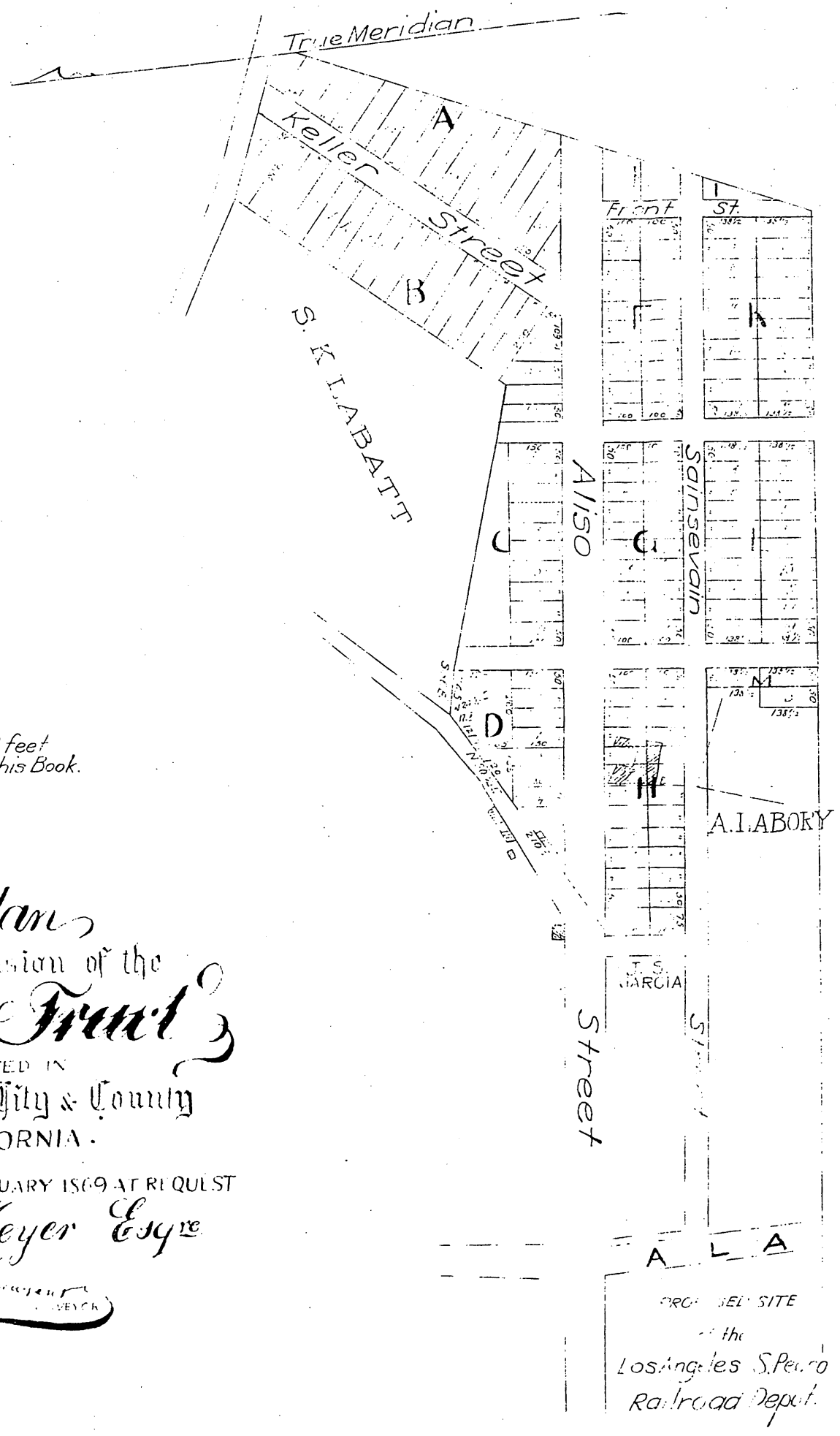

Plan
 of the Subdivision of the
Aliso Tract
 SITUATED IN
 Los Angeles City & County
 CALIFORNIA.
 SURVEYED IN JANUARY 1869 AT REQUEST
 OF
Eugene Meyer Esq.
 BY
Frank LeComber
 SURVEYOR

Lot 15 & por. lots 17, 19, Blk 'L' Deeded To L.A. City D: 17-1-0 QA-45-41-70

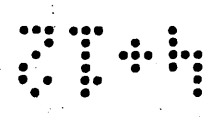

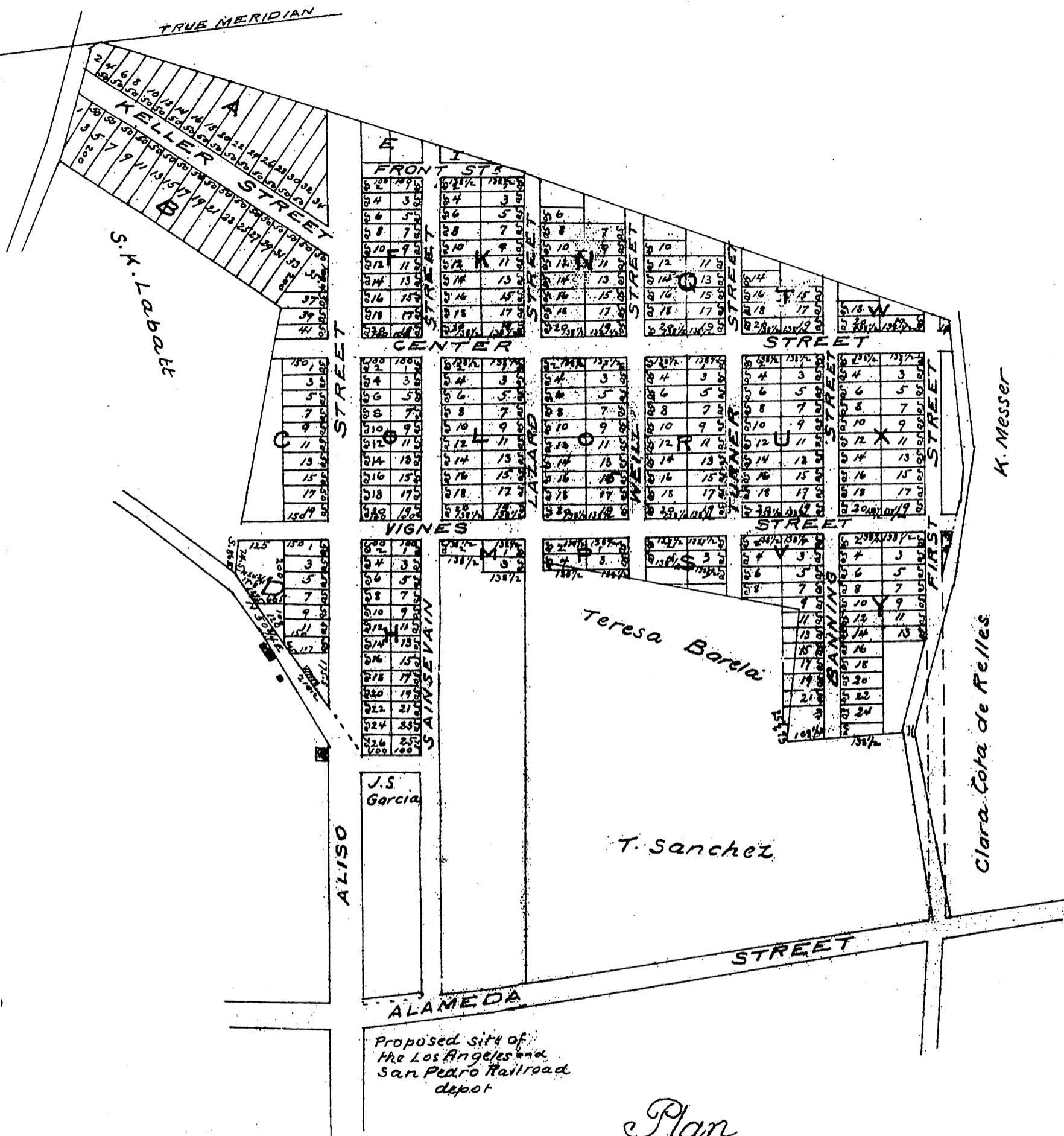

Courses & Widths of Streets			
NAME OF STREETS	True Course	Magnetic	Width
Aliso	S 80 1/4 E	N 84 1/4 E	96 Feet
Sainsevain	"	"	50 "
Lazard	"	"	50 "
Weill	"	"	50 "
Turner	"	"	50 "
Banning	"	"	50 "
First	"	"	60 "
Keller	N 42 E	N 27 1/2 E	80 "
Front	N 9 1/4 E	N 5 1/4 W	50 "
Center	"	"	50 "
Vignes	"	"	50 "

Plan
of the Subdivision of the
Aliso Tract
situated in
Los Angeles City & County
California

surveyed in January 1869 at request
of Eugene Meyer Esqre
by
Frank J. Courcier
Surveyor.

Scale 120 Feet to 1 inch
This Scale has been here reduced to 360 Feet
to 1 inch to accommodate the Size of this Book

a full true and correct copy of the Original, recorded at request of
Eugene Meyer Dec 11. 1878 at 15 min past 11 a.m.
Chas. E. Miles Co Recorder
By Geo. E. Gard Deputy