

MR 5-32
10

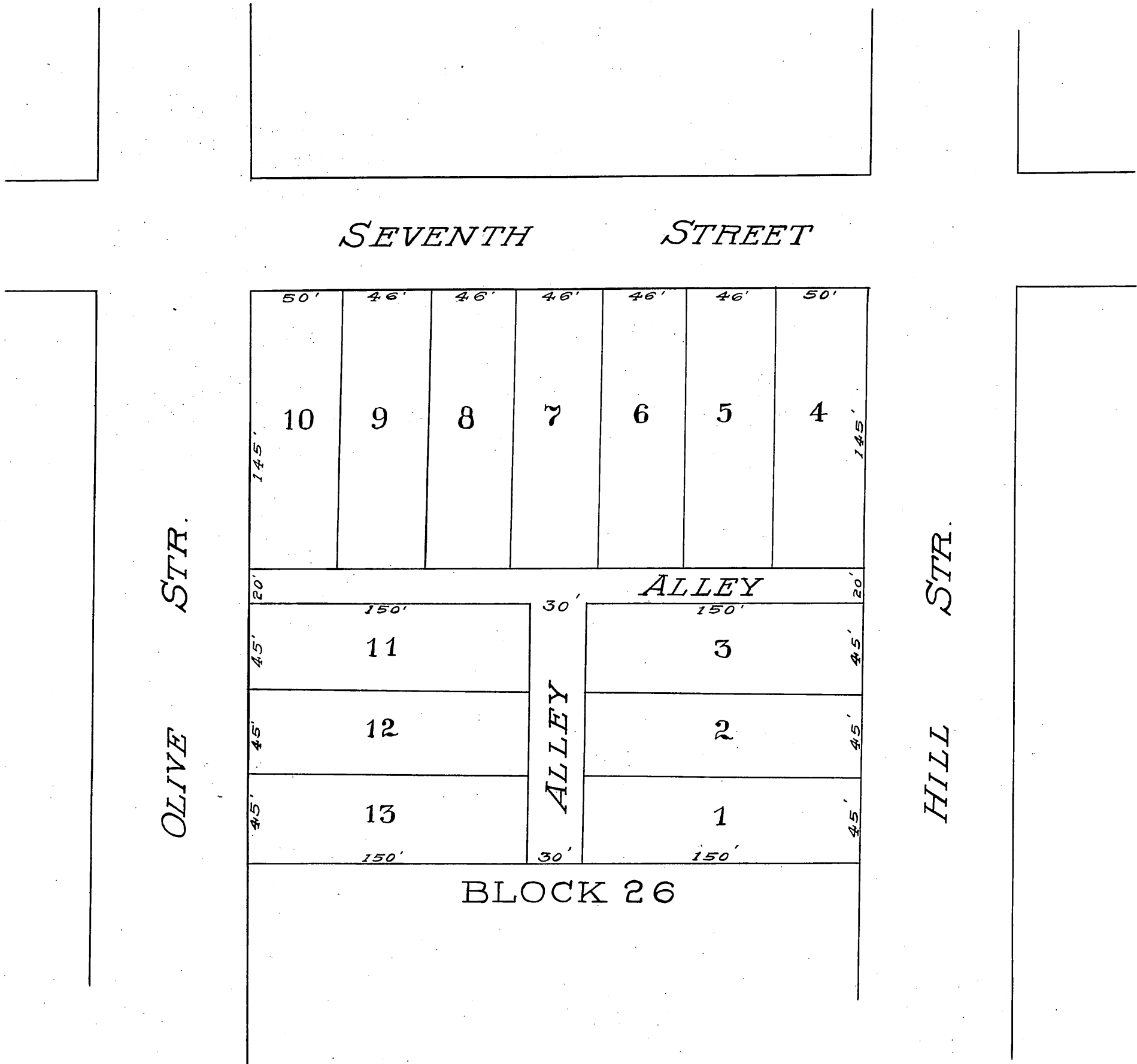
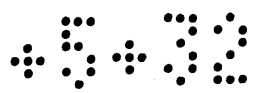

MAP
 OF THE MUELLER SUBDIVISION
 OF THE NORTH 1/2 OF BLOCK 26 ORD. SURVEY
 IN THE CITY OF LOS ANGELES, CAL.
 SURVEYED AT THE REQUEST OF O. MUELLER
 NOVEMBER 27 1882 BY HANSEN & SALANO
 Scale of 1 inch to 60 feet

Widening of Hill St. See D: 3108-94 D: 11-13.

RECORDED AT REQUEST OF OTTO MUELLER NOV. 27 1882