

MR-6-61

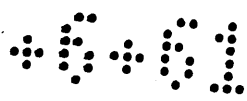

Plat of BLOCK H FORT HILL TRACT

City of Los Angeles

Surveyed and subdivided under instructions
from the

Hon. Council of the City of Los Angeles

In Sept 1884

by Geo. C. Knox City Sur.

Scale 100 ft to one inch.

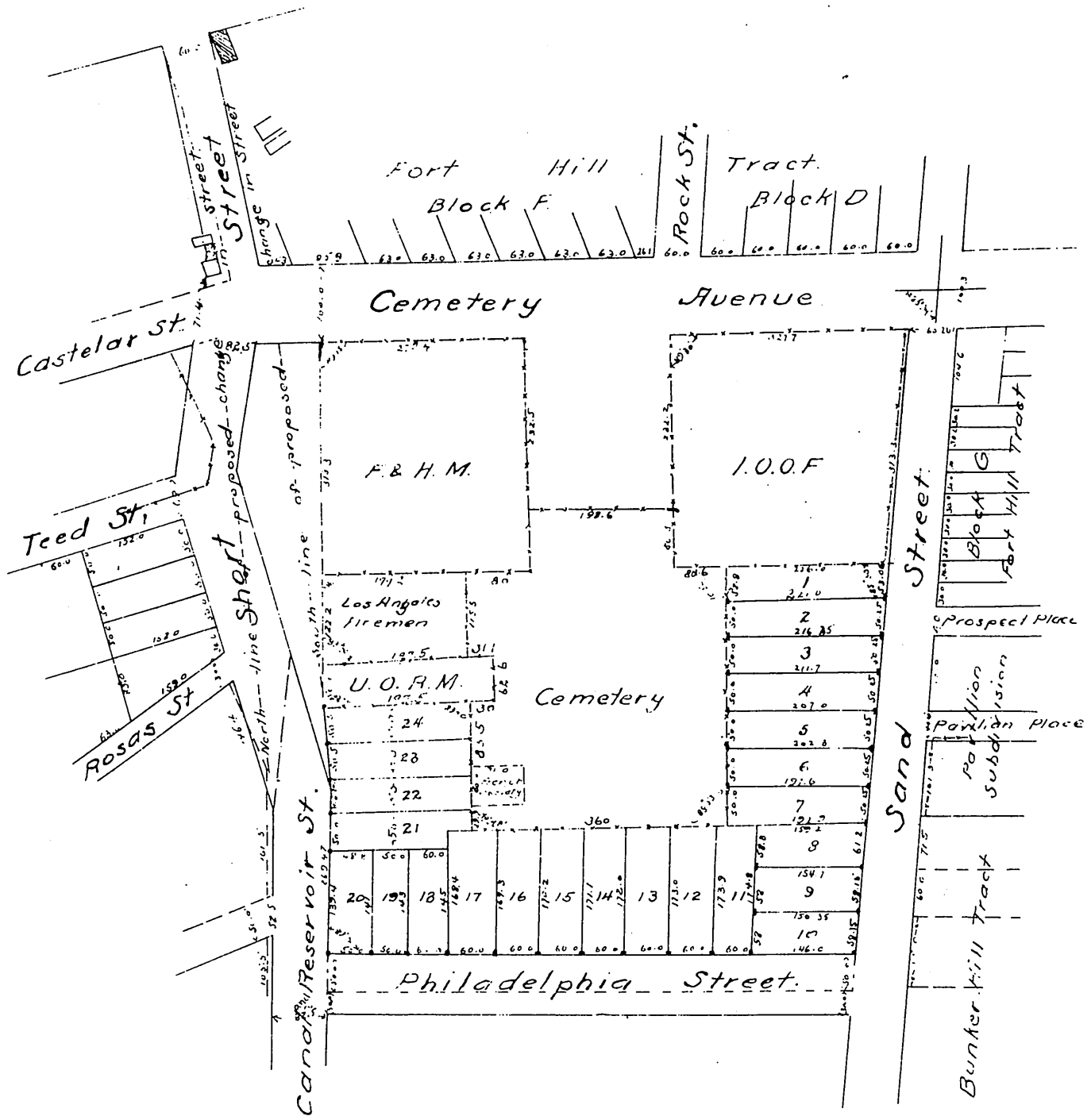

Explanation of Signs

- Fences
- Foots
- Boundary of City Lands
- Dividing line between streets
- Dividing line between Short and Canal and Reservoir Street
- Adobe buildings
- Wooden do

A full true and correct copy of the original reduced to the scale of 200 feet per inch recorded 12th 20, 1884, at 46 min past 12 M, at request of W W Robinson Clerk City Council.

Chas E. Miller, Co Recorder