

MR-6-78

# MAP

→ OFC →

## H. HILLER'S SUBDIVISION

→ OFC →

### BLK. 95 TOWN OF SAN PEDRO

*Reference being had to the original map made by C.T. Healey in 1882 in the partition of the Rancho Pecos Verdes.*

*Scale 50 feet to one inch.*

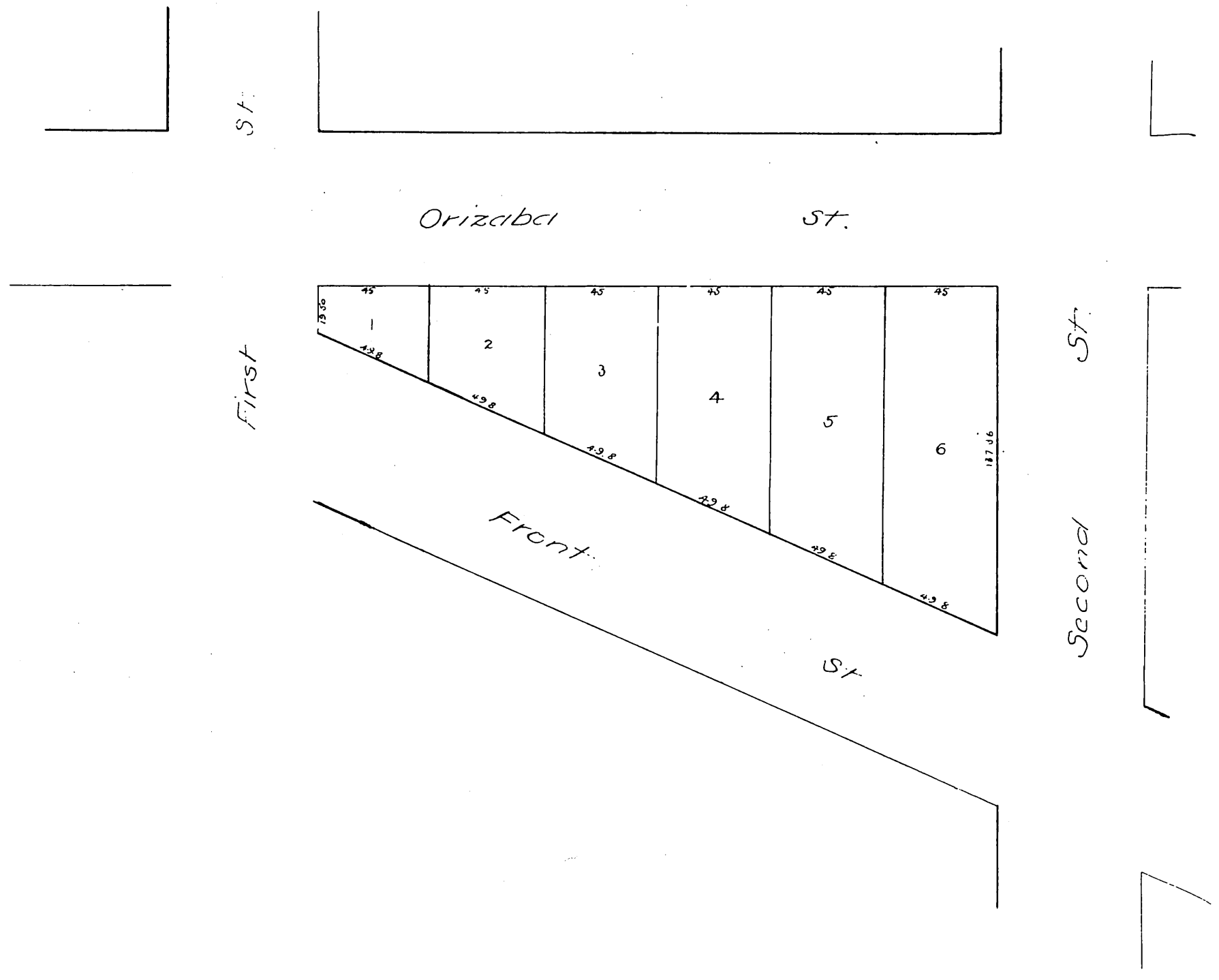

*A full true and correct copy of the original recorded, Nov 13 1884 at 30 min past 3 P M at request of H. Hiller*

*Chas E. Riley Co Recorder*