

MR-6-12J

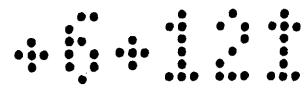

PLAN

of the

CENTRAL TRACT

being a subdivision of

Lots 1, 3 and 4 of Block N, of the San Pascual Tract, Pasadena, Cal.

owned by

C. J. Fox and A. F. Thompson

Surveyed by Williard Thompson

Nov. 1884

Scale 100 ft to 1 in.

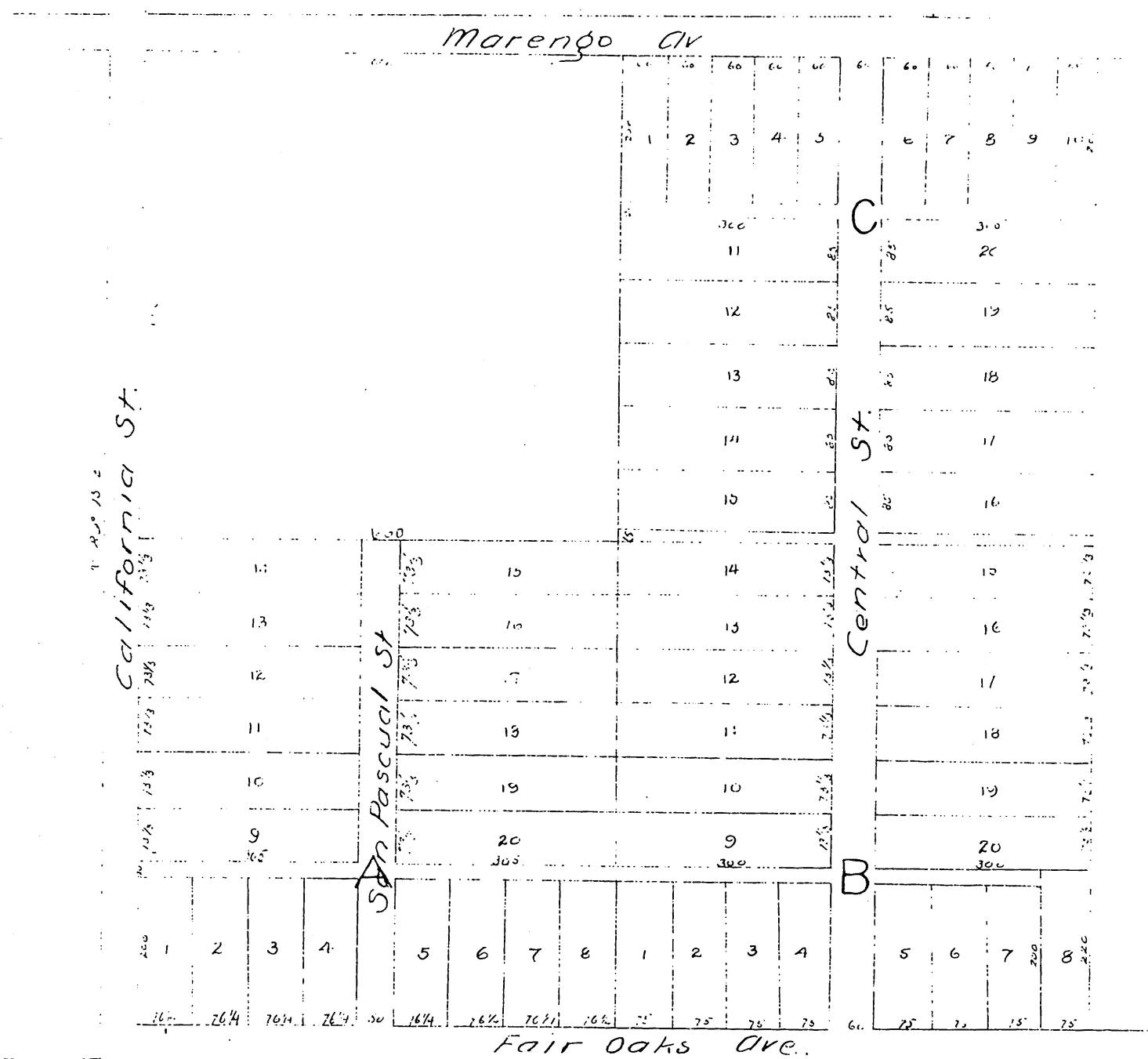

A full true and correct copy of the original reduced to scale of 200 ft to one inch recorded Dec 3 1884 at 30 minutes 3 P.M. at request of J. C. Fox et al.

Wm. C. Gillies Co. Recorder