

MR-6-194

# MAP

Showing the subdivision of the  
**TOWN** OF  
**DUARTE**

BEING THE WEST HALF OF  
LOT 10 SEC 30  
Rancho Azusa de Duarte

LOS ANGELES COUNTY CALIFORNIA

Surveyed at the request of  
L. L. BRADBURY AND H. S. DANIELS.

JANUARY  
1884

SCALE 60 FT. TO 1 IN.

L. L. BRADBURY

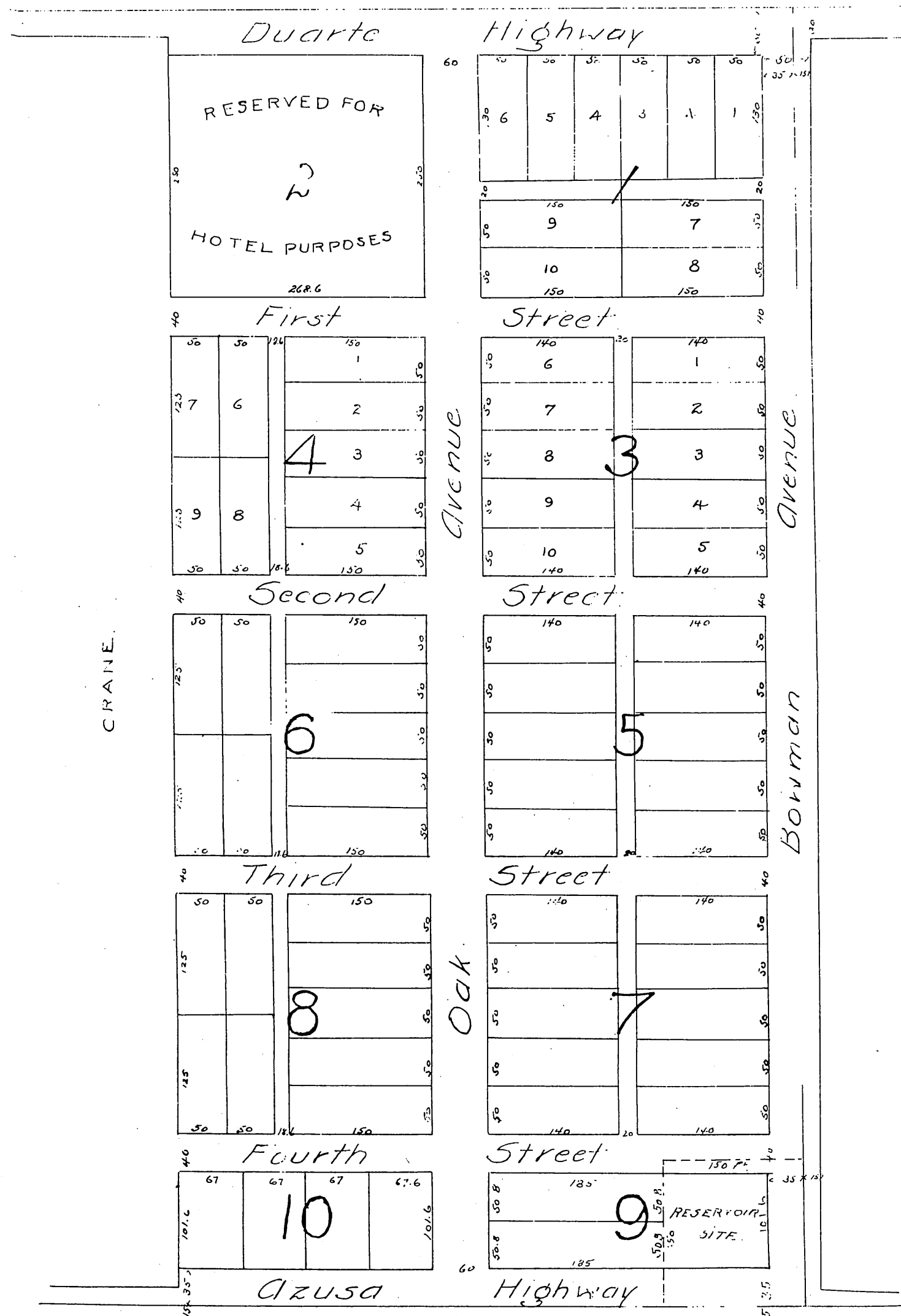

### CHIPPENDALE

A full, true and correct copy of the original reduced to the scale of 100 ft. to 1 inch recorded January 20<sup>th</sup> 1885 at 30 min. past 10 A.M. at request of H. S. Daniels

Chas. E. Miles Co. Recorder