

MR-6-333

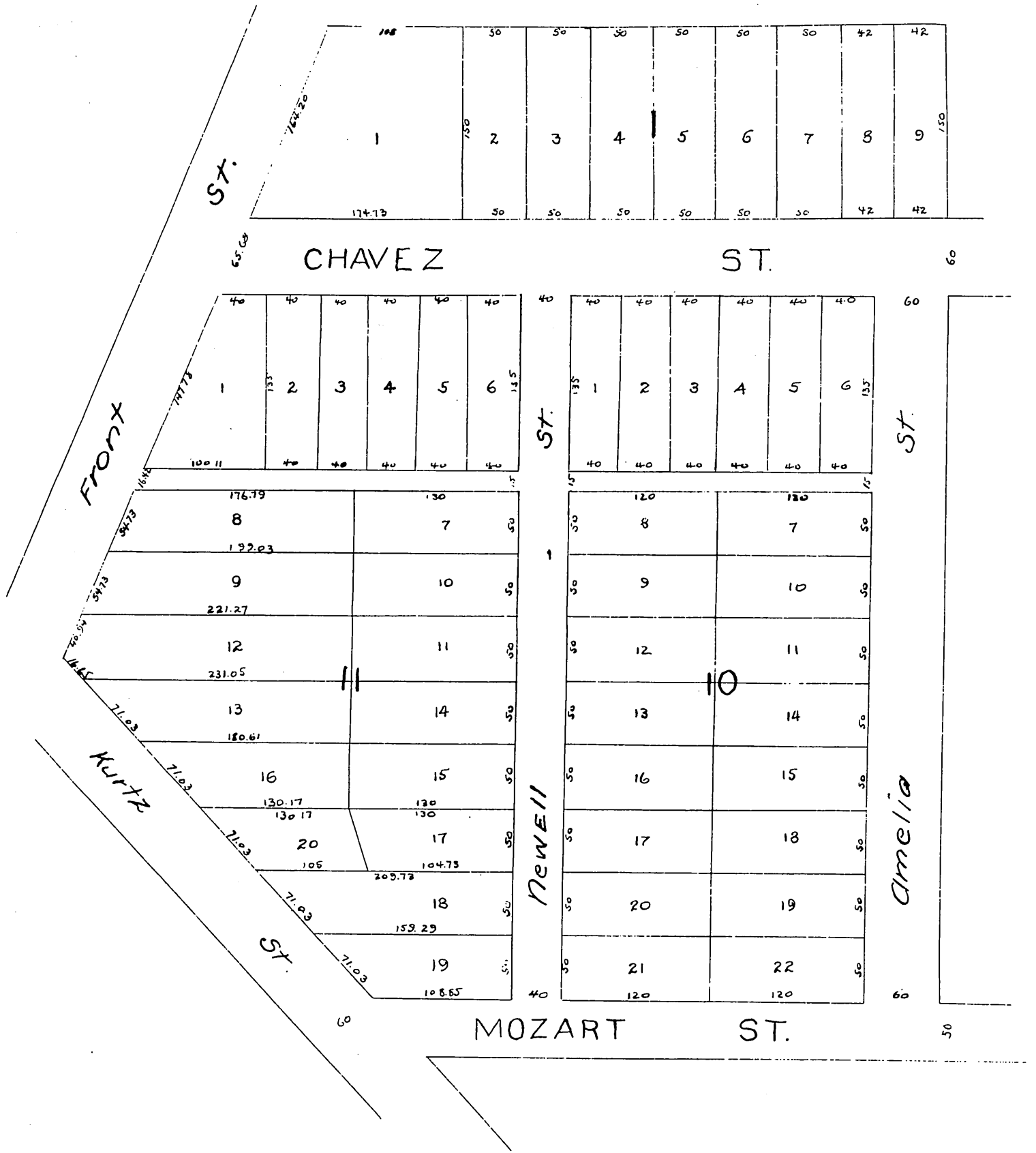

MAP
 OF
 NEWELL AND SPENCERS
 SUBDIVISION
 of a part of the
 CHAVEZ TRACT
 East Los Angeles Cal.

Scale 100 ft to 1 inch.



A FULL, TRUE AND CORRECT COPY OF THE ORIGINAL
 RECORDED MAY 25TH 1885 AT 40 MIN PAST 9 A.M.
 AT REQUEST OF H.F. SPENCER

Chas E Miles

COUNTY RECORDER